

9.2 TOP and CHASSIS SECTION

A
B
C
D
E
F

***Note:**
These parts (41) are used DAA1210 for the products of the first production lot.

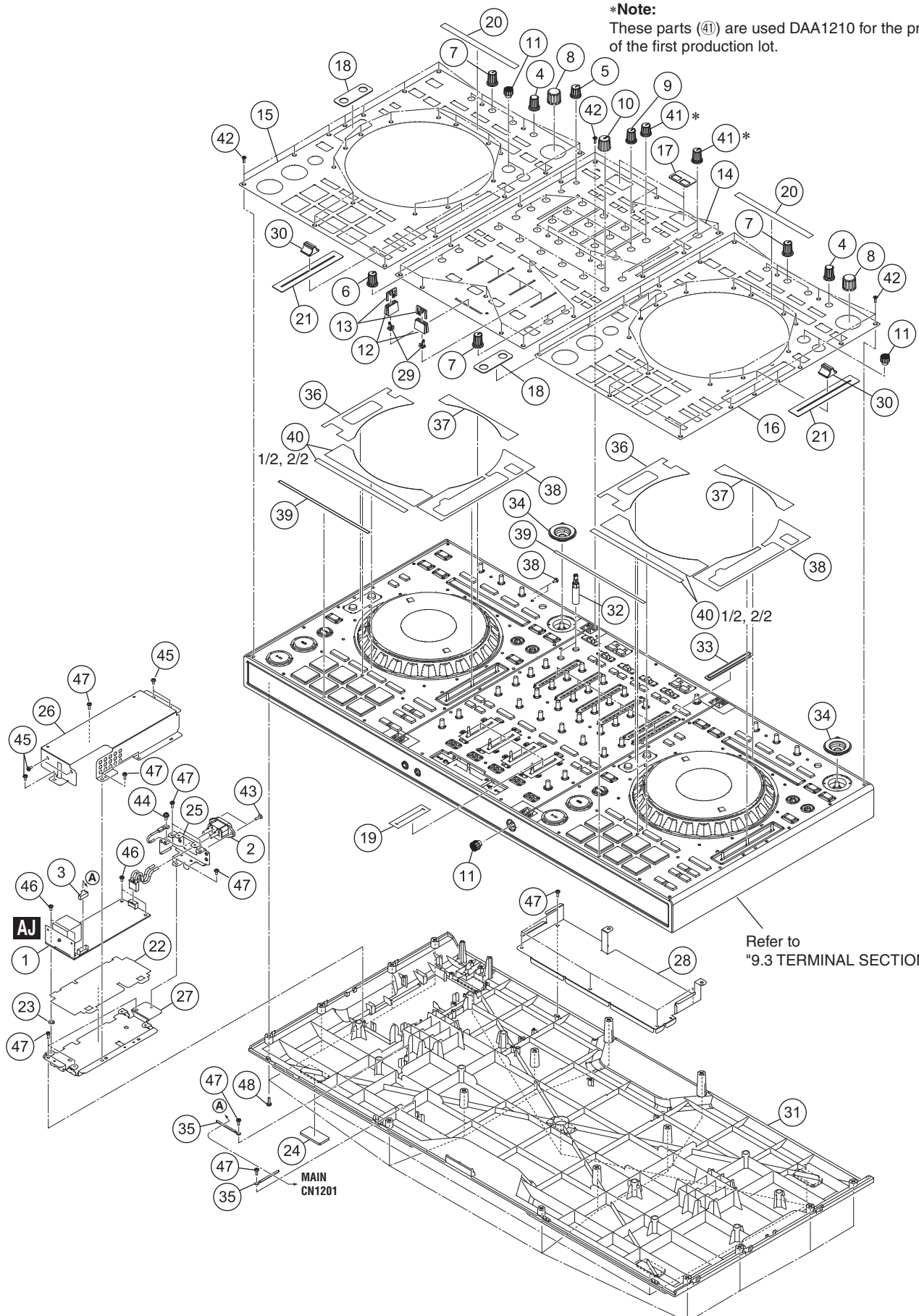

Refer to "9.3 TERMINAL SECTION".

TOP and CHASSIS SECTION PARTS LIST

<u>Mark No.</u>	<u>Description</u>	<u>Part No.</u>	
⚠	1 POWER SUPPLY Assy	DWR1463	
⚠	2 AC Inlet/3P	DKP3954	A
	3 Crimp Connector/6P	DKP3956	
	4 Rotary Sw Knob (C)	DAA1180	
	5 Knob (MA)	DAA1210	
	6 Knob (Black)	DAA1212	
	7 Rotary Knob (BN)	DAA1220	
	8 Dial Knob	DAA1259	
	9 Knob/RSW	DAA1305	
	10 Knob/FRE	DAA1309	
	11 Knob/CFC	DAA1326	B
	12 Slider Knob 1	DAC2684	
	13 Slider Knob 2	DAC2685	
	14 Plate/MIX	DAH2976	
	15 Plate/DEL	DAH2982	
	16 Plate/DER	DAH2983	
	17 Panel/USB	DAH2984	
	18 Panel/DEC	DAH2986	
	19 Fader Packing	DEC3355	
	20 Sheet/CDC	DEC3532	C
	21 Sheet/TMP	DEC3541	
	22 Barrier/SWP	DEC3553	
	23 Washer/PWR	DEC3554	
	24 Sheet/LEG	DEC3557	
	25 Bracket/ACI	DNF1932	
	26 Shield Case/U	DNH3142	
	27 Shield Case/L	DNH3143	
	28 Shield Plate	DNH3155	
	29 Slider Knob Stopper	DNK5888	D
	30 Knob/SLD	DNK5981	
	31 Chassis	DNK6286	
	32 Shaft/EXT	DNK6305	
	33 Lens/LVL	DNK6306	
	34 Ring/BRS	DNK6312	
	35 Cord Clamper (Steel)	RNH-184	
	36 DS Tape/ALL	DEH1048	
	37 DS Tape/ALT	DEH1049	
	38 DS Tape/ALR	DEH1050	E
	39 DS Tape/ALB	DEH1051	
	40 DS Tape/PAJ	DEH1056	
	41 Knob/SHR	DAA1333	
	42 Screw	CPZ26P080FTB	
	43 Screw	IBZ30P080FTB	
	44 Screw	PMH40P080FTC	
	45 Screw	BBZ30P060FTB	
	46 Screw	BBZ30P080FTB	F
	47 Screw	BPZ30P080FNI	
	48 Screw	BPZ30P100FTB	

1 2 3 4

9.2 TOP and CHASSIS SECTION

A DDJ-SZ and DDJ-SZ2 are constructed the same except for the following:
 For convenience of the system, the part names for the DDJ-SZ2 are simplified. The part names in parentheses are those for the DDJ-SZ.

Mark	No.	Symbol and Description	DDJ-SZ	DDJ-SZ2	Remarks
⚠	1	POWER SUPPLY Assy	DWR1463	Not used	
⚠	1	SW POWER SUPPLY	Not used	DWR1566	
⚠	2	AC Inlet/3P	DKP3954	DKP3985	
	4	Rotary SW Knob (C)	DAA1180	DAA1344	
	7	Knob (Rotary Knob (BN))	DAA1220	DAA1368	
	8	Knob (Dial Knob)	DAA1259	DAA1371	
	12	Knob/SLD (Slider Knob 1)	DAC2684	DAC2935	
	14	Plate (Plate/MIX)	DAH2976	DAH3138	
B	15	Plate (Plate/DEL)	DAH2982	DAH3139	
	16	Plate (Plate/DER)	DAH2983	DAH3140	
	30	Knob (Knob/SLD)	DNK5981	DNK6682	
	31	Chassis	DNK6286	DNK6475	
	32	Shaft/EXT	DNK6305	DNK6410	
	38	DS Tape/ALR Escutcheon	DEH1050	DEH1079	No. 49
		DS Tape	Not used	DNK6473	
			Not used	DEH1064	No. 50

TOP and CHASSIS SECTION

22

DDJ-SZ2

1 2 3 4