

A CONTROL PANEL SECTION

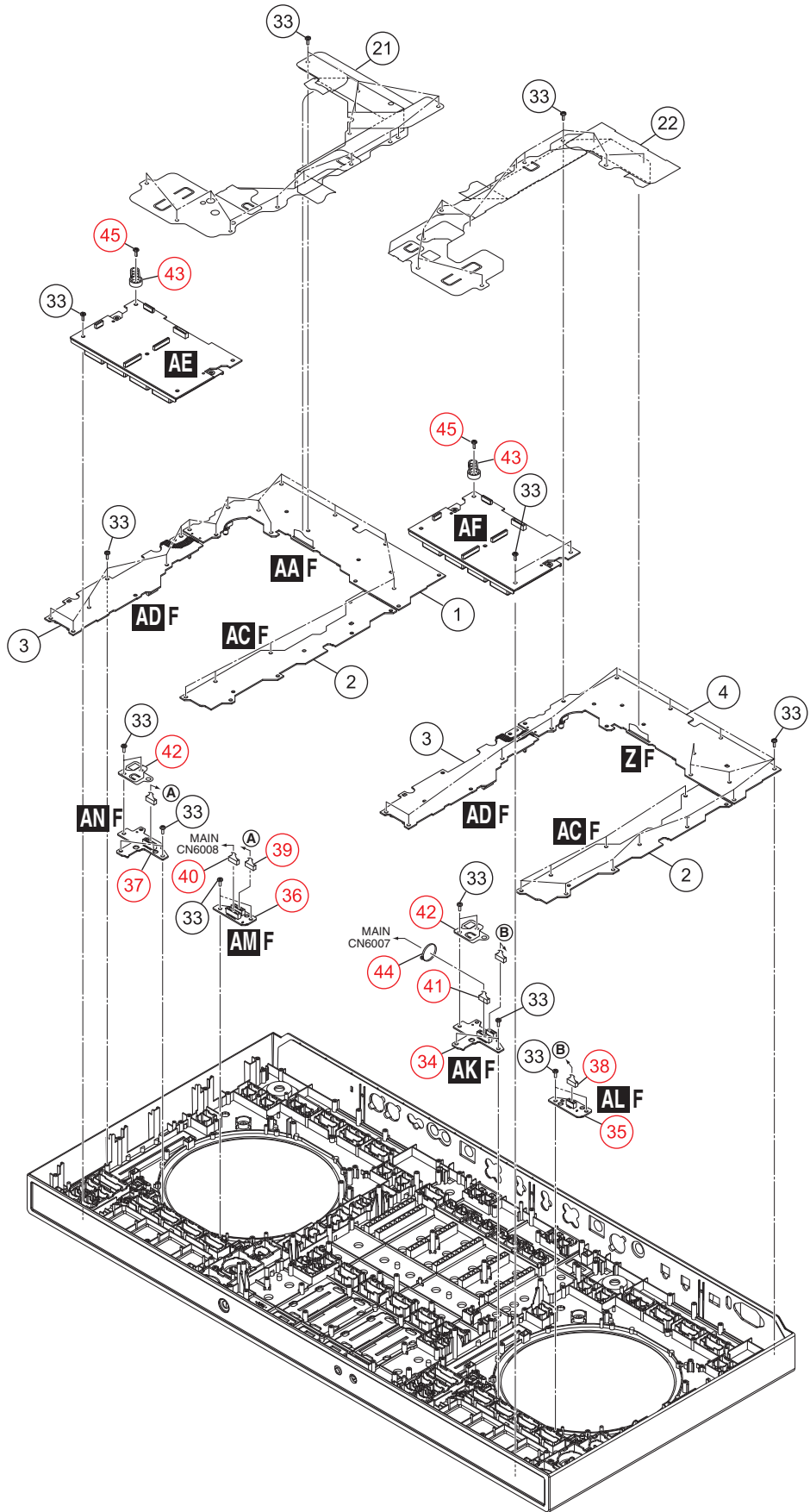

B

C

D

E

F

## 9.3 TERMINAL SECTION

DDJ-SZ and DDJ-SZ2 are constructed the same except for the following:  
For convenience of the system, the part names for the DDJ-SZ2 are simplified. The part names in parentheses are those for the DDJ-SZ.

Mark	No.	Symbol and Description	DDJ-SZ	DDJ-SZ2	Remarks
	1	MAIN Assy	DWX3535	DWX3953	
	2	USBB Assy	DWX3555	DWX3752	
	3	AIJK Assy	DWX3536	DWX3768	
	4	AOJK Assy	DWX3537	DWX3769	
	5	HPJK Assy	DWX3538	DWX3770	
	6	CRFCV Assy	DWX3547	DWX3777	
	7	PSWB Assy	DWX3560	DWX3956	
	8	STRB Assy	DWX3585	DWX3962	

## 9.4 CONTROL PANEL SECTION

DDJ-SZ and DDJ-SZ2 are constructed the same except for the following:  
For convenience of the system, the part names for the DDJ-SZ2 are simplified. The part names in parentheses are those for the DDJ-SZ.

Mark	No.	Symbol and Description	DDJ-SZ	DDJ-SZ2	Remarks
	1	DEUP Assy	DWX3548	DWX3961	
	2	KSWB Assy	DWX3549	DWX3958	
	3	SLDB Assy	DWX3550	DWX3959	
	4	DEUPR Assy	DWX3580	DWX3963	
	27	Sensor	DSX1124	DSX1135	
		SEQL Assy	Not used	DWX3763	No. 34
		QUAL Assy	Not used	DWX3764	No. 35
		QUAR Assy	Not used	DWX3765	No. 36
		SEQR Assy	Not used	DWX3766	No. 37
		Connector Assy	Not used	PF04PP-B17	No. 38
		Connector Assy	Not used	PF07PP-B17	No. 39
		Crimp Connector	Not used	PF08PP-B12	No. 40
		Crimp Connector	Not used	PF08PP-B17	No. 41
		Barrier	Not used	DEC3630	No. 42
		Stopper	Not used	DNK6532	No. 43
		Cable Tie	Not used	ZCA-SKB90BK	No. 44
		Screw	BPZ30P080FNI	BPZ30P100FTB	No. 45

# 9.4 CONTROL PANEL SECTION

A  
B  
C  
D  
E  
F

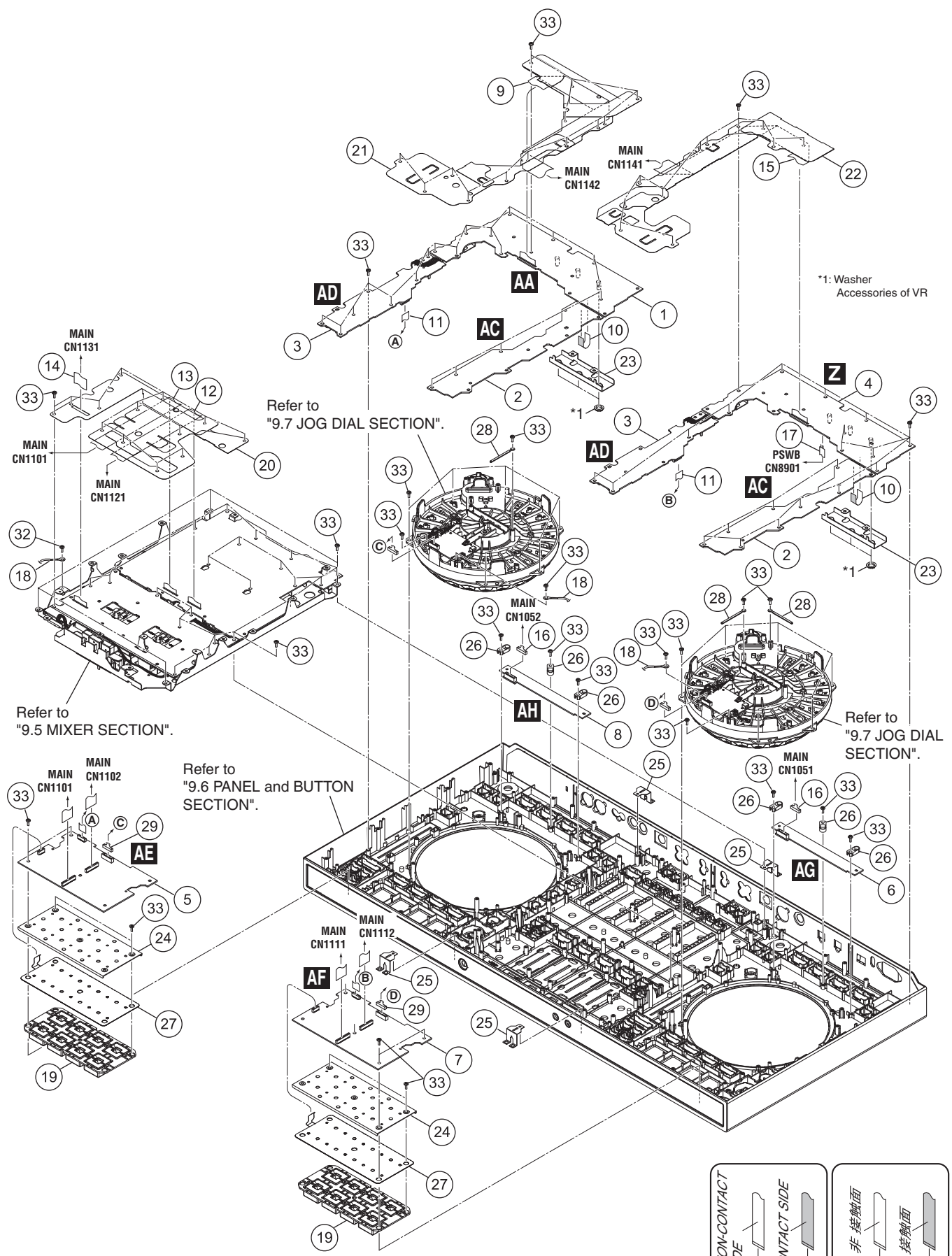

**CONTROL PANEL SECTION PARTS LIST**

<b>Mark No.</b>	<b>Description</b>	<b>Part No.</b>	
1	DEUP Assy	DWX3548	
2	KSWB Assy	DWX3549	A
3	SLDB Assy	DWX3550	
4	DEUPR Assy	DWX3580	
5	PADL Assy	DWX3553	
6	CDCL Assy	DWX3554	
7	PADR Assy	DWX3583	
8	CDCR Assy	DWX3584	
9	FFC/32P	DDD1657	
10	FFC/15P	DDD1660	
11	FFC/13P	DDD1661	B
12	FFC/25P	DDD1662	
13	FFC/23P	DDD1663	
14	FFC/27P	DDD1664	
15	FFC/32P	DDD1672	
16	Crimp Connector	PF08PP-B30	
17	Jumper Wire	D20PYY0310E	
18	Earth Lead Wire	DE012VC0	
19	Button/PAD	DEB2005	
20	Barrier/MIX	DEC3545	C
21	Barrier/DEL	DEC3546	
22	Barrier/DER	DEC3547	
23	Stay/PL	DND1279	
24	Bracket/FSR	DNF1930	
25	Plate/ART	DNH3144	
26	CDC Stopper	DNK5863	
27	Sensor	DSX1124	
28	Cord Clamper (Steel)	RNH-184	
29	Connector Assy	PF08PP-B07	D
30	•••••		
31	•••••		
32	Screw	BBZ30P060FTB	
33	Screw	BPZ30P080FNI	