



ICOA[®] PRO 12 A / 15 A

12" & 15" POWERED COAXIAL HIGH-PERFORMANCE PA LOUDSPEAKER
WITH BLUETOOTH[®] AND APP

LDICOA12APRO(W); LDICOA15APRO(W);

TABLE OF CONTENTS

1	DOCUMENT VERSION AND REVISIONS	8
2	INTRODUCTION	9
2.1	You Made the Right Choice!	9
2.2	Contacts.....	9
2.3	Link to the Download Centre	9
2.4	Visualisation Conventions in This User Manual.....	10
3	PRODUCT COMPLIANCE	11
3.1	Manufacturer's Declaration.....	11
3.2	Declaration of Conformity	11
4	SAFETY INSTRUCTIONS.....	13
4.1	Intended Use	13
4.2	Explanation of Safety and Warning Symbols.....	13
4.3	Structure of Warning Messages.....	14
4.4	General Safety	14
4.5	Electrical Safety.....	15
4.6	Physical Safety.....	16
4.7	Thermal Safety.....	17
4.8	Wireless Safety.....	17
4.9	Device Safety.....	17
5	PRODUCT DESCRIPTION	18
5.1	Product Overview	18
5.2	Product Variants	18
5.3	Optional Accessories.....	18
5.4	Dimensions.....	19
5.5	Technical Data	19
5.6	User Interface	22
5.7	Front LED	23
6	PREPARATION	24
6.1	Scope of Delivery	24

7	INSTALLATION.....	25
7.1	About Horizontal Use of the Device.....	25
7.2	Device Mounting.....	25
7.2.1	Mounting the Device on a Stand or a Speaker Pole.....	25
7.2.2	Attaching the M10 Eyebolt.....	26
7.2.3	Attaching the Universal Mounting Bracket.....	26
7.2.4	Attaching the EasyMount® Bracket.....	28
8	OPERATION.....	29
8.1	Power Supply.....	29
8.1.1	Power Connections.....	29
8.1.2	Connecting a Mains Power Cable.....	29
8.1.3	Turning the Device on or off.....	30
8.1.4	Disconnecting a Mains Power Cable.....	30
8.2	Navigating the Device.....	31
8.2.1	Using the Rotary-Push Encoder.....	31
8.2.2	Accessing the Settings Section.....	32
8.3	Device Display Overviews.....	33
8.3.1	Main Screen Overview.....	33
8.3.2	EQ Section Overview.....	34
8.3.3	EQ Preset Section Overview.....	35
8.3.4	Settings Section Overview.....	36
8.4	ICOA® PRO Mobile App.....	37
8.4.1	Downloading the Mobile App.....	37
8.4.2	Updating the Firmware.....	37
8.4.3	App Overviews.....	38
8.4.3.1	Sidebars Section Overview.....	38
8.4.3.2	Main Section Overview.....	39
8.4.3.3	Main Section Overview in True Wireless Stereo (TWS).....	40
8.4.3.4	Scenes Section Overview.....	41
8.4.3.5	Available Speakers Section Overview.....	42
8.4.3.6	Main EQ Section Overview.....	43
8.4.3.7	Channel EQ Section Overview.....	44
8.4.3.8	Main Config Section Overview.....	45

8.4.3.9	Subwoofer Channels Overview	46
8.4.3.10	Subwoofer Config Overview.....	47
8.4.3.11	Bluetooth® Section Overview.....	48
8.4.3.12	Settings Section Overview	49
8.4.4	Using the App Speaker Setup	49
8.4.4.1	Opening the App Speaker Setup.....	49
8.4.4.2	Linking a Loudspeaker	50
8.4.4.3	Unlinking a Loudspeaker.....	50
8.4.5	Using the Equaliser (EQ).....	51
8.5	True Wireless Stereo (TWS).....	52
8.5.1	About True Wireless Stereo (TWS).....	52
8.5.2	True Wireless Stereo (TWS) on the Device.....	52
8.5.2.1	Opening the Bluetooth® Menu on the Device.....	52
8.5.2.2	Preparing the ICOA® PRO as Main (M) Device for Linking.....	52
8.5.2.3	Linking a Second ICOA® PRO as Follower (F) Device.....	53
8.5.2.4	Unlinking the ICOA® PRO on the Device.....	54
8.5.2.5	Swapping Left and Right on the Device.....	55
8.5.2.6	Toggle Between Mono and Stereo on the Device	55
8.5.3	True Wireless Stereo (TWS) in the App.....	56
8.5.3.1	Linking the ICOA® PRO in the App.....	56
8.5.3.2	Unlinking the ICOA® PRO in the App	56
8.5.3.3	Using the App in True Wireless Stereo (TWS)	57
8.5.3.4	Swapping Left and Right in the App.....	57
8.5.3.5	Toggle Between Mono and Stereo in the App	58
8.5.3.6	Activating and Deactivating Main Coupling.....	58
8.5.3.7	Changing the Main Coupling Settings.....	58
8.6	Input Connections.....	60
8.6.1	Connecting an Input source to the MIC / LINE Input.....	60
8.6.2	Bluetooth® for Audio Playback on the Device	61
8.6.2.1	Opening the Bluetooth® Menu on the Device.....	61
8.6.2.2	Pairing a Mobile Device via Bluetooth® for Audio Playback	61
8.6.2.3	Unpairing a Bluetooth® Device	62
8.6.3	Bluetooth® for Audio Playback in the App	63

8.6.3.1	Pairing a Mobile Device via Bluetooth®	63
8.6.3.2	Unpairing a Mobile Device via Bluetooth®	64
8.7	Audio Playback.....	64
8.7.1	Adjusting the Channel Volume	64
8.7.2	Adjusting the Main Volume	65
8.8	Monitor Mode.....	66
8.8.1	Monitor Mode Use Cases.....	66
8.8.1.1	About Monitor Mode Use Cases.....	66
8.8.1.2	Floor Monitor	66
8.8.1.3	Drum Fill / Side Fill.....	67
8.8.2	Rotating the Horn	68
8.8.2.1	Tools Needed.....	68
8.8.2.2	Removing the Front Grille	68
8.8.2.3	Rotating the Horn.....	68
8.8.2.4	Attaching the Front Grille.....	70
8.8.2.5	Rotating the Front Grille LD Logo	70
8.9	Output Connections	71
8.9.1	Loading a Speaker Preset on the Device	71
8.9.2	Loading a Speaker Preset in the App	71
8.9.3	Connecting an ICOA® PRO Subwoofer via MIX OUT.....	73
8.9.3.1	Connecting Additional ICOA® PRO Subwoofers.....	73
8.10	Loudspeaker Setups.....	74
8.10.1	About Loudspeaker Setups.....	74
8.10.2	Stereo with 2 Tops	74
8.10.3	Stereo with 2 Tops and 2 Subs	75
8.10.4	Stereo with 2 Tops and 4 Subs	76
8.10.5	Stereo with 2 Tops and 4 Subs - no True Wireless Stereo (TWS)*	77
8.10.6	Stereo with 2 Tops and Mono Sub	78
8.10.7	Stereo with 2 Tops and 3 Subs Cardioid	79
8.10.8	Stereo with 2 Tops and 4 Subs (2 Subs Cardioid)	80
8.11	Scenes.....	81
8.11.1	Opening the Scenes Section.....	81
8.11.2	Activating Scenes.....	81

8.11.3	Saving Custom Scenes	81
9	MAINTENANCE	83
9.1	Troubleshooting.....	83
9.2	Resetting the Device to Factory Settings.....	83
9.3	Cleaning the Device	84
9.4	Storing the Device.....	84
10	REPAIR.....	85
11	DISPOSAL	86
11.1	Packaging Disposal	86
11.2	Device Disposal.....	86
	INDEX	87

1 DOCUMENT VERSION AND REVISIONS

Version	Date	Implemented changes
V1.0	04/2025	Original version
V1.1	06/2025	<ul style="list-style-type: none">• General changes• Chapter <i>Scope of Delivery</i>• Chapter <i>Technical Data</i>

2 INTRODUCTION

2.1 YOU MADE THE RIGHT CHOICE!

This product has been developed and manufactured to the highest quality standards to ensure many years of problem-free operation. Find further information about LD Systems on our website:

<https://www.ld-systems.com/>

2.2 CONTACTS

	Adam Hall GmbH Headquarter	Customer Service
E-mail	info@adamhall.com	customerservice@adamhall.com
Phone	+49 6081 9419-0	+49 6081 941973-0
Street	Adam-Hall-Str. 1	Adam-Hall-Str. 1
Postal code / city	61267 Neu-Anspach	61267 Neu-Anspach
Website	www.adamhall.com	www.adamhall.com

2.3 LINK TO THE DOWNLOAD CENTRE

You can download some information, such as CAD data or technical data, from the Download Centre. Scan the QR code or click the link to download this information:

[ICOA® PRO 12 A](#) [ICOA® PRO 15 A](#)



ICOA PRO 12 A



ICOA PRO 15 A

2.4 VISUALISATION CONVENTIONS IN THIS USER MANUAL

In this manual we use graphical symbols and icons in certain contexts. Find below a table with explanations and use cases of the graphical symbols and icons.

Icon / Symbol	Designation	Context	Explanation / Example
✓	Prerequisite	Tasks	Used in task topics to indicate a prerequisite that must be met before beginning the task.
⇒	Result / Intermediate Result	Tasks	Used in task topics to indicate a result or intermediate result of an action step.
1 Step a) Substep	1 Action Step a) Substep	Tasks	Used in task topics to indicate action steps and substeps.
1	Callout	Graphics; tasks	Text-image reference or labeling of certain functions on the device
[...]	Value range indicator	Technical data; paragraphs; lists	Indicates the range of a value, such as "Compressor ratio: 1:1...20:1 ". Mostly used in tables or callouts.
*	Asterisk	Paragraphs; tables	Indicates additional information in a footnote.
The LIM LED lights up	General User Interface element	Paragraphs; tasks; tables; lists	The words presented in this way represent graphic user interface elements on the device.
PAGE button	Key / Button	Paragraphs; tasks; tables; lists	The words presented in this way represent user interface controls on the device.
<name>	User input	Paragraphs; tasks; tables; lists	The words presented in this way represent required user inputs.
<u>https://adamhall.com</u>	Weblink	Paragraphs; tables; lists	External link to a website

3 PRODUCT COMPLIANCE

3.1 MANUFACTURER'S DECLARATION

Adam Hall offers a voluntary, EU-wide manufacturer's guarantee of 2 years. The statutory warranty period is not affected by this voluntary guarantee.

Visit the Adam Hall Service Portal to access the **Download Centre**:

<https://portal.adamhall.com/>

Under the **Service & Regulations** section, you find our current detailed manufacturer's declarations, warranty conditions, and limitation of liability.

To request warranty for a product, please contact:

Adam Hall GmbH, Adam-Hall-Str. 1, 61267 Neu-Anspach

customerservice@adamhall.com

0049 (0)6081 / 9419-1000.

3.2 DECLARATION OF CONFORMITY

UK
CA

Hereby, Adam Hall Ltd. declares that this product meets the following guidelines (where applicable)

- Electrical Equipment (Safety) Regulations 2016
- Electromagnetic Compatibility Regulations 2016 (SI 2016/1091)
- The Restriction of the Use of Certain Hazardous Substances in Electrical and Electronic Equipment Regulation 2012 (SI 2012/3032)
- Radio Equipment Regulations 2017 (SI 2016/2015)

Products that are subject to Electrical Equipment(Safety)Regulation 2016, EMC Regulation 2016 or RoHS Regulation can be requested at info@adamhall.com. Products that are subject to the Radio Equipments Regulations 2017 (SI2017/1206) can be downloaded at <http://www.adamhall.com/compliance>.

FCC STATEMENT

FC

This device complies with part 15 of the FCC Rules. Operation is subject to the following two conditions:

1. This device may not cause harmful interference.
2. This device must accept any interference received, including interference that may cause undesired operation.

CAUTION! RF Exposure Information: This equipment complies with FCC radiation exposure limits set forth for an uncontrolled environment. This equipment should be installed and operated with minimum distance 20cm between the radiator and your body.

CAUTION! Any changes or modifications to this device not explicitly approved by the manufacturer could void your authority to operate this equipment.

This equipment has been tested and found to comply with the limits for a Class B digital device, pursuant to part 15 of the FCC Rules. These limits are designed to provide reasonable protection against harmful interference in a residential installation. This equipment generates, uses and can radiate radio frequency energy and, if not installed and used in accordance with the instructions, may cause harmful interference to radio communications. However, there is no guarantee that interference will not occur in a particular installation. If this equipment does cause harmful interference to radio or television reception, which can be determined by turning the equipment off and on, the user is encouraged to try to correct the interference by one or more of the following measures:

- Reorient or relocate the receiving antenna.
- Increase the separation between the equipment and receiver.
- Connect the equipment into an outlet on a circuit different from that to which the receiver is connected to.
- Consult the dealer or an experienced radio/TV technician for help.

ISED STATEMENT

This device contains licence-exempt transmitter(s)/receiver(s) that comply with Innovation, Science and Economic Development Canada's licence-exempt RSS(s). Operation is subject to the following two conditions:

1. This device may not cause interference.
2. This device must accept any interference, including interference that may cause undesired operation of the device.

The digital apparatus complies with Canadian CAN ICES-003 (B)/NMB-003(B).

This equipment complies with IC RSS-102 radiation exposure limits set forth for an uncontrolled environment.

This equipment should be installed and operated with minimum distance 20cm between the radiator and your body.

This device meets the exemption from the routine evaluation limits in section 2.5 of RSS 102 and compliance with RSS 102 RF exposure, users can obtain Canadian information on RF exposure and compliance.

4 SAFETY INSTRUCTIONS

4.1 INTENDED USE

The **ICOA® PRO** is an active coaxial PA loudspeaker with Bluetooth®, and app control, intended as sound reinforcement in PA and monitor applications.

This product has been developed for the professional use in the field of event technology. Furthermore it is intended for qualified users with specialist knowledge of event technology only.

The device is intended for mobile applications and not for fixed installations.

The device is intended for indoor use only.

It is not suitable for domestic use.

Do not use the product outside the operating conditions as stated in the user manual under Technical Data. Liability for damage and third-party damage to persons and property due to inappropriate use is excluded.

This product is not suitable for children and persons with limited physical, sensory, or mental capabilities or lack of experience and knowledge.

4.2 EXPLANATION OF SAFETY AND WARNING SYMBOLS

Find the following safety and warning symbols on the device, the user manual, or the packaging:



This symbol indicates that you must read the complete user manual before using the product.



This symbol indicates a general hazardous situation.



This symbol indicates hazards that can cause electric shock.



This symbol indicates tripping hazards.



This symbol indicates high sound pressure levels.



This symbol indicates pinching hazards.



This symbol indicates that the product is for indoor use only.



This symbol indicates that the product is not suitable for household use.



This symbol indicates helpful hints or additional information.

4.3 STRUCTURE OF WARNING MESSAGES

In this user manual, warning messages are structured with a safety symbol, a signal word, a hazard description, and instructions on how to avoid injuries or death.



DANGER

Indicates a hazardous situation which will result in death or serious injury.



WARNING

Indicates a hazardous situation which could result in death or serious injury



CAUTION

Indicates a hazardous situation which could result in minor or moderate injury.



NOTICE

Indicates situations or conditions that could result in damage to property and/or the environment.

4.4 GENERAL SAFETY



- Read this document carefully.

- Keep this document for later reference.



- Follow closely the instructions in this document.



- This document is an integral part of the product. If you sell or pass on the product, you must include this document.

- Only use this product according to its intended use.

- Risk of choking. Keep small parts away from children and individuals with impaired physical, sensory, or mental capabilities.

- Risk of suffocation. Keep plastic bags away from children and individuals with impaired physical, sensory, or mental capabilities.

- Observe all safety instructions and warning messages in this document, on the device, and on the packaging.

- Products are subject to continuous further development. If you find discrepancies between this document and the product labeling, the information on the product always takes priority.

- Do not remove safety instructions or warning messages from the product.

- Do not open the device.

- Do not modify the product.

- If the product shows any sign of damage, do not use it.

- Do not operate the product with removed or missing covers.

- Do not expose the product to direct sunlight.
- If not further specified in the user manual under Technical Data, do not use the product in ambient temperatures that exceed 40 °C / 104 °F or fall below 0 °C / 32 °F
- Do not use the product in tropical climate.
- Do not use the product above 2000 metres of altitude.
- Unless otherwise stated, do not use the product under marine conditions.
- Use only accessories specified by the manufacturer.
- Maintenance and repairs may only be carried out by authorized service personnel.
- Store and transport the product in a dry and safe environment.
- Clean the product on a regular basis. If applicable, see the user manual for maintenance intervals.
- If the device was exposed to strong temperature changes, such as during transport, do not switch it on immediately. Wait until the device has reached ambient temperature.
- High sound pressure levels may cause hearing damage. Avoid prolonged exposure to high sound pressure levels. Wear hearing protection.
- Risk of hearing damage. Plugging or unplugging devices in the signal chain may cause an audio signal peak. Switch on the loudspeaker as the last device in the signal chain.
- Risk of hearing damage. Switching on or off other devices in the signal chain may cause an audio signal peak. Switch on the loudspeaker as the last device in the signal chain.

4.5

ELECTRICAL SAFETY



- This is an electrical device in protection class I. Make sure that the protective conductor is connected to electrical earth. Do not disconnect the protective conductor.
- Do not bypass the mains fuse.
- Use only mains fuses as specified by the manufacturer.
- Do not use kinked or otherwise damaged power cables.
- Only operate the device on compliant, tested and intact mains power outlets.
- Do not use the device in the vicinity of water. Keep the device away from splashing or dripping water.
- Make sure that the voltage and frequency of the mains power match the values specified by the manufacturer.
- Take suitable measures against overvoltage, such as lightning strikes.
- For devices with a power out connector, make sure the total current consumption of all connected devices does not exceed the value specified by the manufacturer.
- This device is not suitable for continuous current.
- Disconnect the device from all poles before maintenance, repair or extend periods of non-use.
- Permanently connected power cables may only be replaced by a qualified service technician.

4.6

PHYSICAL SAFETY



- Make sure that the device and its stand are securely positioned. Secure against unintentional movement.



- Check all cable routes to prevent tripping accidents.

- Moving components, such as mounting brackets, pose a risk of pinching injuries.



4.7 THERMAL SAFETY

- Do not install the device near heat sources, such as radiators or ovens.
- Do not block any ventilation openings.
- Unless otherwise stated, keep a minimum clearance of at least 20 centimetres around the device.
- Unless otherwise stated, keep flammable materials, such as paper or wood, at least 50 centimetres away from the device

4.8 WIRELESS SAFETY



Radio transmitter operation is subject to official regulations. Make sure you adhere to regional guidelines before commissioning.

Radio operation can lead to potentially dangerous effects. Do not use this device in sensitive areas such as:

- Hospitals, health centres or other healthcare facilities that provide patient treatment with skilled personnel and equipment
- Hazardous areas Class I, II and III
- Restricted areas
- Military facilities
- Areas where the use of mobile phones is prohibited, such as aircrafts.



Quality and performance of wireless signal transmissions is dependent on the environmental conditions. All range specifications refer to free-field application with visual contact without interference. Range and signal stability may be influenced by:

- Shielding, such as masonry, metal buildings, or water
- Interference
- High radio traffic, such as strong W-LAN networks
- Electromagnetic radiation, such as LED video walls or dimmers

4.9 DEVICE SAFETY



- Do not switch the device on and off in quick succession, because this will shorten the device lifetime.
- Loudspeakers generate a magnetic field, even when they are not in use. Devices, such as hard disk drives or cheque cards may be affected by the loudspeaker's magnetic field. Do not set up or transport these devices near the loudspeaker.

5 PRODUCT DESCRIPTION

5.1 PRODUCT OVERVIEW

The LD Systems **ICOA® PRO** is a powered coaxial PA loudspeaker with digital mixer.

FEATURES:

- Integrated digital 4-channel mixer
- Bluetooth® audio streaming
- App Control

5.2 PRODUCT VARIANTS

The LD Systems **ICOA® PRO** Series offers the following product variants. Each variant is available in black and white RAL 9003.

- LDICOA12APRO - Powered coaxial PA loudspeaker with 12" subwoofer and 1.75" high-frequency driver with Bluetooth® and app control.
- LDICOA15APRO - Powered coaxial PA loudspeaker with 15" subwoofer and 1.75" high-frequency driver with Bluetooth® and app control.

5.3 OPTIONAL ACCESSORIES

Find various accessories for your product in the Adam Hall Shop:

<https://www.adamhall.com/shop>

Accessory	ICOA12APRO	ICOA15APRO
Powered 21" subwoofer	ICOA® PRO SUB 21 A Article number: LDICOASUB21APRO	
Padded protective cover for ICOA® Tops	ICOA® 12 PC Article number: LDICOA12PC	ICOA® 15 PC Article number: LDICOA15PC
Weather protective cover for ICOA® Tops	ICOA® 12 WPC Article number: LDICOA12WPC	ICOA® 15 WPC Article number: LDICOA15WPC
EasyMount® Bracket for Stinger® 12" and 15"	STINGER G3 TMB Article number: LDEBG3TMB	
Universal Mounting Bracket for ICOA® Tops	ICOA® 12 UB Article number: LDICOA12UB	ICOA® 15 UB Article number: LDICOA15UB
Clamp for Mounting Bracket	RIGGATEC 400200971 Article number: RIG400200971	
Eyebolt Galvanised M10 for ICOA® flying points	5431 M10 Article number: 5431M10	
SAVEKING® Safety Rope 4 mm, 0.6 m , with Cable Eyes, Black	S 43062 SKB Article number: S43062SKB	

5.4 DIMENSIONS

Visit the download centre to download the product dimensions as a CAD file.

5.5 TECHNICAL DATA

GENERAL

Article number	LDICOAPRO12A(W)	LDICOAPRO15A(W)
Product type	12" Powered Coaxial High-Performance PA Loudspeaker with Bluetooth® and App	15" Powered Coaxial High-Performance PA Loudspeaker with Bluetooth® and App
Power (Peak)	2000 W	3000 W
Power (RMS)	1000 W	1500 W
Amplifier	Class D	Class D
Max SPL Peak (Sine Burst)	127 dB	130 dB
Max SPL Average (Sine Burst)	118 dB	120 dB
Max SPL Peak (Pink Noise)	133 dB	135 dB
Frequency response (-10dB)	53 Hz...20 kHz	50 Hz...20 kHz
Crossover frequency	800 Hz	800 Hz
Dispersion (H x D)	90° x 50°	90° x 50°
Monitor Angle	50°	50°

AMBIENT CONDITIONS

Article number	LDICOAPRO12A(W)	LDICOAPRO15A(W)
Ambient temperature (operating)	0 °C...40 °C	0 °C...40 °C
Relative humidity	< 80 %	< 80 %
Protective circuits	DC protection, Short circuit, Multi-band limiter, Overheat	DC protection, Short circuit, Multi-band limiter, Overheat

BLUETOOTH®

Article number	LDICOAPRO12A(W)	LDICOAPRO15A(W)
Bluetooth® version	5.1	5.1
Bluetooth® functions	Audio & Data	Audio & Data
Bluetooth® audio decoder	SBC & AAC	SBC & AAC

INPUTS

Article number	LDICOAPRO12A(W)	LDICOAPRO15A(W)
Mic / Line inputs	2	2
Mic / Line input connectors	XLR / Jack	XLR / Jack

OUTPUTS

Article number	LDICOAPRO12A(W)	LDICOAPRO15A(W)
Line outputs	1	1
Line output connectors	XLR	XLR

SIGNAL PROCESSING

Article number	LDICOAPRO12A(W)	LDICOAPRO15A(W)
DSP model	SysCore®	SysCore®
AD/DA converter bit depth	24 Bit	24 Bit
AD/DA converter sampling frequency	48 kHz	48 kHz
Signal-to-noise ratio (SNR)	108 dB	108 dB

BASS DRIVER

Article number	LDICOAPRO12A(W)	LDICOAPRO15A(W)
Woofers size	12"	15"
Woofers outside diameter	312.3 mm	386.3 mm
Woofers voice coil (inch)	3"	3"
Woofers magnet	Ferrit	Ferrit
Woofers brand	Celestion Custom-made	Celestion Custom-made

TWEETER

Article number	LDICOAPRO12A(W)	LDICOAPRO15A(W)
Tweeter size (inch)	3"	3"
Tweeter outlet diameter	36.68 mm	36.68 mm
Tweeter voice coil (inch)	3"	3"
Tweeter magnet	Ferrit, Common Motor Design	Ferrit, Common Motor Design
Tweeter brand	Celestion Custom-made	Celestion Custom-made

MAINS OPERATION

Article number	LDICOAPRO12A(W)	LDICOAPRO15A(W)
Operation voltage	AC 100...240 V 50...60 Hz	AC 100...240 V 50...60 Hz
Power consumption	max. 650 W	max. 950 W
Power supply	SMPS	SMPS
Power connector	powerCON®	powerCON®
Fuse	T 6,3AH / 250 V	T 10AH / 250 V

HOUSING

Article number	LDICOAPRO12A(W)	LDICOAPRO15A(W)
Housing colour	Black / White (RAL9003)	Black / White (RAL9003)
Housing material	ABS	ABS
Number of handles	4	4
Number of fly points	6	6
Flange	0° / 5° (SM 7 DT)	0° / 5° (SM 7 DT)
Cooling	Passive, Cooling fins	Passive, Cooling fins

DIMENSIONS AND WEIGHT

Article number	LDICOAPRO12A(W)	LDICOAPRO15A(W)
Dimensions (W x H x D)	376 mm x 627.8 mm x 393.6 mm	417 mm x 690.7 mm x 414.8 mm
Weight	23.1 kg	25.8 kg

5.6 USER INTERFACE

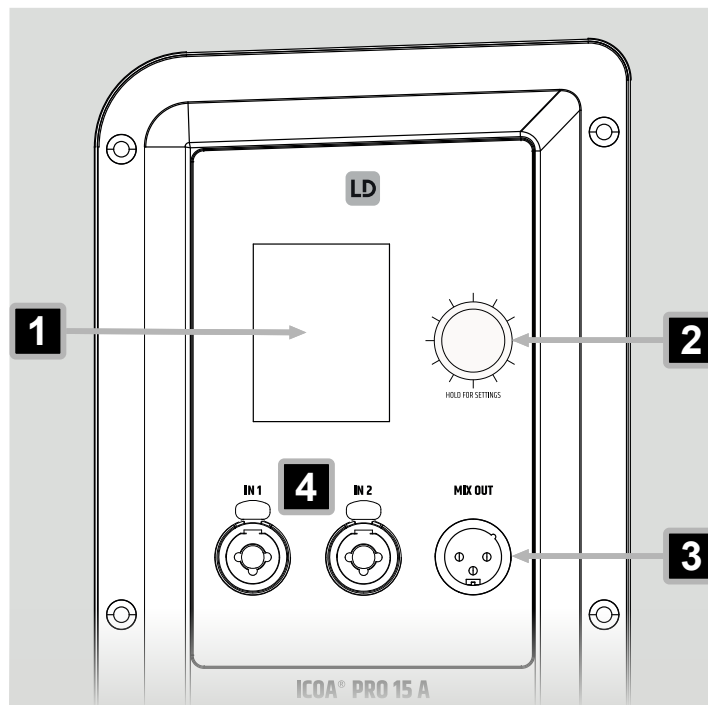

- 1** **LC Display** - Main graphic colour display
- 2** **Rotary-Push Encoder (RPE)** - Controls the main menu items. Push and hold 2 seconds to access the settings.
- 3** **MIX OUT** - Audio output socket (balanced 3-pin XLR). Outputs the prefade main mix.
- 4** **IN 1 / IN 2** - Balanced XLR / 6.35 mm jack combo sockets for mic or line connections

5.7 FRONT LED

Set the function of the front LED **1** in the **SETTINGS** section on the device or in the **Main Config** section via the **ICOA® PRO** mobile app:

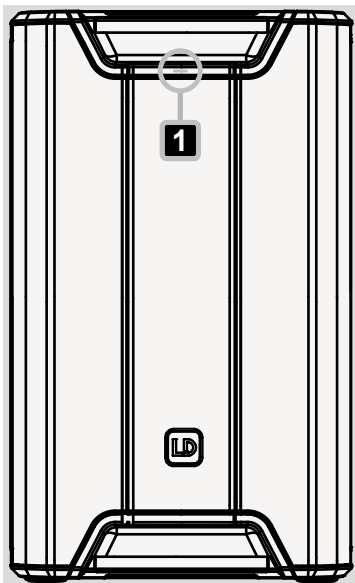

- **Limit (Default):**
White LED when the device is switched on.
Red LED when the limiter is active.
- **On:**
White LED when the device is switched on.
- **Off:**
LED is off permanently.

See also:

[Accessing the Settings Section \[▶ 32\]](#)

[Settings Section Overview \[▶ 36\]](#)

[Main Config Section Overview \[▶ 45\]](#)

6 PREPARATION

6.1 SCOPE OF DELIVERY

- Device
- Mains power cable
- Safety Compliance Information
- Quick Start Guide

7 INSTALLATION

7.1 ABOUT HORIZONTAL USE OF THE DEVICE



This loudspeaker is designed for vertical and horizontal use. Rotate the horn for horizontal applications to adjust the dispersion.

See also:

Rotating the Horn [▶ 68]

7.2 DEVICE MOUNTING

7.2.1 MOUNTING THE DEVICE ON A STAND OR A SPEAKER POLE



WARNING

Falling object

Risk of serious injury

- a. Observe all regional safety regulations concerning overhead loads.
- b. Use only stands or speaker poles with a suitable tube diameter.
- c. Make sure that the stand or speaker pole supports the weight of the device.
- d. Make sure that the stand or the device with attached speaker pole is securely positioned on a level surface.

✓ You have securely set up an appropriate stand or a speaker pole with a tube diameter of 35 mm.

- 1 Lift and place the **ICOA® PRO** onto the flange position for a tilt angle of 0° **1** or onto the flange position for a tilt angle of 5° **2**.



See also:

Optional Accessories [▶ 18]

7.2.2 ATTACHING THE M10 EYEBOLT

- 1 Remove the protective cap from the needed fly point. **1**
- 2 Screw in the M10 eyebolt. **2**

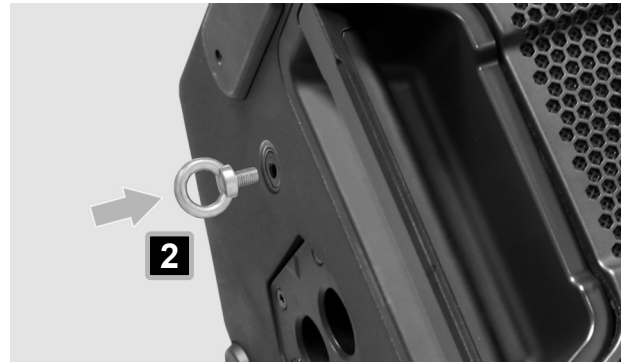

See also:
Optional Accessories [▶ 18]

7.2.3 ATTACHING THE UNIVERSAL MOUNTING BRACKET



WARNING

Falling object

Risk of serious injury

- a. Observe all regional safety regulations concerning overhead loads.
- b. Make sure that the device is securely mounted.
- c. Make sure that the mounting accessory supports the weight of the device.
- d. Before any assembly, check that all mounting bracket components are complete, undamaged and work correctly.



WARNING

Pinching Hazard

Risk of Injury

- a. Be cautious while assembling the brackets. Handle with care to avoid injury.



- 1 Remove both protective caps from the top of the **ICOA® PRO**. **1**



2 Screw in both screws of the stop bracket. **2**



Observe the labelling on the stop bracket (ICOA 12 / ICOA 15). Use the correct holes according to your ICOA® PRO model.



3 Place the spigot of the U-bracket **3** into the flange position for a tilt angle of 0° **4**.



4 Align the U-bracket with the stop bracket. **5**

5 Insert the screw and tighten the nut on the other side. **6**

6 Adjust the needed angle for the U-bracket.

7 Screw in the tommy screw **7** to fix the position.

See also:

Optional Accessories [▶ 18]

Rotating the Horn [▶ 68]

7.2.4 ATTACHING THE EASYMOUNT® BRACKET



WARNING

Falling object

Risk of serious injury

- a. Observe all regional safety regulations concerning overhead loads.
- b. Make sure that the device is securely mounted.
- c. Make sure that the mounting accessory supports the weight of the device.
- d. Before any assembly, check that all mounting bracket components are complete, undamaged and work correctly.



WARNING

Pinching Hazard

Risk of Injury

- a. Be cautious while assembling the brackets. Handle with care to avoid injury.

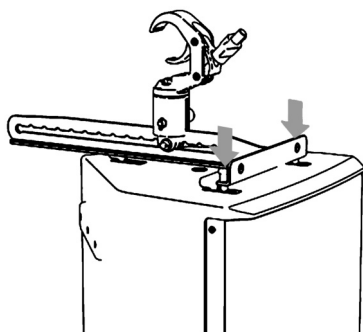
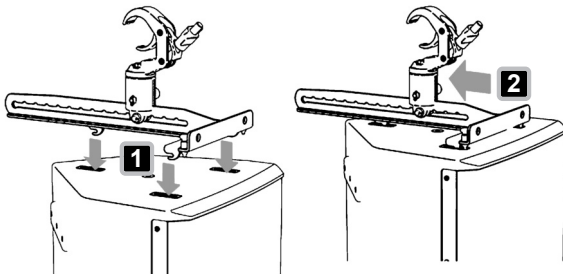

- 1** Insert all three steel hooks **1** of the Easy-Mount® bracket into the corresponding retaining sockets on the speaker.
- 2** Slide the entire bracket **2** towards the back of the speaker.
- 3** Make sure that the spring-loaded locking pins engage fully.



You can hear a clicking sound when it locks into place.

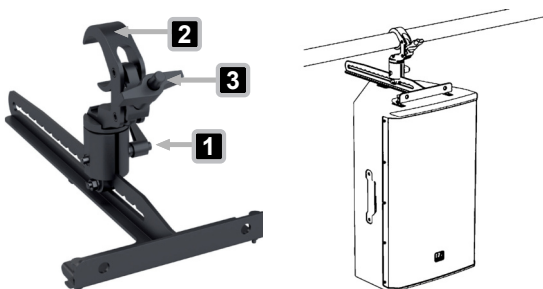

- 4** Before attaching the speaker to a traverse, tighten the clamping screw **1** of the mounting bracket.
- 5** Use the traverse clamp **2** to suspend the speaker from a horizontal traverse in a suitable position.
- 6** Fasten it into place with the wing nut. **3**

See also:
Optional Accessories [▶ 18]

8 OPERATION

8.1 POWER SUPPLY

8.1.1 POWER CONNECTIONS

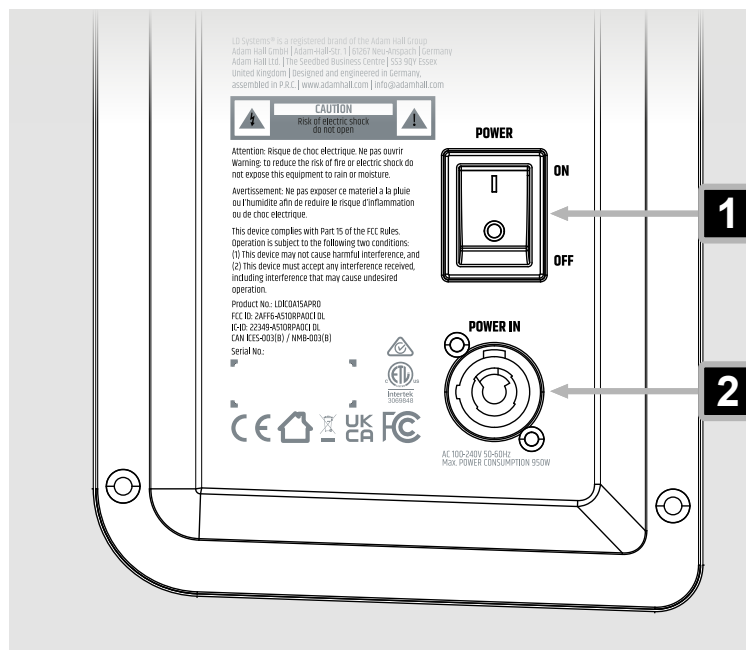

- 1** POWER - On / Off switch
- 2** POWER IN - Device power socket

8.1.2 CONNECTING A MAINS POWER CABLE



CAUTION

Mains voltage

Risk of electric shock

- a. Do not use kinked or damaged mains power cables.



NOTICE





Damage to the Device

- a. Make sure that the voltage of the mains power socket matches the device operating voltage.
- b. Use only supplied power cables or original Neutrik powerCON® XX cables. Otherwise you must not plug or unplug the device under load.

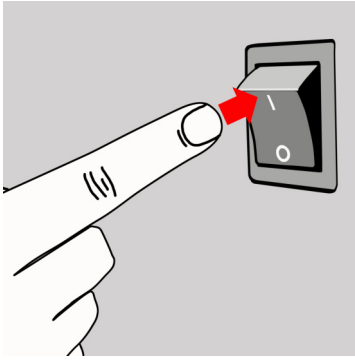
- 1** Plug the device power connector into the device. Make sure the bayonet connector is positioned correctly.
- 2** Turn the bayonet connector clockwise to lock it.
- 3** Plug the mains power connector into the mains power socket.

8.1.3 TURNING THE DEVICE ON OR OFF



- 1** Flip the switch from the  to the  position.
 - ⇒ The display turns on and the device boots.
 - ⇒ After a few seconds, the device is operational.
- 2** Flip the switch from the  to the  position.
 - ⇒ The device turns off.

8.1.4 DISCONNECTING A MAINS POWER CABLE



NOTICE

Damage to the Device

- a. Make sure that the voltage of the mains power socket matches the device operating voltage.
- b. Use only supplied power cables or original Neutrik powerCON® XX cables. Otherwise you must not plug or unplug the device under load.

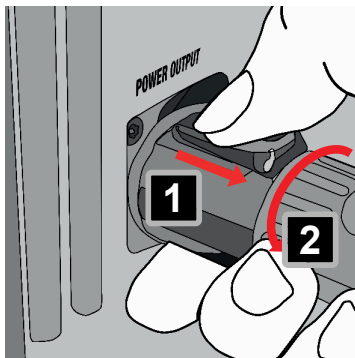

- 1** Disconnect the mains power connector of the mains power cable from the mains power socket.
- 2** Pull the locking lever of the bayonet connector backwards and hold it. **1**
- 3** Turn the bayonet connector anticlockwise. **2**
- 4** Pull the bayonet connector out of the socket.

8.2 NAVIGATING THE DEVICE

8.2.1 USING THE ROTARY-PUSH ENCODER

Use the **rotary-push encoder (RPE)** to access the menu items on the **ICOA® PRO**. Find the procedure to access the **MAIN** channel **EQ** below as an example. All other main screen menu items follow the same structure.



The menu follows a left to right and top to bottom grid structure. When you reach the bottom right menu item, the grid starts again at the top left. The cursor jumps back to the **MAIN** channel after approximately 10 seconds of inactivity.

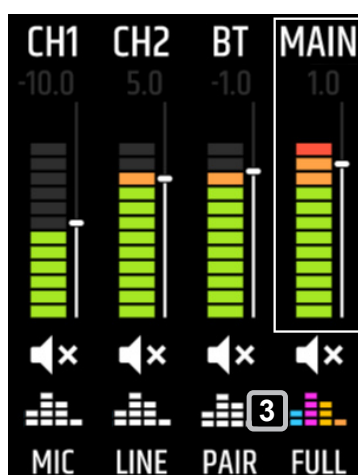
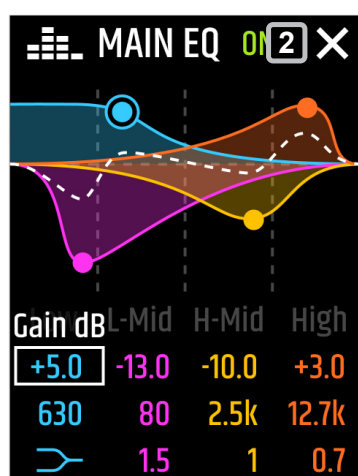
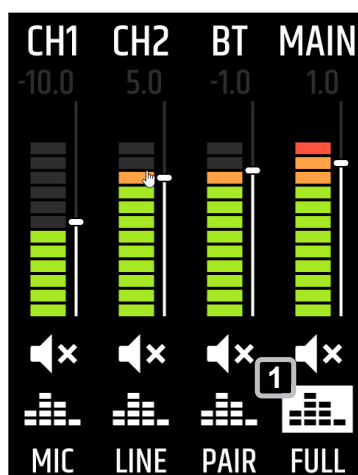

- 1 In the main screen, turn the **RPE** clockwise until  is highlighted. **1**
- 2 Push the **RPE** to access the **MAIN EQ** sub menu.

⇒ The **MAIN EQ** screen appears.

- 3 Adjust the **EQ**.
- 4 Turn the **RPE** until  is highlighted. **2**
- 5 Push the **RPE** to close the **MAIN EQ** screen.

⇒ The **MAIN EQ** is displayed in colour **3** to indicate that settings have been made in the corresponding equaliser.

8.2.2 ACCESSING THE SETTINGS SECTION

You can access the **SETTINGS** section from any grid position in the main screen.

- ✓ The main screen is displayed.
- 1** Push and hold the **rotary-push encoder (RPE)** for approximately 2 seconds.
 - ⇒ The **SETTINGS** section appears.

8.3 DEVICE DISPLAY OVERVIEWS

8.3.1 MAIN SCREEN OVERVIEW

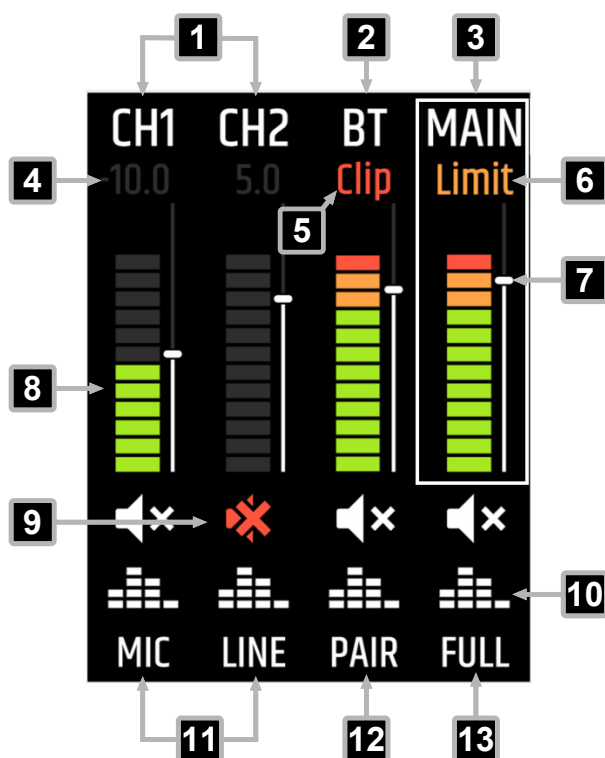

- 1** CH1 / CH2 - Channel names for input channels 1 and 2. Select to access the channel fader (see 7)
- 2** BT - Channel name for the Bluetooth® channel. Select to access the channel fader (see 7)
- 3** MAIN - Channel name for the main output channel. Select to access the channel fader (see 7)
- 4** Fader Value - Indicates the fader value in decibels (-80 dB ... +10 dB)
- 5** Clip - Indicates that the corresponding input channel is clipping
- 6** Limit - Indicates that the MAIN channel limiter is active
- 7** Channel Fader - Increases / decreases the output volume of the corresponding input channel
- 8** Metering - 12-segment channel metering
- 9** Mute - Toggles mute on or off for the corresponding channel
- 10** Equaliser - Opens the equaliser sub menu. If the equaliser is flat, the icon is white.
- 11** MIC / LINE - Toggles MIC or LINE input for the corresponding channel
- 12** PAIR - Opens the Bluetooth® channel pairing menu
- 13** Speaker Preset - Opens the speaker preset sub menu (FULL, FLAT, MON, SAT)

8.3.2

EQ SECTION OVERVIEW

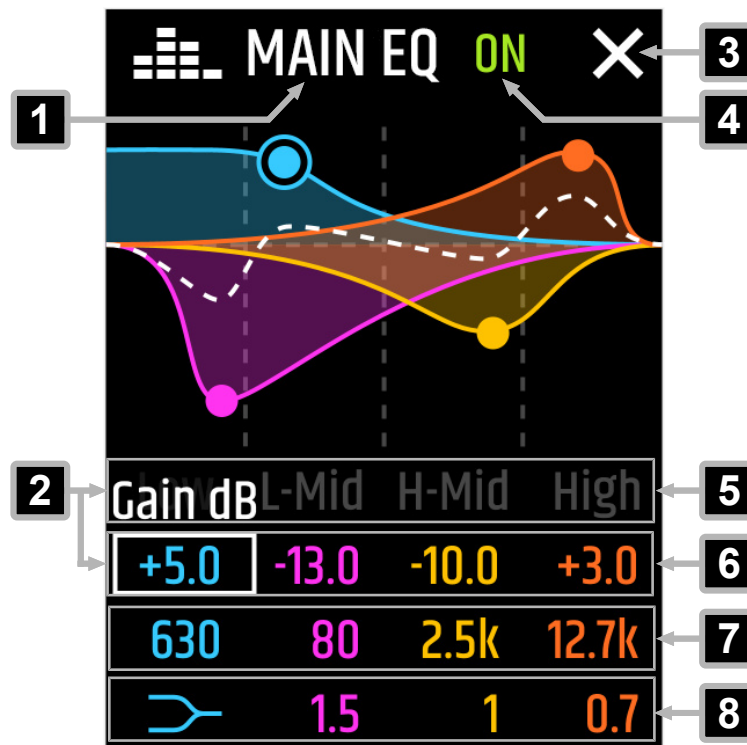

- 1** **Channel Name** - Indicates the channel name
- 2** **Selected Parameter** - Indicates the selected parameter
- 3** **X** - Closes the section
- 4** **ON / OFF** - Toggles the equaliser on / off
- 5** **Equaliser Band** - Indicates the corresponding equaliser band (**Low, L-Mid, H-Mid, High**)
- 6** **Gain** - Adjusts the gain of the selected equaliser band
- 7** **Frequency** - Adjusts the frequency of the selected equaliser band
- 8** **Quality** - Adjusts the quality of the selected equaliser band (lowshelf, highshelf)

8.3.3

EQ PRESET SECTION OVERVIEW

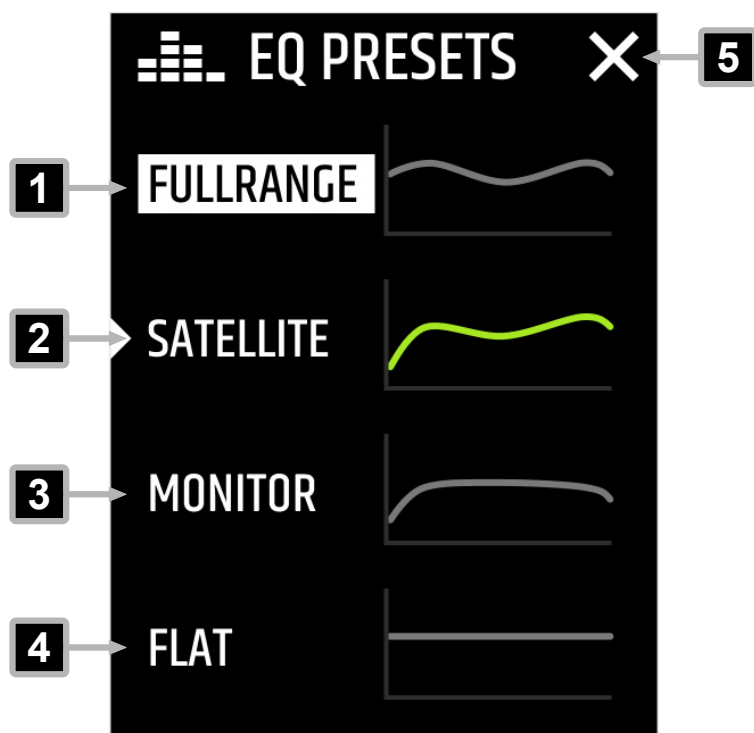

- 1** **FULLRANGE** - Selects the corresponding equaliser preset
- 2** **SATELLITE** - Selects the corresponding equaliser preset
- 3** **MONITOR** - Selects the corresponding equaliser preset
- 4** **FLAT** - Selects the corresponding equaliser preset
- 5** **X** - Closes the section

8.3.4 SETTINGS SECTION OVERVIEW

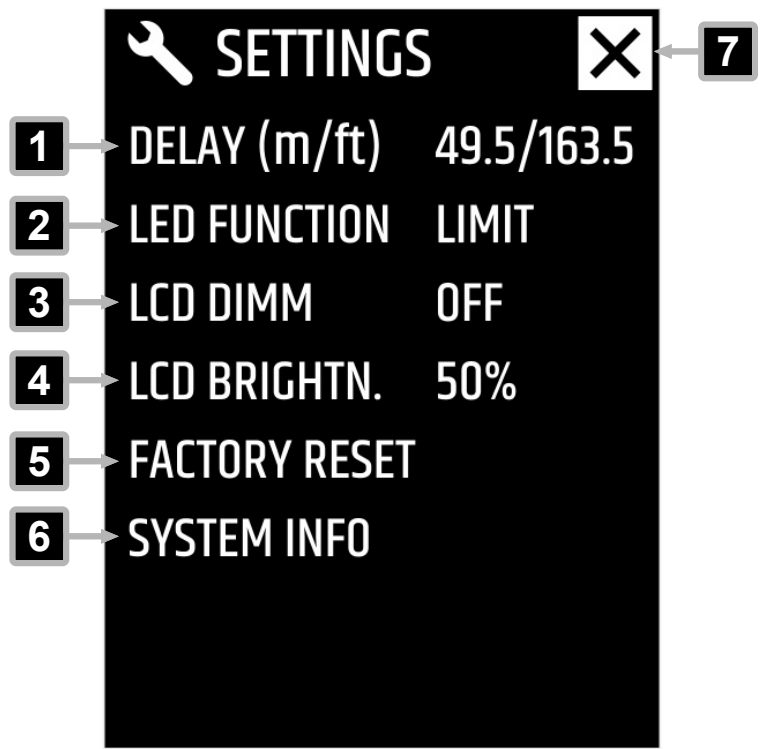

- 1** DELAY (m/ft) - Adjusts the signal delay of the **ICOA® PRO**
- 2** LED FUNCTION - Toggles between the functions of the front LED (**LIMIT, ON, OFF**)
- 3** LCD DIMM - Toggles the display dimming on / off
- 5** LCD BRIGHTN. - Adjusts the display brightness (50 %...100 %)
- 5** FACTORY RESET - Resets the device to factory settings
- 6** SYSTEM INFO - Displays the system information (product type, firmware version, DSP version)
- 7** ✕ - Closes the section

8.4 ICOA® PRO MOBILE APP

8.4.1 DOWNLOADING THE MOBILE APP



Download the app
for full functionality!

Visit the Apple App Store or the Google Play Store to download the device app for advanced functionality and features.

8.4.2 UPDATING THE FIRMWARE



For full functionality of the device, update the firmware before commissioning.

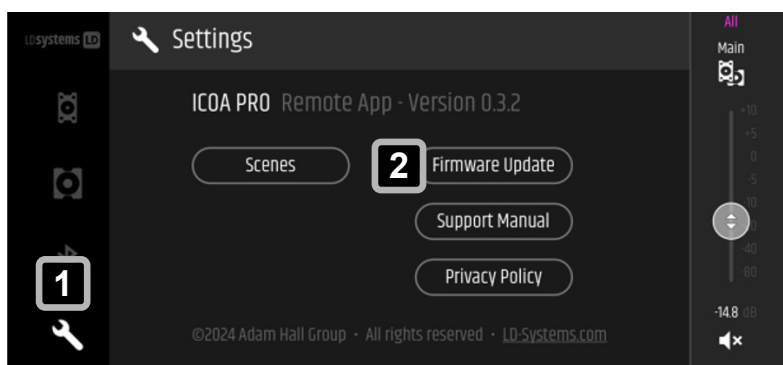

1 In the **Settings** section **1**, tap on **Firmware Update** **2** to open the **Firmware Update** screen.

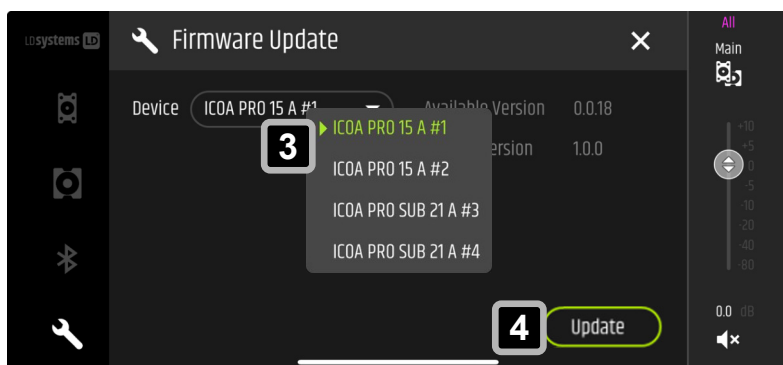

2 Under **Device**, select the **ICOA® PRO** you want to update from the drop-down menu **3**.
3 Tap on **Update** **4** to start the update process.

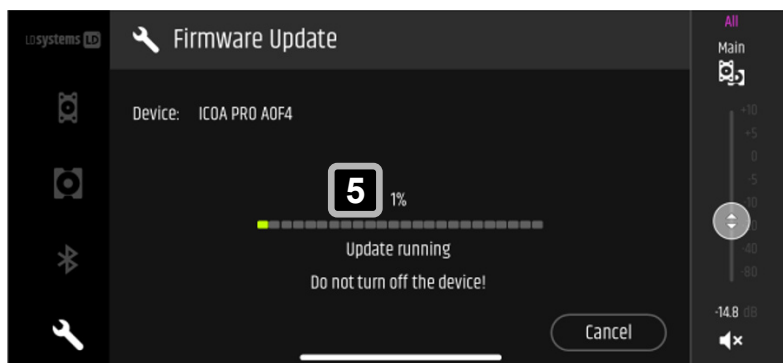

4 The **Update running** progress bar opens. **5**



When using multiple devices in your setup, you must update each device individually.

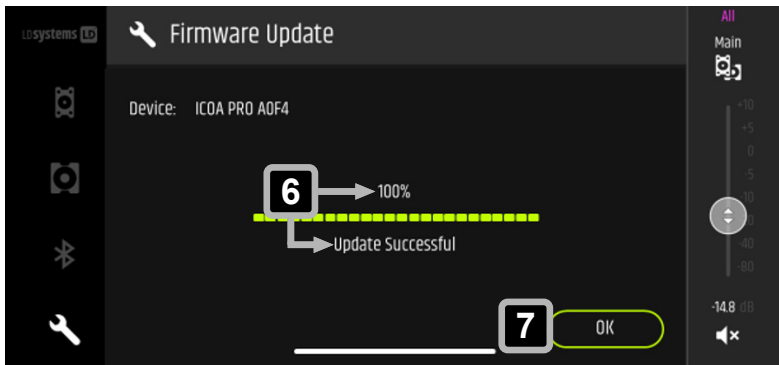

- 5 When the firmware update was successful, the progress bar shows **100%** and **Update Successful**. **6**
- 6 Tap on **OK** **7** to complete the firmware update.

8.4.3 APP OVERVIEWS

8.4.3.1 SIDEBARS SECTION OVERVIEW

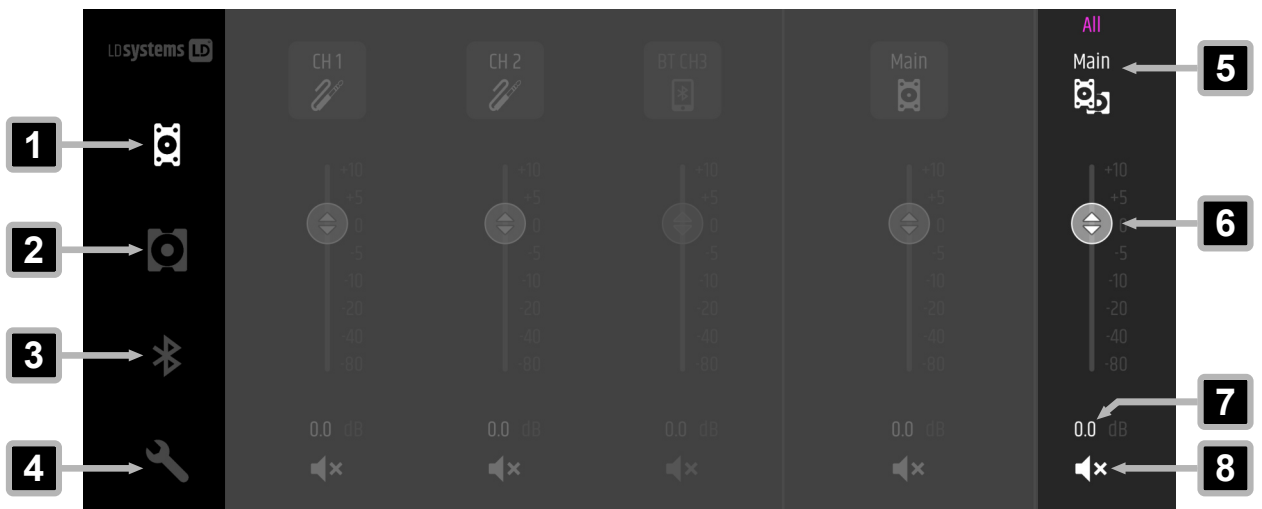

- 1 Main Section** - Opens the section to control input and output channels of main loudspeakers
- 2 Subwoofer Section** - Opens the section to control subwoofers
- 3 Bluetooth® Section** - Opens the Bluetooth® section
- 4 Settings Section** - Opens the settings section
- 5 Main** - Indicates the main output channel name
- 6 Main Channel Fader** - Adjusts the volume of the main output (-80 dB...+10 dB)
- 7 Fader Value** - Indicates the main output channel fader value in dB (-80 dB...+10 dB)
- 8 Mute** - Toggles mute on / off

8.4.3.2

MAIN SECTION OVERVIEW

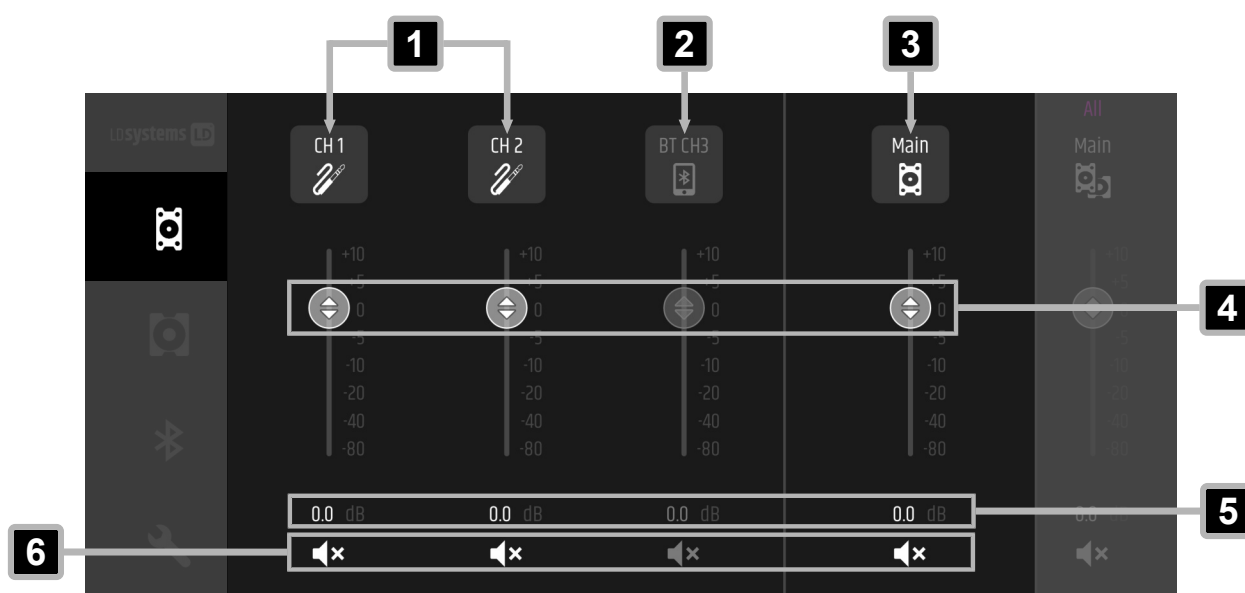

- 1** **Input Channels** - Indicates the input channels of the **ICQA® PRO**. Tap to open the channel settings.
- 2** **Bluetooth® Channel** - Indicates the Bluetooth® channel. Tap to open the channel settings.
- 3** **Main Channel** - Indicates the main output of the **ICQA® PRO**. Tap to open the channel settings.
- 4** **Faders** - Adjust the volume of the corresponding channel (-80 dB...+10 dB)
- 5** **Fader Values** - Indicate the corresponding fader level in dB (-80 dB...+10 dB)
- 6** **Mute** - Toggles mute on / off

8.4.3.3 MAIN SECTION OVERVIEW IN TRUE WIRELESS STEREO (TWS)

 When using True Wireless Stereo (TWS), the main section shows the inputs and main channels of both **ICOA® PRO**.

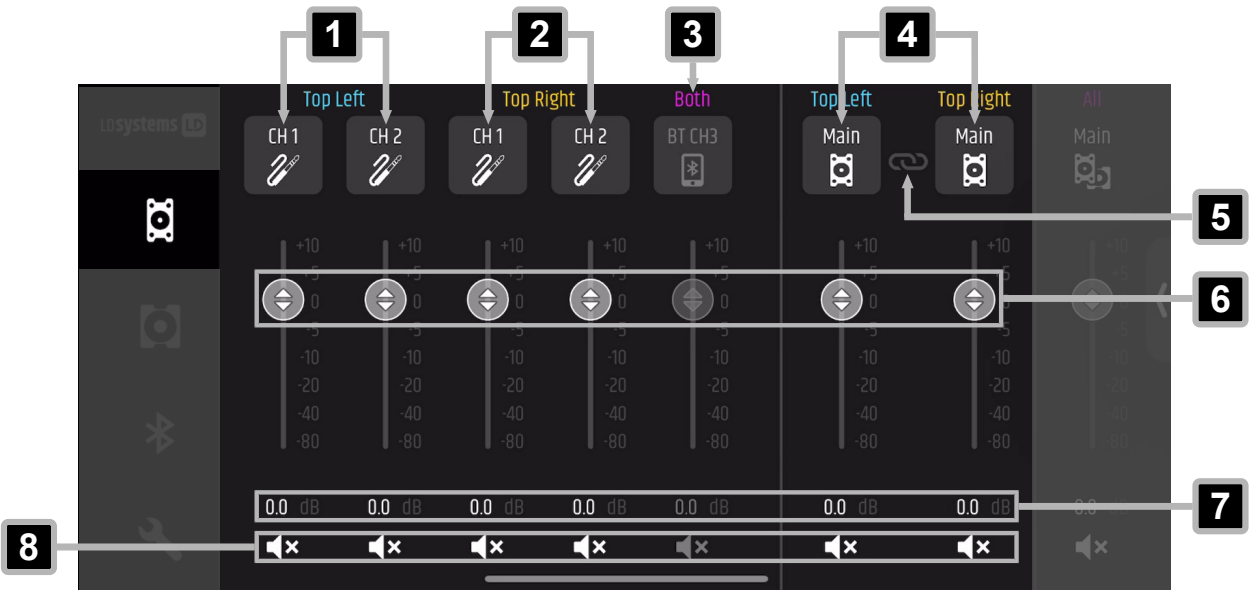

- 1** **Top Left** - Indicates the input channels of the **ICOA® PRO** configured as **Top Left**. Tap to open the channel settings.
- 2** **Top Right** - Indicates the input channels of the **ICOA® PRO** configured as **Top Right**. Tap to open the channel settings.
- 3** **Bluetooth®Channel** - Indicates the Bluetooth® channel. Tap to open the channel settings.
- 4** **Top Left / Top Right** - Indicates the main outputs for the **ICOA® PRO** configured as **Top Left / Top Right**. Tap to open the channel settings.
- 5** **Main Coupling** - Activates the main coupling for the main channels. When main coupling is active, the chain icon is highlighted white.
- 6** **Faders** - Adjust the volume of the corresponding channel (-80 dB...+10 dB)
- 7** **Fader Values** - Indicate the corresponding fader level in dB (-80 dB...+10 dB)
- 8** **Mute** - Toggles mute on / off

8.4.3.4

SCENES SECTION OVERVIEW

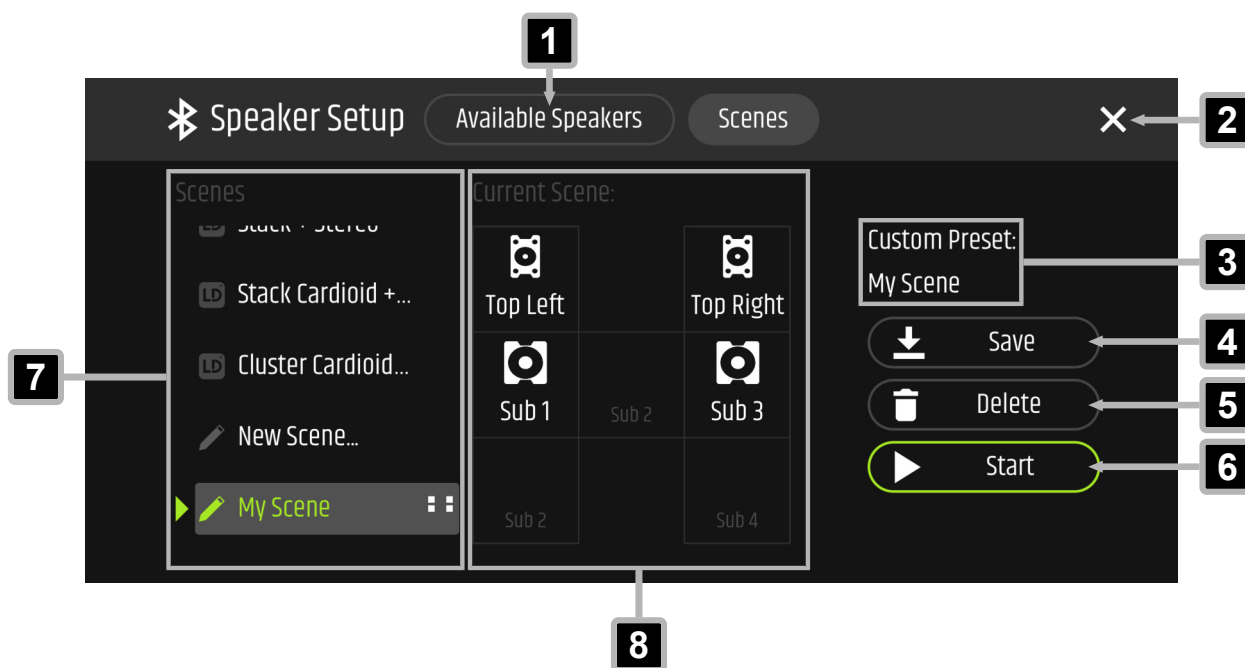

- 1** **Available Speakers** - Opens the **Available Speakers** section
- 2** **✕** - Closes the section
- 3** **Preset Information** - Indicates the name of the selected scene
- 4** **Save** - Saves the selected scene
- 5** **Delete** - Deletes the selected scene
- 6** **Start** - Activates the scene and deploys settings to connected loudspeakers
- 7** **Scenes** - List of available scenes. The white squares to the right of the selected scene name show the loudspeaker configuration for which the respective scene contains settings.
- 8** **Current Scene / Scene Preview** - Indicates the current configuration of the scene. Under **Scenes** **7**, select a scene to show a preview in this area.

8.4.3.5 AVAILABLE SPEAKERS SECTION OVERVIEW

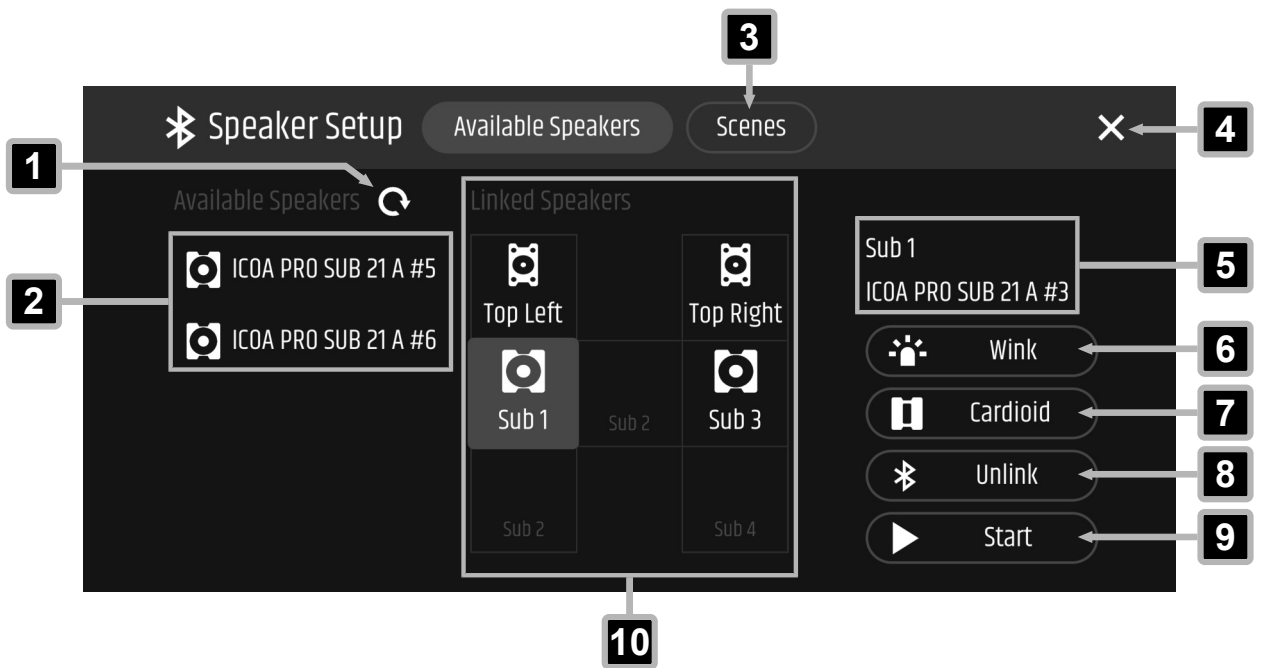

- 1** **Refresh** - Updates the list of available loudspeakers
- 2** **Available Speakers** - List of available loudspeakers
- 3** **Scenes** - Opens the scenes section
- 4** **X** - Closes the section
- 5** **Loudspeaker Information** - Indicates the grid position and the name of the selected loudspeaker
- 6** **Wink** - Flashes the front LED
- 7** **Cardioid** - Sets a selected subwoofer as cardioid subwoofer
- 8** **Unlink** - Cancels the link for the selected loudspeaker
- 9** **Start** - Deploys the settings to the selected loudspeakers and closes the section
- 10** **Linked Speakers Grid** - Indicates the linked loudspeakers on the respective grid position

8.4.3.6

MAIN EQ SECTION OVERVIEW

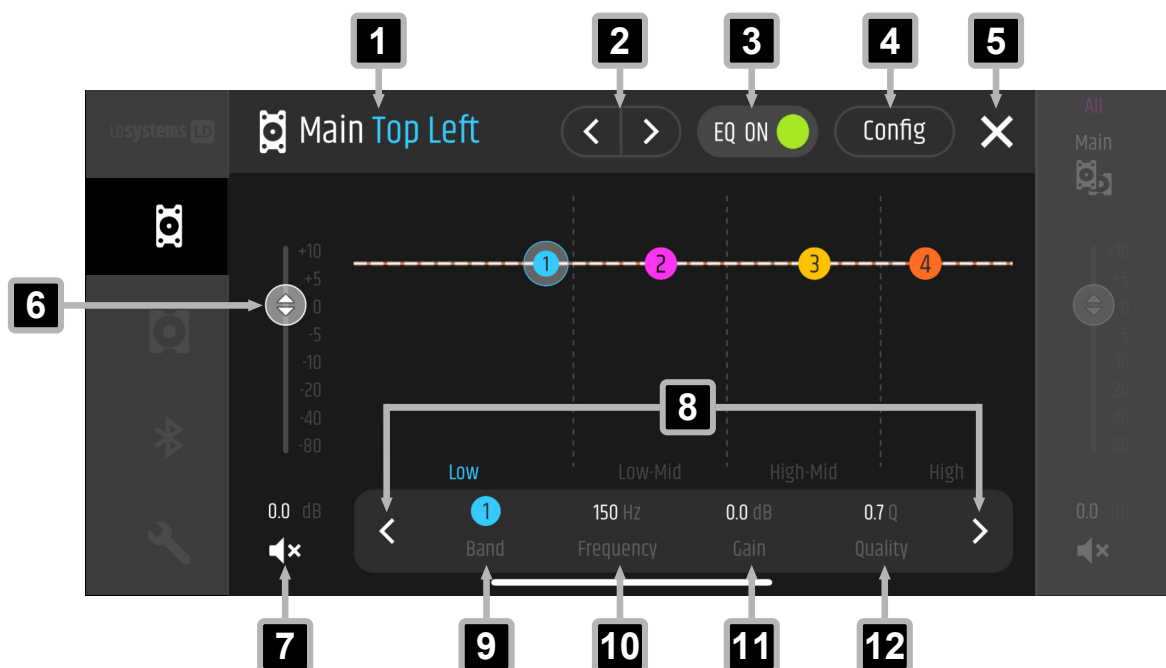

- 1** **Channel Name** - Indicates the input channel name of the selected channel
- 2** **Channel Selection** - Choose **<** or **>** to switch between channels
- 3** **EQ ON / EQ OFF** - Toggles the equaliser on / off
- 4** **Config** - Opens the configuration for the corresponding channel
- 5** **X** - Closes the section
- 6** **Channel Fader** - Adjusts the channel volume
- 7** **Mute** - Toggles mute on / off
- 8** **EQ Band Selection** - Choose **<** or **>** to switch between equaliser bands
- 9** **Band** - Indicates the selected equaliser band
- 10** **Frequency** - Indicates the set frequency for the respective equaliser band
- 11** **Gain** - Indicates the set gain for the respective equaliser band
- 12** **Quality** - Indicates the set quality for the respective equaliser band

8.4.3.7 CHANNEL EQ SECTION OVERVIEW

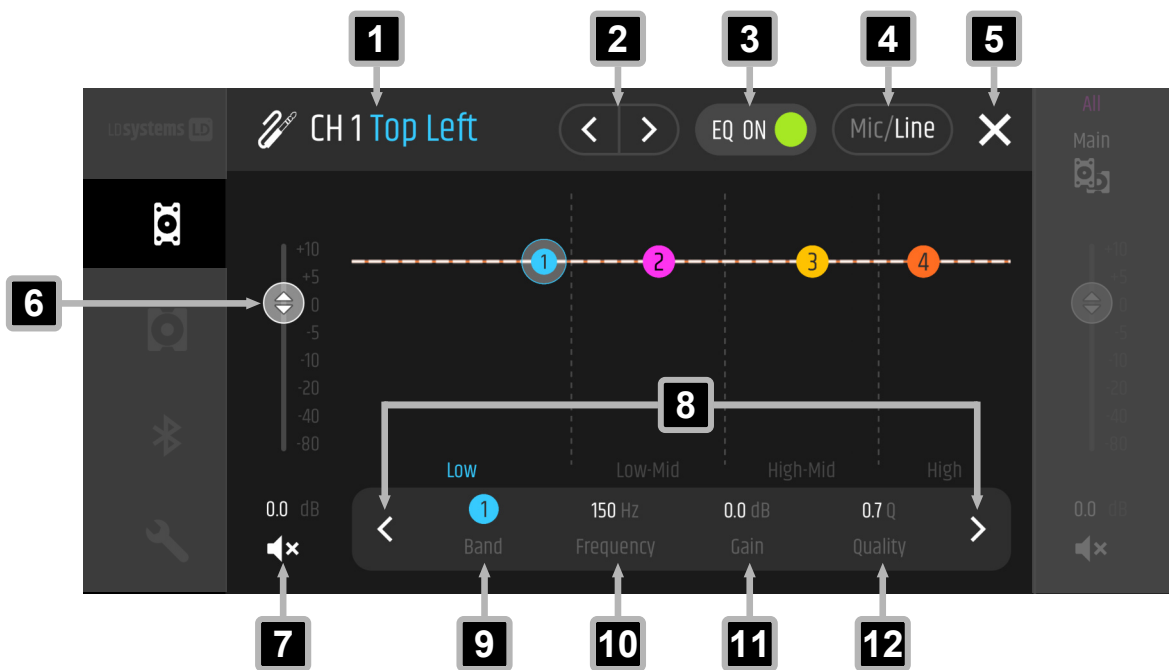

- 1** **Channel Name** - Indicates the input channel name of the selected channel
- 2** **Channel Selection** - Choose **<** or **>** to switch between channels
- 3** **EQ ON / EQ OFF** - Toggles the equaliser on / off
- 4** **Input type** - Toggles the input type (**Mic, Line**)
- 5** **X** - Closes the section
- 6** **Channel Fader** - Adjusts the channel volume
- 7** **Mute** - Toggles mute on / off
- 8** **EQ Band Selection** - Choose **<** or **>** to switch between equaliser bands
- 9** **Band** - Indicates the selected equaliser band
- 10** **Frequency** - Indicates the set frequency for the respective equaliser band
- 11** **Gain** - Indicates the set gain for the respective equaliser band
- 12** **Quality** - Indicates the set quality for the respective equaliser band

8.4.3.8

MAIN CONFIG SECTION OVERVIEW

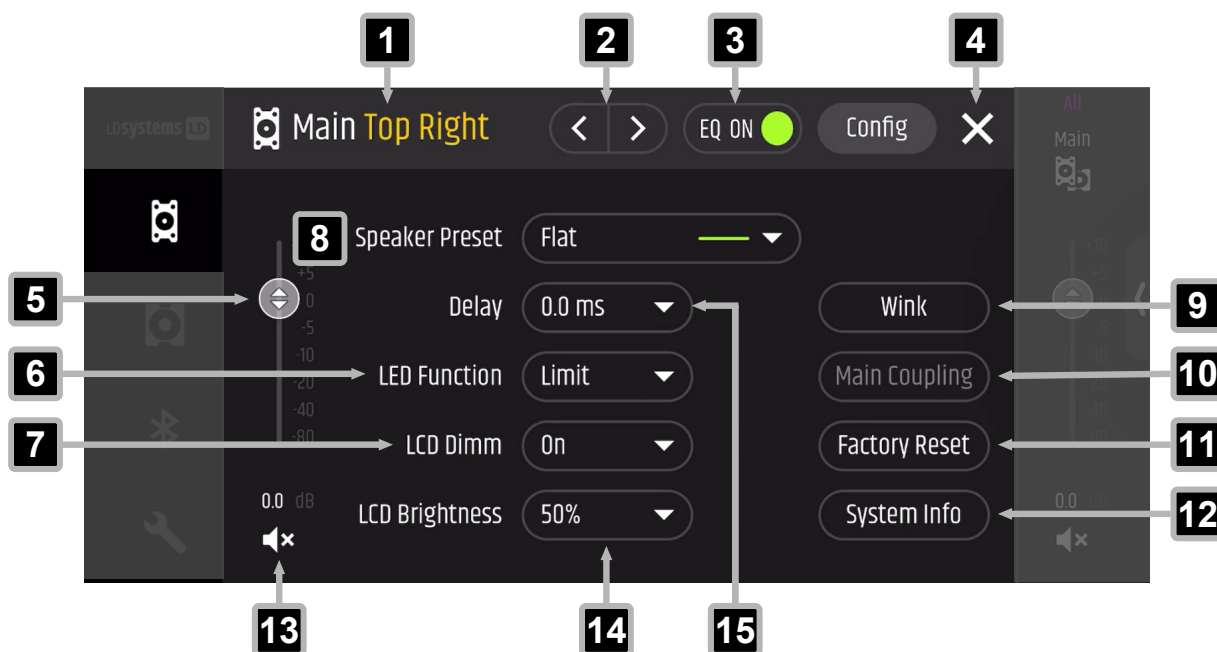

- 1** **Main Channel Name** - Indicates the selected main channel
- 2** **Channel Selection** - Choose **<** or **>** to switch between channels
- 3** **EQ ON / EQ OFF** - Toggles the equaliser on / off
- 4** **✕** - Closes the section
- 5** **Main Channel Fader** - Adjusts the volume of the selected main channel (-80 dB...+10 dB)
- 6** **LED Function** - Sets the function for the front LED
- 7** **LCD Dimm** - Toggles the dimming function for the LCD display on / off. If the function is switched on, the display is dimmed after approximately 30 seconds of inactivity.
- 8** **Speaker Preset** - Selects the preset for the selected loudspeaker (**Full Range, Satellite, Monitor, Flat**)
- 9** **Wink** - Flashes the front LED
- 10** **Main Coupling** - Activates the coupling for the main channels
- 11** **Factory Reset** - Resets the selected **ICQA® PRO** to factory settings
- 12** **System Info** - Indicates information on your device, firmware and DSP version
- 13** **Mute** - Toggles mute on / off
- 14** **LCD Brightness** - Sets the brightness for the LCD display of the **ICQA® PRO** (50 %...100 %)
- 15** **Delay** - Adjusts the signal delay of the selected main channel (0.0 ms...147 ms)

8.4.3.9

SUBWOOFER CHANNELS OVERVIEW

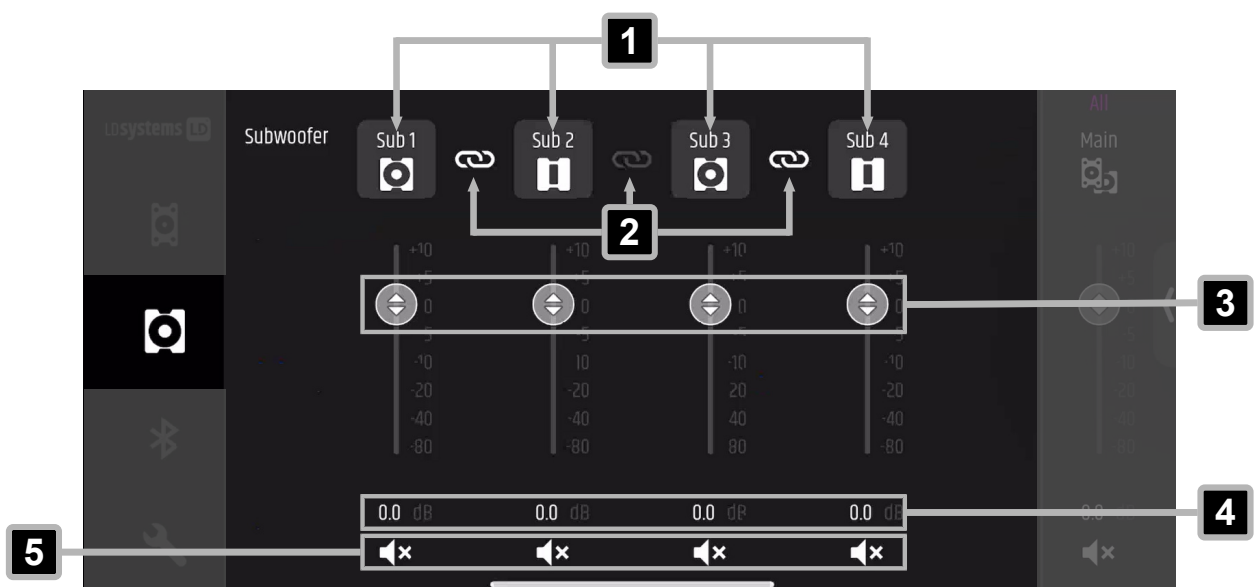

- 1** **Subwoofer Output Channels** - Indicates the output channels for the subwoofers. Tap to open the channel settings.
- 2** **Main Coupling** - Indicates the coupling status (White: Coupling is active, Grey: Coupling is not active)
- 3** **Faders** - Adjusts the volume for the corresponding subwoofer output channel
- 4** **Fader Value** - Indicates the fader level in dB (-80 dB...+10 dB)
- 5** **Mute** - Toggles mute on / off

8.4.3.10

SUBWOOFER CONFIG OVERVIEW

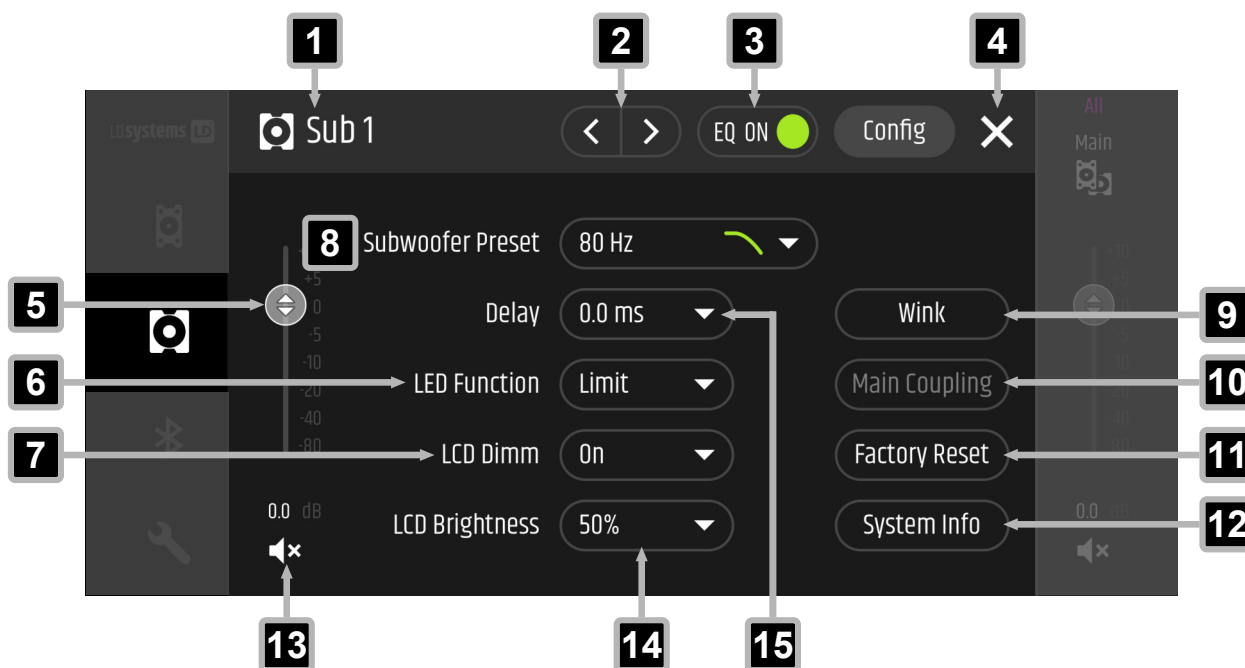

- 1** **Subwoofer Channel Name** - Indicates the selected subwoofer channel
- 2** **Channel Selection** - Choose **<** or **>** to switch between channels
- 3** **EQ ON / EQ OFF** - Toggles the equaliser on / off
- 4** **✕** - Closes the section
- 5** **Sub Channel Fader** - Adjusts the volume of the selected subwoofer channel (-80 dB...+10 dB)
- 6** **LED Function** - Sets the function for the front LED
- 7** **LCD Dimm** - Toggles the dimming function for the LCD display on / off
- 8** **Subwoofer Preset** - Selects the preset for the selected subwoofer (**80 Hz highcut, 100 Hz highcut, 120 Hz highcut, Cardioid, 100 Hz Mon, Cardio Mon**)
- 9** **Wink** - Flashes the front LED
- 10** **Main Coupling** - Activates the coupling for the main channels
- 11** **Factory Reset** - Resets the selected **ICOA® PRO** to factory settings
- 12** **System Info** - Indicates information on your device, firmware and DSP version
- 13** **Mute** - Toggles mute on / off
- 14** **LCD Brightness** - Sets the brightness for the LCD display of the **ICOA® PRO** (50 %...100 %)
- 15** **Delay** - Adjusts the signal delay of the selected main channel (0.0 ms...147 ms)

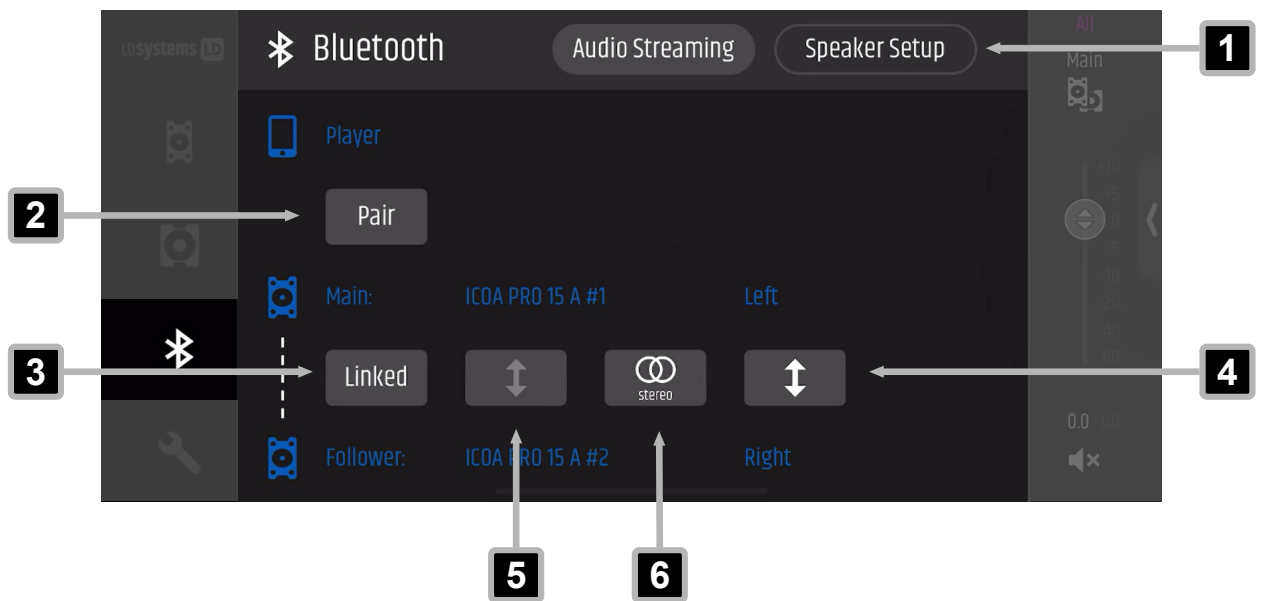

- 1** **Speaker Setup** - Opens the **Speaker Setup** section
- 2** **Pair** - Starts the Bluetooth® pairing process with a mobile device for audio streaming
- 3** **Linked** - Indicates the linking status between the **Main** loudspeaker and the **Follower** loudspeaker (**Link**, **Linking ...**, **Linked**)
- 4** **Swap Left / Right** - Swaps **Left** and **Right** between the **Main** and **Follower** loudspeaker
- 5** **Swap Speakers** - Swaps the linked loudspeakers between **Main** and **Follower** position
- 6** **Mono / Stereo** - Toggles between stereo and mono configuration

8.4.3.12

SETTINGS SECTION OVERVIEW



- 1** **ICQA® PRO Remote App - Version** - Indicates the version of your **ICQA® PRO** app
- 2** **Firmware Update** - Opens the **Firmware Update** section
- 3** **Support Manual** - Opens the **ICQA® PRO** user manual in the browser of your device
- 4** **Privacy Policy** - Opens the privacy policy in the browser of your device
- 5** **Scenes** - Opens the scenes section

8.4.4

USING THE APP SPEAKER SETUP

8.4.4.1

OPENING THE APP SPEAKER SETUP

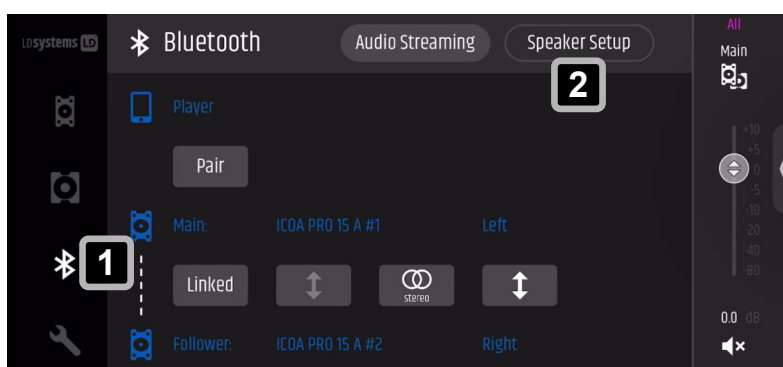

- 1** In the Bluetooth® section **1**, tap on **Speaker Setup** **2**.
⇒ The **Speaker Setup** screen appears.

8.4.4.2 LINKING A LOUDSPEAKER

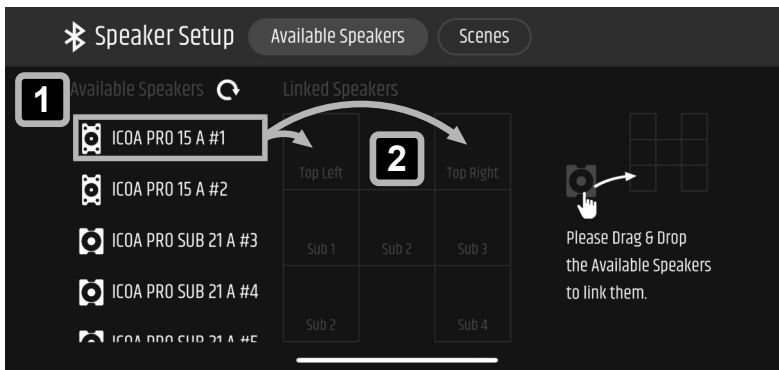

✓ Bluetooth® is switched on on your mobile device.

- 1 Tap and hold the corresponding device **1** to select it.
- 2 Drag and drop the selected device from the **Available Speakers** area to the respective **Linked Speakers** grid position **2**.

⇒ The loudspeaker is linked to the respective position.

 You can only drag and drop tops to the **Top Left** or **Top Right** grid position and subwoofers to any **Sub** grid position.

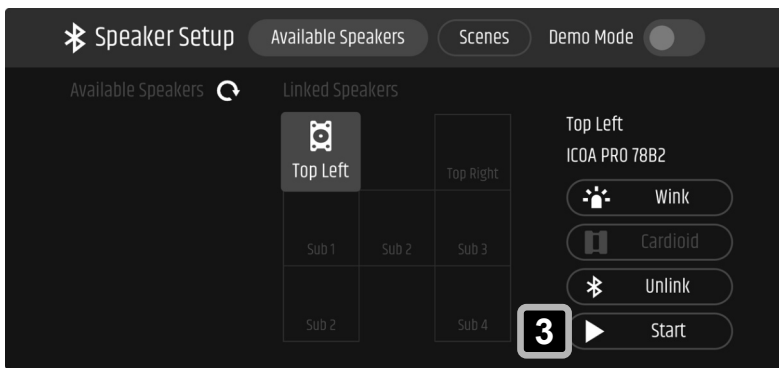

✓ You have linked at least one loudspeaker to a grid position.

- 3 Tap on **Start** **3** to confirm and close the **Speaker Setup**.

8.4.4.3 UNLINKING A LOUDSPEAKER

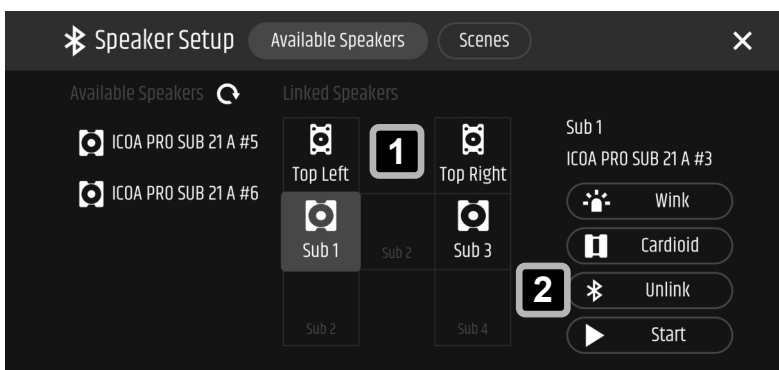

- 1 Tap on the respective loudspeaker in the grid of the **Linked Speakers** area **1**.
- 2 Tap on **Unlink**. **2**

⇒ The loudspeaker is unlinked from the respective grid position.

8.4.5 USING THE EQUALISER (EQ)

Find instructions below for operating the equaliser using an input channel from the **ICOA® PRO** series.



The software layout in the app differs slightly for main channels and subwoofer channels.

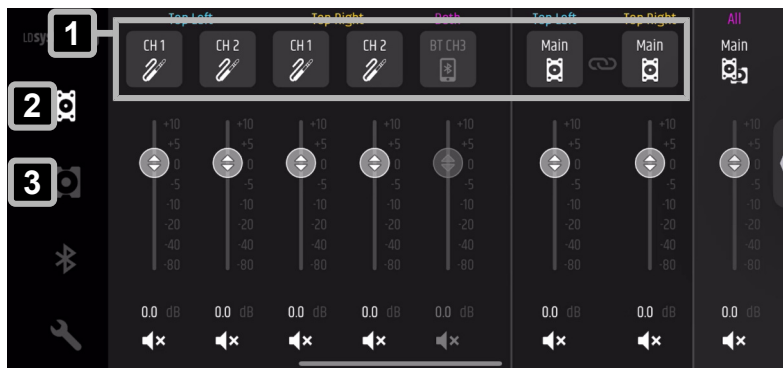

- 1 Tap on any channel **1** in the main section **2** or the subwoofer section **3** to open the equaliser.

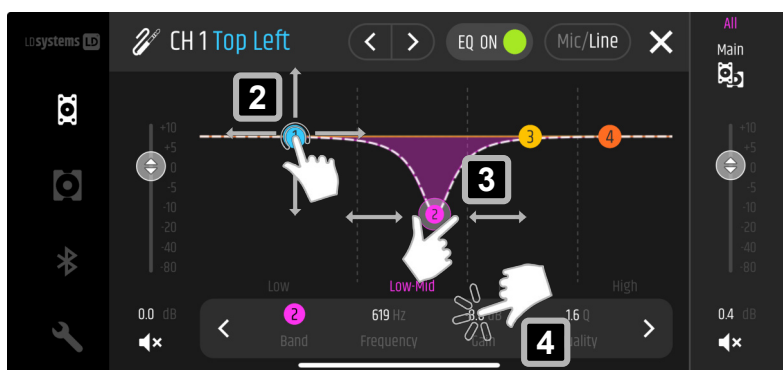

Tap **<** or **>** to navigate between channels.

- 2 Tap and hold the respective frequency band **2**:
 - a) Move left or right to select the frequency.
 - b) Move up or down to boost or cut the frequency.

- 3 Drag the frequency band to the needed position.

- 4 Pinch in or out to adjust the Q-factor. **3**



Tap on **Frequency, Gain** or **Quality** **4** to enter the values using the virtual keyboard.

8.5 TRUE WIRELESS STEREO (TWS)

8.5.1 ABOUT TRUE WIRELESS STEREO (TWS)

True Wireless Stereo (TWS) is a Bluetooth®-based technology. It is used to connect wireless audio devices with each other providing high sound quality and stereo playback capabilities.

 For TWS linking use only **ICOA® PRO** devices with the same loudspeaker size (12" or 15").

 The **(M)** next to the name of the first **ICOA® PRO** indicates that this device is the **Main** device. The **(F)** next to the name of the second **ICOA® PRO** indicates that this device is a **Follower**.

 While using TWS, you can only pair Bluetooth® audio playback devices to your **Main ICOA® PRO**, not to the **Follower ICOA® PRO**.

8.5.2 TRUE WIRELESS STEREO (TWS) ON THE DEVICE

8.5.2.1 OPENING THE BLUETOOTH® MENU ON THE DEVICE

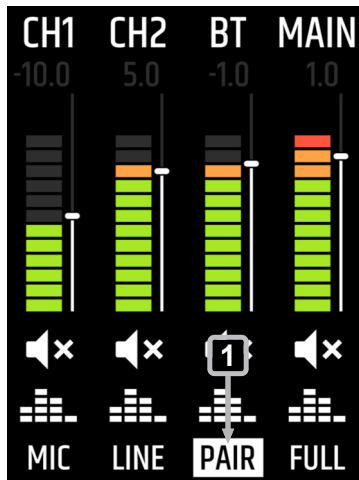

- 1 In the **ICOA® PRO** main screen, turn the **rotary-push encoder (RPE)** until **PAIR 1** is highlighted.
- 2 Push the **RPE**.
⇒ The **Bluetooth®** menu appears.

8.5.2.2 PREPARING THE ICOA® PRO AS MAIN (M) DEVICE FOR LINKING

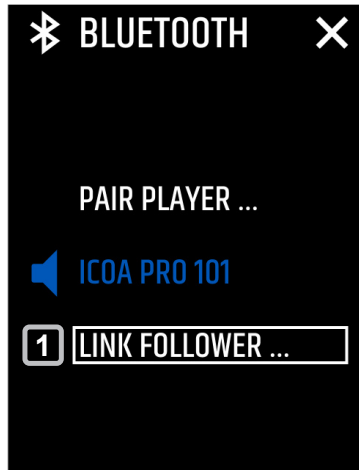

- 1 In the Bluetooth® menu, turn the **rotary-push encoder (RPE)** until **LINK FOLLOWER ...** is highlighted. **1**
- 2 Push the **RPE** to access the linking menu.

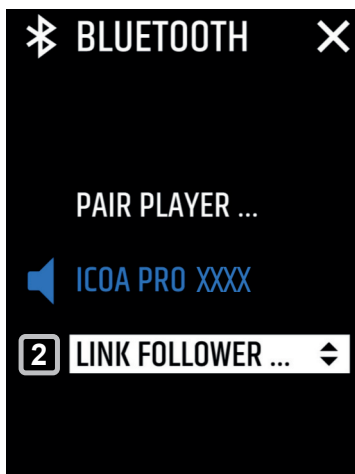

- 3 If necessary, turn the **RPE** to select **Link Follower ...** **2**.
- 4 Push the **RPE** to start the linking process.

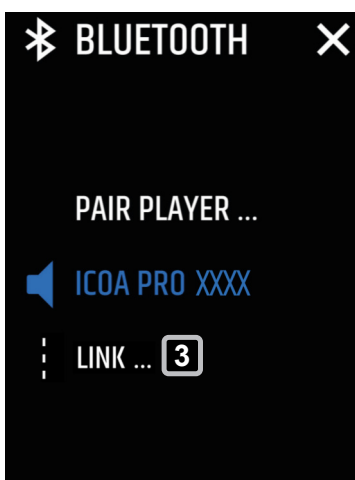

⇒ **Link ...** **3** is indicated and a second **ICOA® PRO** can be linked as follower.



After starting the linking process, it will remain active for approximately 1 minute.

8.5.2.3 LINKING A SECOND ICOA® PRO AS FOLLOWER (F) DEVICE

- ✓ Two **ICOA® PRO** are switched on and accessible via True Wireless Stereo (TWS).
- ✓ You have started the linking process with **LINK FOLLOWER ...** on another **ICOA® PRO**.

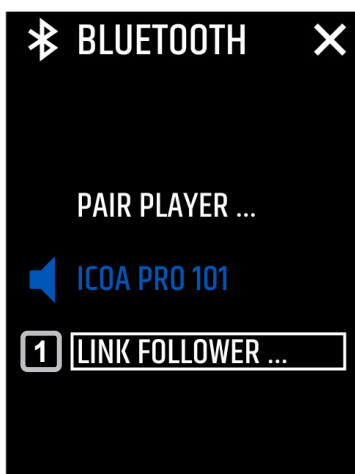

- 1 In the Bluetooth® menu, turn the **rotary-push encoder (RPE)** until **LINK FOLLOWER ...** **1** is highlighted.
- 2 Push the **RPE** to access the linking menu.

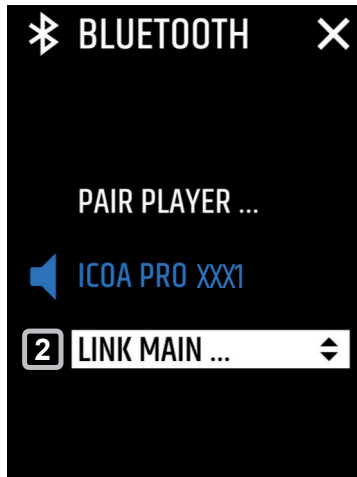

- 3 Turn the **RPE** until **LINK MAIN ...** is highlighted. **2**
- 4 Push the **RPE** to start the linking process.

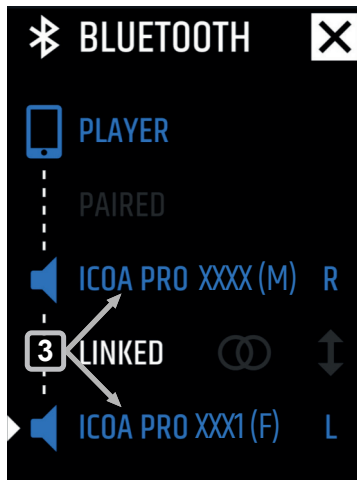

⇒ After a successful linking process, the **ICOA® PRO (F)** shows up on the **ICOA® PRO (M)** and vice versa. **3**

8.5.2.4 UNLINKING THE ICOA® PRO ON THE DEVICE

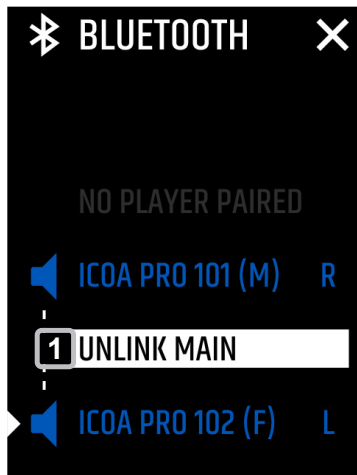

✓ You have linked two **ICOA® PRO** via True Wireless Stereo (TWS).

- 1 In the Bluetooth® menu, turn the **rotary-push encoder (RPE)** until **UNLINK MAIN** or **UNLINK FOLLOWER** is highlighted. **1**
- 2 Push the **RPE** to unlink the **ICOA® PRO**.
⇒ The **ICOA® PRO** is unlinked.

8.5.2.5 SWAPPING LEFT AND RIGHT ON THE DEVICE

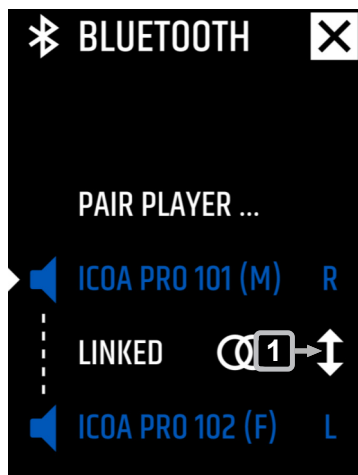

✓ You have linked two **ICOA® PRO** via True Wireless Stereo (TWS).

- 1 In the Bluetooth® menu, turn the **rotary-push encoder (RPE)** until the **↑** icon **1** is highlighted.
- 2 Push the **RPE** to swap between **L** and **R**.

See also:

Preparing the ICOA® PRO as Main (M) Device for Linking [▶ 52]

Linking a Second ICOA® PRO as Follower (F) Device [▶ 53]

8.5.2.6 TOGGLE BETWEEN MONO AND STEREO ON THE DEVICE

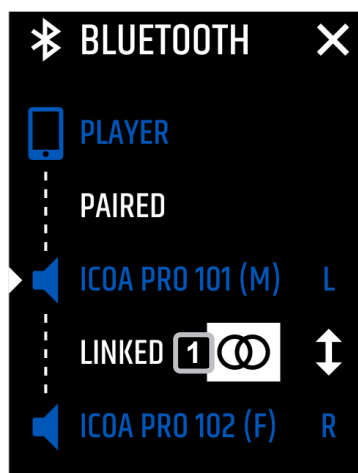

✓ You have linked two **ICOA® PRO** via True Wireless Stereo (TWS).

- 1 In the Bluetooth® menu, turn the **rotary-push encoder (RPE)** until Stereo **∞** or Mono **○** is highlighted. **1**
- 2 Push the **RPE** to toggle between Stereo **∞** or Mono **○**.

See also:

Preparing the ICOA® PRO as Main (M) Device for Linking [▶ 52]

Linking a Second ICOA® PRO as Follower (F) Device [▶ 53]

8.5.3 TRUE WIRELESS STEREO (TWS) IN THE APP

8.5.3.1 LINKING THE ICOA® PRO IN THE APP

✓ Two ICOA® PRO are switched on and accessible via True Wireless Stereo (TWS).

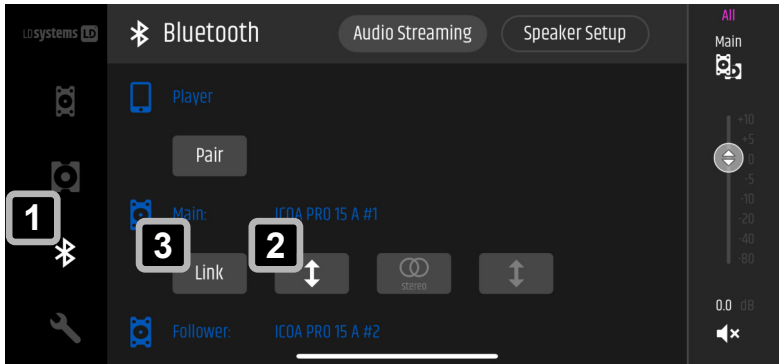

- 1 Open the Bluetooth® section. **1**
- 2 If required, tap the double arrow **2** to swap the devices between **Main** and **Follower**.
- 3 Tap on **Link** **3** to connect the ICOA® PRO devices.

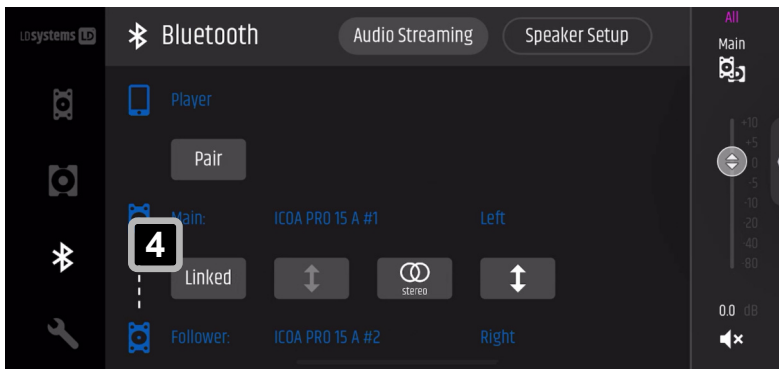

⇒ When the ICOA® PRO devices are linked, **Linked** appears **4**.

 First unlink the ICOA® PRO and repeat the linking process to subsequently swap both between **Main** and **Follower**.

8.5.3.2 UNLINKING THE ICOA® PRO IN THE APP

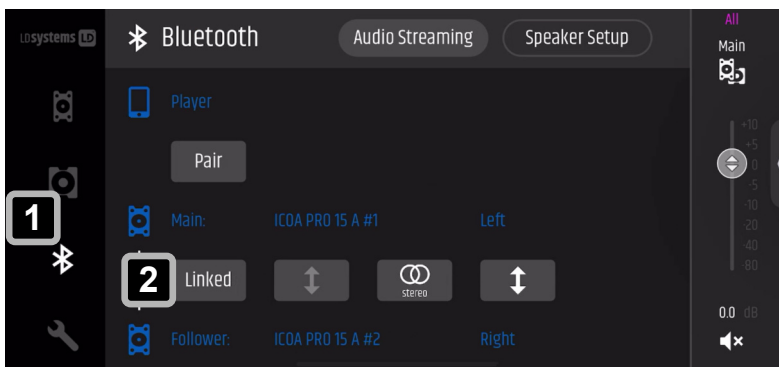

✓ You have linked two ICOA® PRO via True Wireless Stereo (TWS).

- 1 Open the Bluetooth® section. **1**
- 2 Tap on **Linked** **2** to unlink the ICOA® PRO devices.

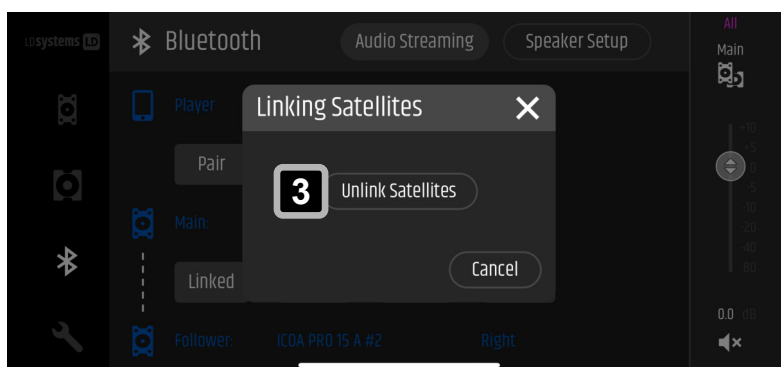

⇒ The dialogue **Linking Satellites** opens.

3 Tap on **Unlink Satellites** **3**.

⇒ When the **ICOA® PRO** devices are unlinked, **Link** appears **2**.

8.5.3.3 USING THE APP IN TRUE WIRELESS STEREO (TWS)



After a successful linking process, all channels of both **ICOA® PRO** devices are displayed and accessible in the **ICOA® PRO** app.



When linking two **ICOA® PRO** devices via True Wireless Stereo (TWS), the Bluetooth® inputs of both devices are combined into one.

See also:

Linking the **ICOA® PRO** in the App [▶ 56]

8.5.3.4 SWAPPING LEFT AND RIGHT IN THE APP

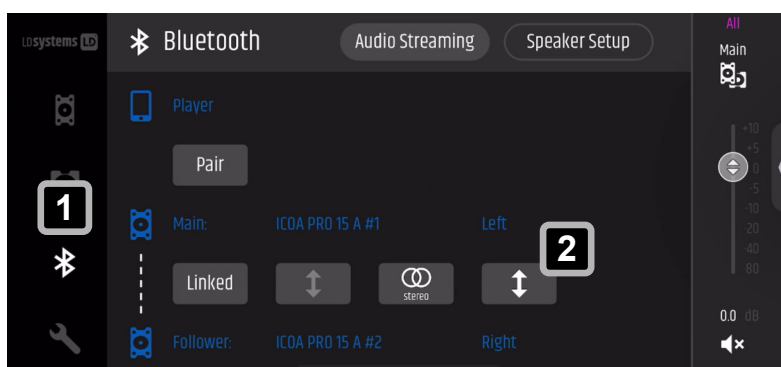

✓ You have linked two **ICOA® PRO** via True Wireless Stereo (TWS).

1 In the Bluetooth® section **1**, tap on **↑** **2** to swap **Left** and **Right**.

See also:

Linking the **ICOA® PRO** in the App [▶ 56]

8.5.3.5 TOGGLE BETWEEN MONO AND STEREO IN THE APP

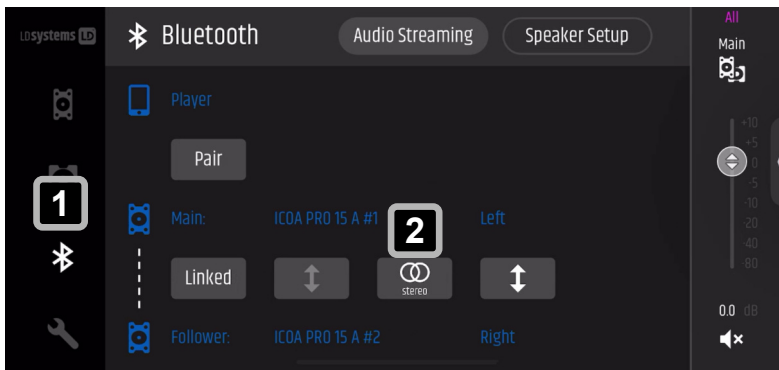

✓ You have linked two **ICOA® PRO** via True Wireless Stereo (TWS).

- 1 Tap on **Stereo** / **Mono** **2** to toggle between **Stereo** or **Mono** .
- ⇒ The currently active setting appears **2**.

See also:
Linking the ICOA® PRO in the App [▶ 56]

8.5.3.6 ACTIVATING AND DEACTIVATING MAIN COUPLING



✓ You have linked two **ICOA® PRO** devices via True Wireless Stereo (TWS).

- 1 In the main section **1**, tap on **2** to toggle main coupling on or off.
- ⇒ When activated, **1** is highlighted white.

If the settings for the **Main** channels are different, the values are overwritten from **Top Left** to **Top Right**.

See also:
Linking the ICOA® PRO in the App [▶ 56]

8.5.3.7 CHANGING THE MAIN COUPLING SETTINGS

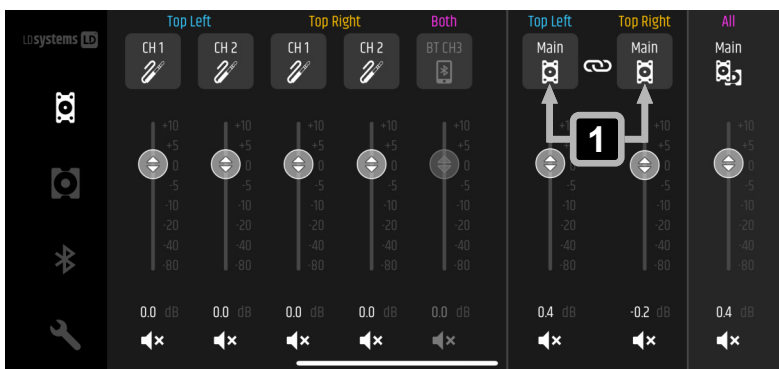

✓ You have linked two **ICOA® PRO** via True Wireless Stereo (TWS).

- 1 Tap on the respective **Main** channel **1**.

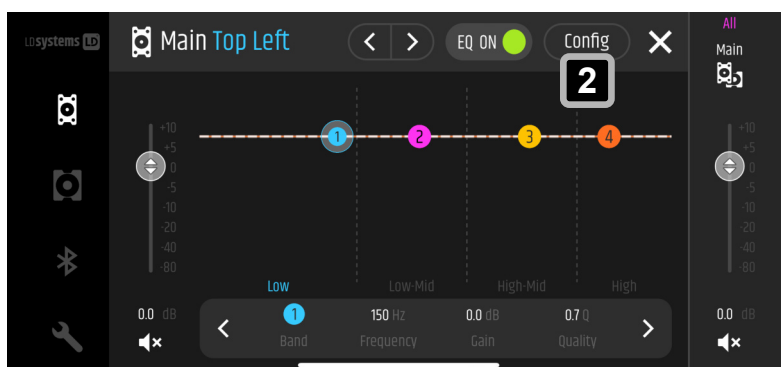

⇒ The **Main** channel EQ section opens.

2 Tap on **Config** **2**.

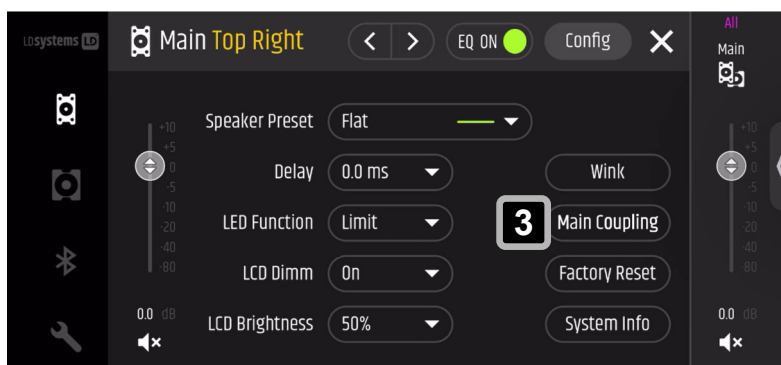

⇒ The **Main Config** section opens.

3 Tap on **Main Coupling** **3** to open the settings.

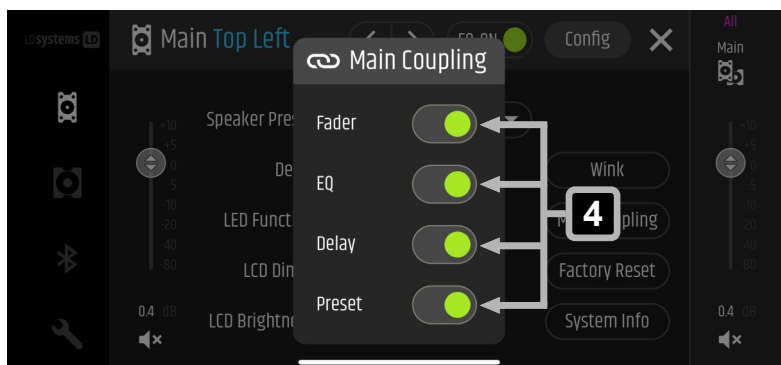

⇒ The **Main Coupling** settings dialogue opens.

4 Tap the switch buttons **4** to activate or deactivate the corresponding functions for **Main Coupling**.

⇒ The activated functions are now synchronised.

5 Tap outside of the dialogue to close the dialogue.

See also:
Linking the ICOA® PRO in the App [▶ 56]

8.6 INPUT CONNECTIONS

8.6.1 CONNECTING AN INPUT SOURCE TO THE MIC / LINE INPUT



CAUTION

High sound pressure levels

Risk of hearing damage

- a. Make sure that the main volume is turned all the way down, before you connect any input sources.



NOTICE

High Sound Pressure Level

Damage to the loudspeaker

- a. Connect line level devices, such as mixing consoles, to the line input only.



The **ICOA® PRO** does not support 48 V phantom power.



When using the mic level input, a lowcut filter (100 Hz) is applied to the channel.

✓ You have a 3-pin XLR cable.

- 1 Turn down the volume of the corresponding channel.

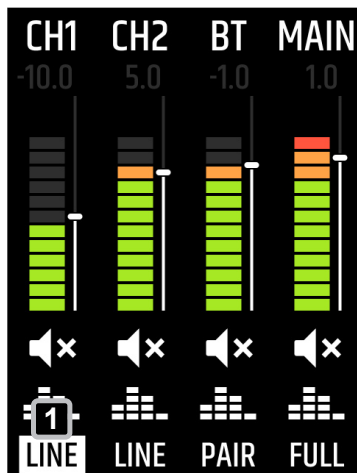

- 3 Connect a mic or line input source to **IN 1** or **IN 2**.
- 4 Turn up the volume of the corresponding channel.

- 2 Set the input to mic level or line level:
 - a) Turn the **rotary-push encoder (RPE)** until **MIC** or **LINE** in the corresponding channel is highlighted. **1**
 - b) Push the **RPE** to toggle the **MIC** or **LINE** input.

See also:

Adjusting the Channel Volume [▶ 64]

8.6.2 BLUETOOTH® FOR AUDIO PLAYBACK ON THE DEVICE

8.6.2.1 OPENING THE BLUETOOTH® MENU ON THE DEVICE

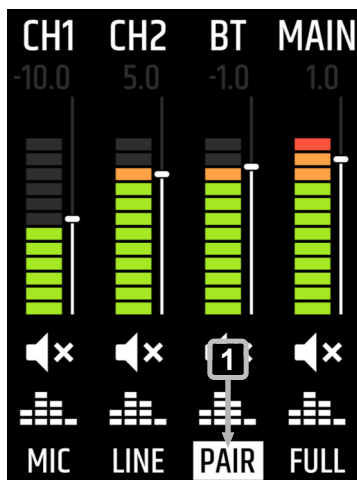

- 1 In the ICQA® PRO main screen, turn the **rotary-push encoder (RPE)** until **PAIR 1** is highlighted.
- 2 Push the **RPE**.
⇒ The **Bluetooth®** menu appears.

8.6.2.2 PAIRING A MOBILE DEVICE VIA BLUETOOTH® FOR AUDIO PLAYBACK

- ✓ You have a Bluetooth®-ready mobile device, such as a smartphone or tablet.

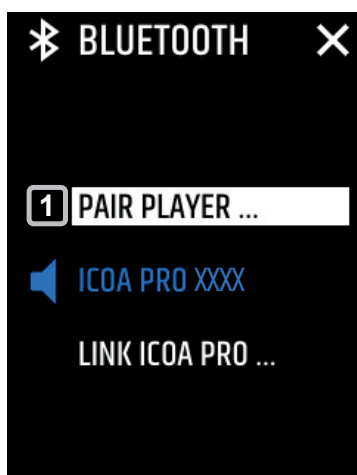

- 1 If necessary, turn the **rotary-push encoder (RPE)** until **PAIR PLAYER ...** is highlighted. **1**

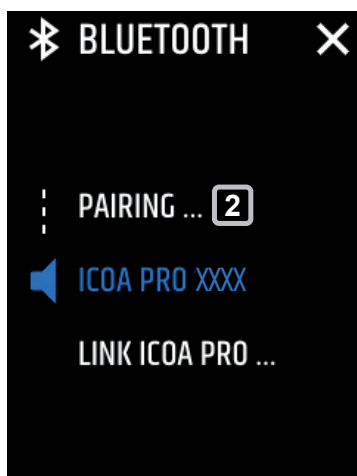

- 2 Push the **RPE** to start the pairing process.
⇒ **PAIRING ...** is indicated. **2**



After starting the pairing process, it will remain active for approximately 1 minute.

- 3 If necessary, turn on Bluetooth® on your mobile device.
- 4 On the Bluetooth® devices list of your mobile device, choose the **ICOA® PRO** to pair.

 The **ICOA® PRO** shows up as **ICOA® PRO XXXX**. The four digits represent the individual device ID.

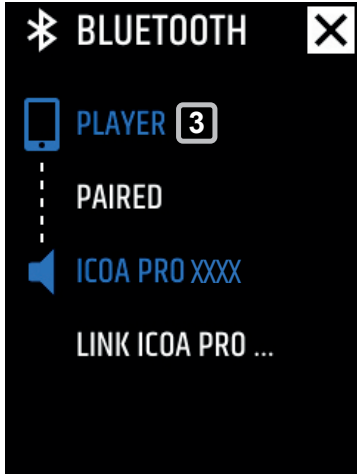

- ⇒ If the pairing process was successful, your mobile device shows up as **PLAYER 3**.
- ⇒ Your mobile device is paired and ready for audio playback.

 If your **ICOA® PRO** is already paired via Bluetooth®, it will not appear in the Bluetooth® menu of other mobile devices. Unpair the currently paired mobile device and repeat the pairing process to make the **ICOA® PRO** available for other devices.

8.6.2.3 UNPAIRING A BLUETOOTH® DEVICE

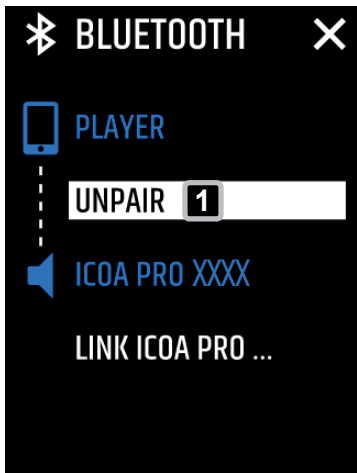

- ✓ You have a Bluetooth®-ready device paired to your **ICOA® PRO**.
- 1 Turn the **RPE** until **UNPAIR 1** is highlighted.
- 2 Push the **RPE**.
- ⇒ Your device is no longer paired with the **ICOA® PRO**.

8.6.3 BLUETOOTH® FOR AUDIO PLAYBACK IN THE APP

8.6.3.1 PAIRING A MOBILE DEVICE VIA BLUETOOTH®



You can use the same device as for controlling the app for audio playback. You still need to set up another Bluetooth® connection for this purpose on your mobile device.



After starting the pairing process, it will remain active for approximately 1 minute.

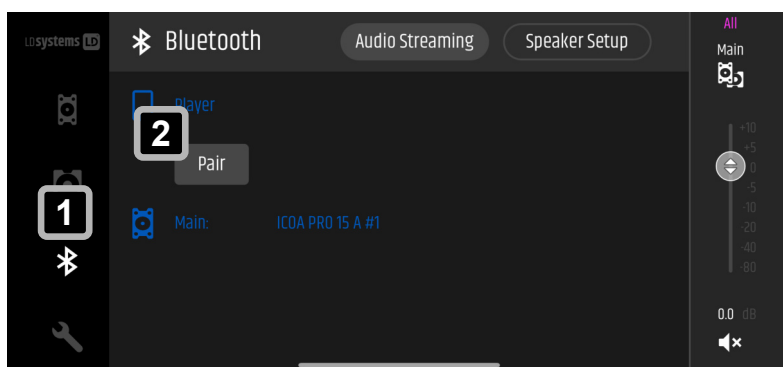

✓ You have a Bluetooth®-ready mobile device, such as a smartphone or tablet.

1 In the Bluetooth® section **1**, tap on **Pair** **2**.

⇒ **Pairing** appears. **3**

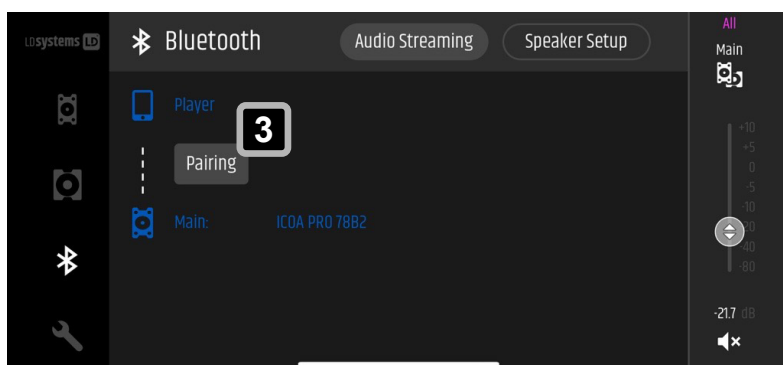

2 If necessary, turn on Bluetooth® on your mobile device.

3 On the Bluetooth® devices list of your mobile device, choose the **ICOA® PRO** to pair.



The **ICOA® PRO** shows up as **ICOA® PRO XXXX**. The four digits represent the individual device ID.

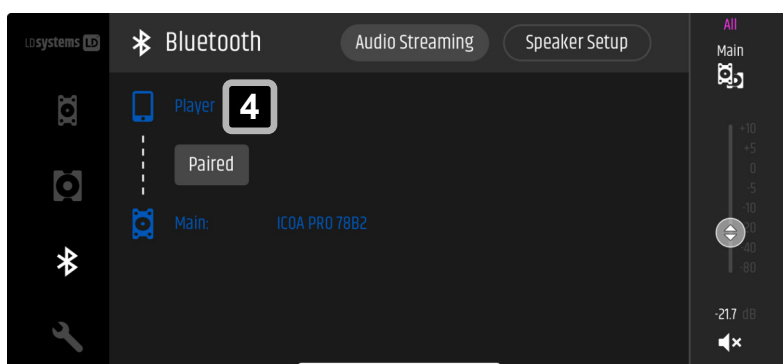

If the pairing process was successful, your mobile device shows up as **Player** **4**.



If your **ICOA® PRO** is already paired via Bluetooth®, it will not appear in the Bluetooth® menu of other mobile devices. Unpair the currently paired mobile device and repeat the pairing process to make the **ICOA® PRO** available for other devices.

8.6.3.2 UNPAIRING A MOBILE DEVICE VIA BLUETOOTH®

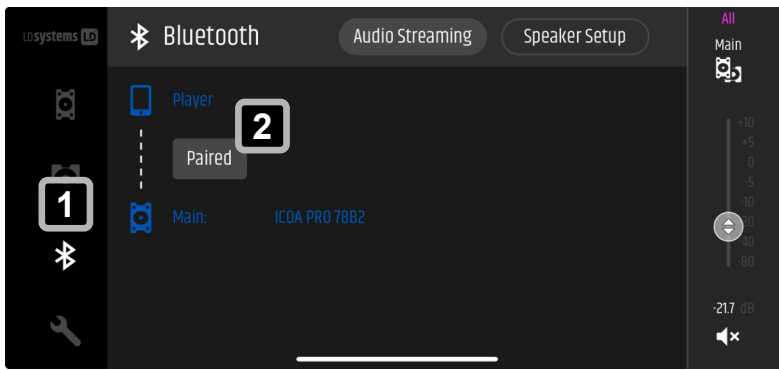

✓ You have a Bluetooth®-ready device paired to your **ICOA® PRO**.

- 1 In the Bluetooth® section **1**, tap on **Paired** **2**.
⇒ The **Connection Player** dialogue opens.

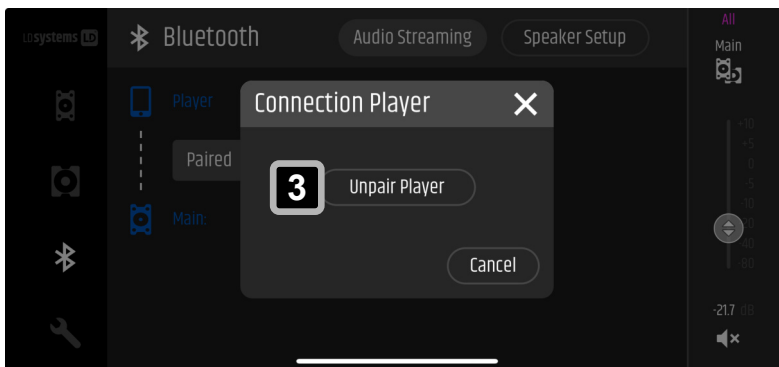

- 2 Tap on **Unpair Player**. **3**
⇒ Your device is no longer paired with the **ICOA® PRO**.

8.7 AUDIO PLAYBACK

8.7.1 ADJUSTING THE CHANNEL VOLUME

Find the procedure to adjust the channel volume for **CH1** below as an example. Proceed in the same way for **CH2** and the Bluetooth® (**BT**) channel.



The **ICOA® PRO** does not have a separate gain control. The preamp adjusts depending on the input source.

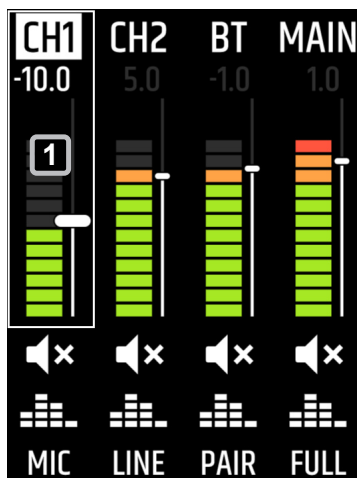

- 1 Turn the **rotary-push encoder (RPE)** until **CH1** is highlighted. **1**
- 2 Push the **RPE**.

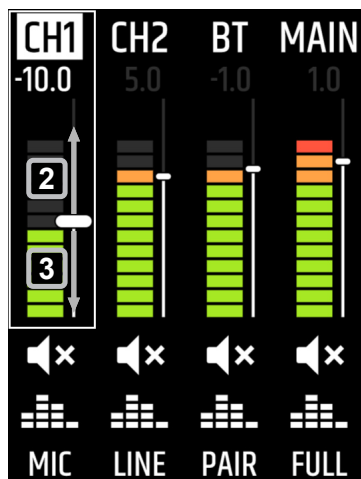

- 3 Turn the **RPE** clockwise to increase the input volume **2** and anticlockwise to decrease it **3**

8.7.2 ADJUSTING THE MAIN VOLUME

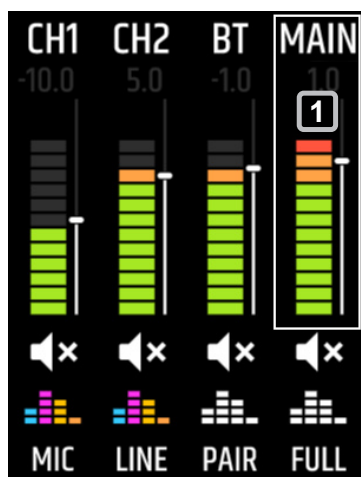

- 1 Turn the **rotary-push encoder (RPE)** until the **MAIN** channel is highlighted. **1**
- 2 Push the **RPE**.

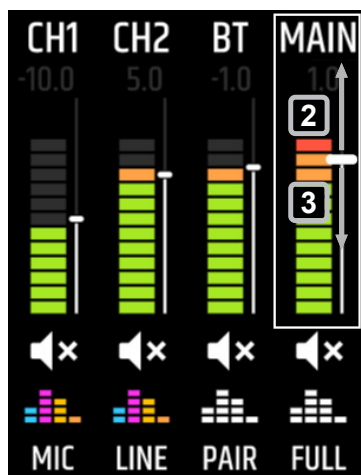

- 3 Turn the **RPE** clockwise to increase the output volume **2** and anticlockwise to decrease it **3**

8.8 MONITOR MODE

8.8.1 MONITOR MODE USE CASES

8.8.1.1 ABOUT MONITOR MODE USE CASES

In the following find typical use cases for the monitor mode.

 In addition you find corresponding screenshots showing the settings in the **ICOA® PRO** app.

8.8.1.2 FLOOR MONITOR

 This loudspeaker is designed for vertical and horizontal use. Rotate the horn for horizontal applications to adjust the dispersion.

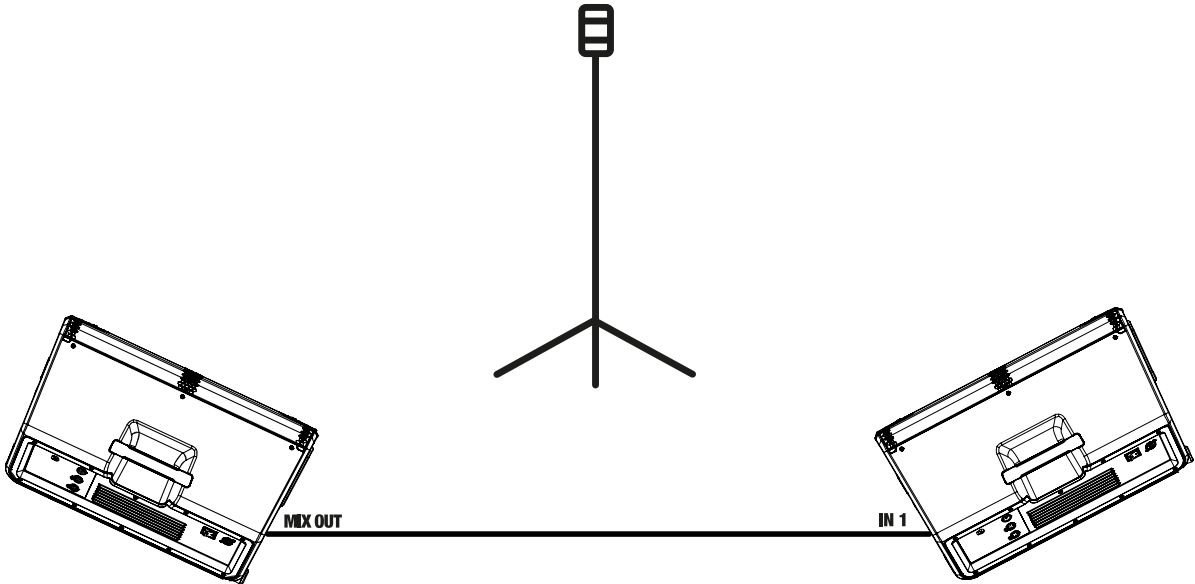
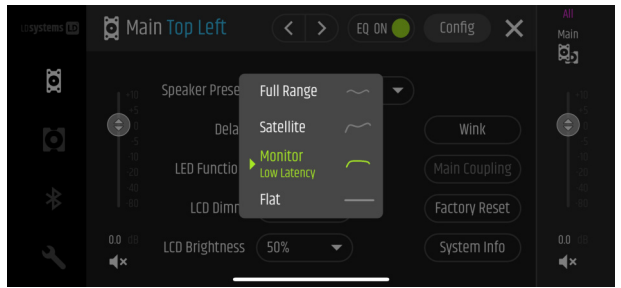
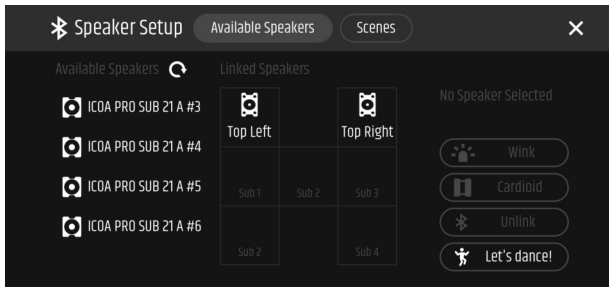

See also:
Rotating the Horn [▶ 68]

8.8.1.3

DRUM FILL / SIDE FILL

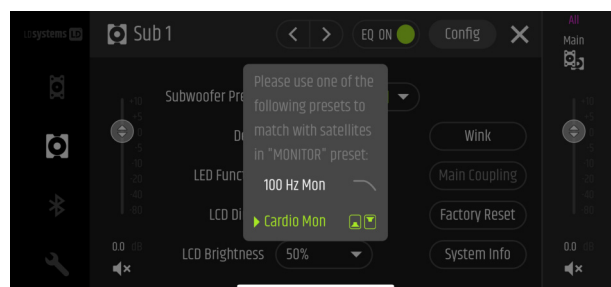
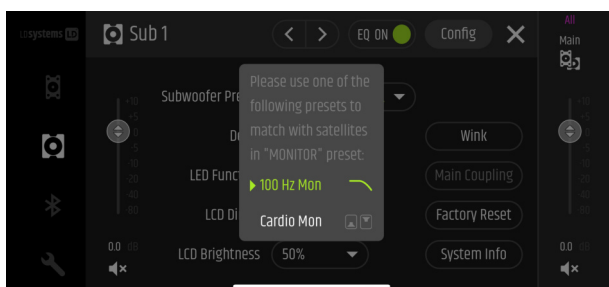
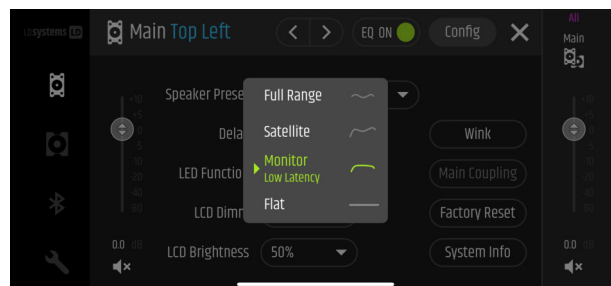
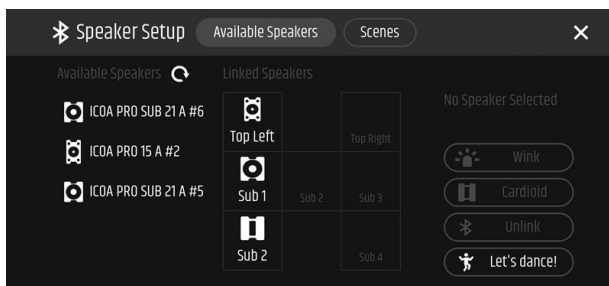

WARNING

Falling object

Risk of serious injury

Secure the devices against unintentional movements.

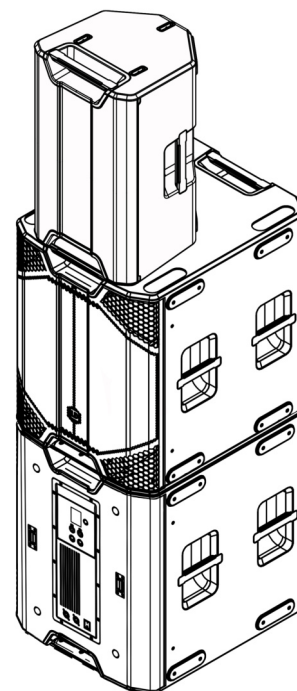
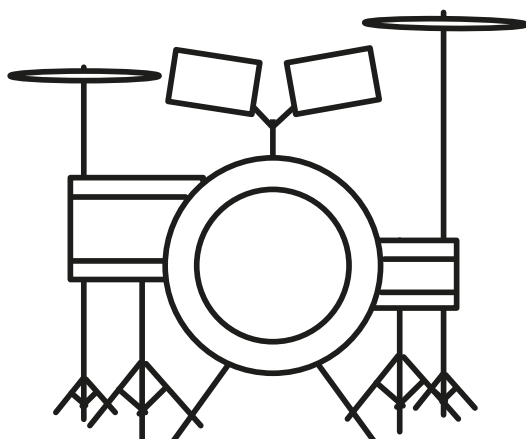

8.8.2 ROTATING THE HORN

8.8.2.1 TOOLS NEEDED

- Torx screwdriver T20 / T20 Torx bit

8.8.2.2 REMOVING THE FRONT GRILLE

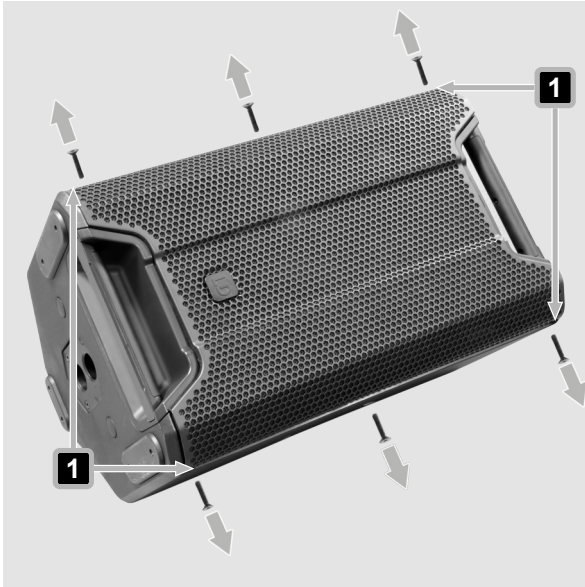

- ✓ Torx screwdriver T20 / T20 Torx bit

- 1 Remove the 6 screws of the front grille.
- 2 Use the recessed grips on both sides **1** to remove the front grille from the housing.

8.8.2.3 ROTATING THE HORN

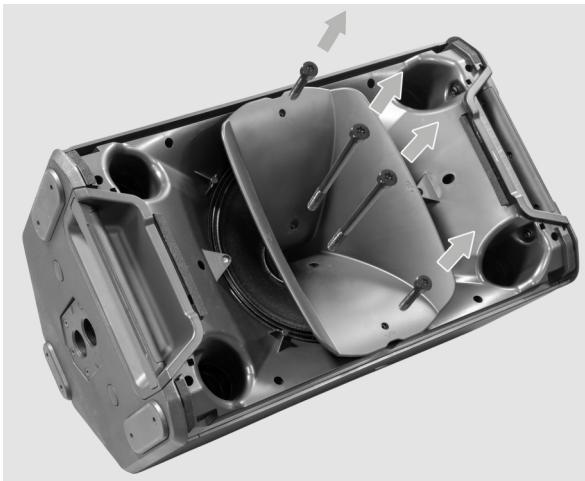

- ✓ You have removed the front grille from the housing.

- ✓ Torx screwdriver T20 / T20 Torx bit

- 1 Remove the 4 screws that hold the horn in place.

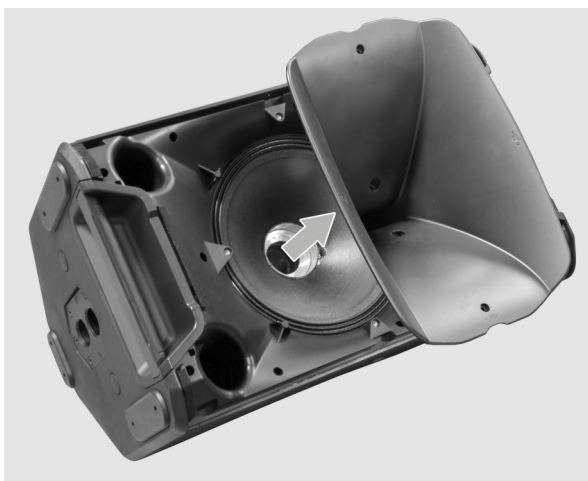

2 Lift the horn carefully.

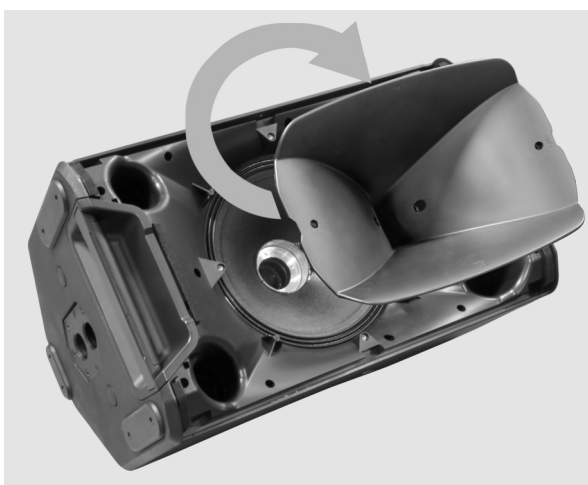

3 Rotate the horn 90°.

4 Carefully reinsert the horn into the recess.

5 Make sure that the horn is seated correctly.

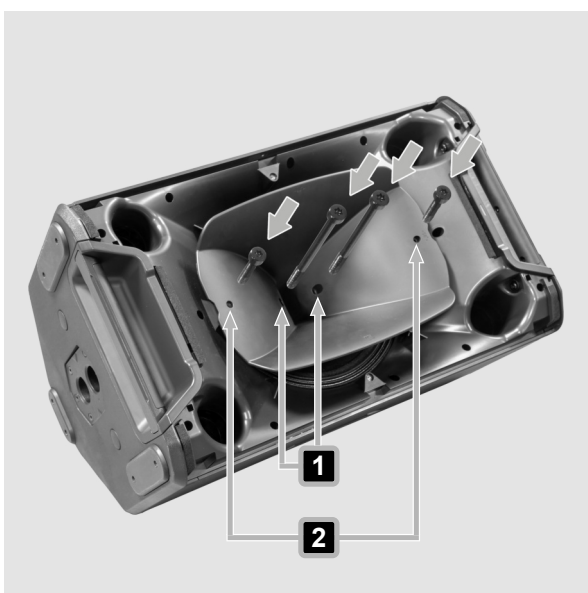

✓ The horn sits correctly in the recess.

6 Insert the 2 long screws into the inner holes **1**.

7 Insert the 2 short screws into the outer holes **2**.

8 Fasten the 4 screws.

8.8.2.4

ATTACHING THE FRONT GRILLE



✓ Torx screwdriver T20 / T20 Torx bit

- 1 Place the front grille on the housing.
- 2 Press the grill on all sides so that it sits correctly on the housing.
- 3 Fasten the 6 screws of the front grille.

8.8.2.5

ROTATING THE FRONT GRILLE LD LOGO

The LD logo is held in position by a spring. You can rotate the logo depending on the application.

- 1 Pull out the LD logo.
- 2 Rotate the LD logo 90°.
- 3 Let the LD logo retract.

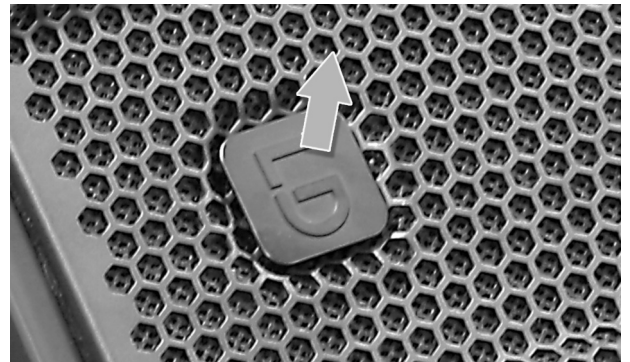

8.9 OUTPUT CONNECTIONS

8.9.1 LOADING A SPEAKER PRESET ON THE DEVICE

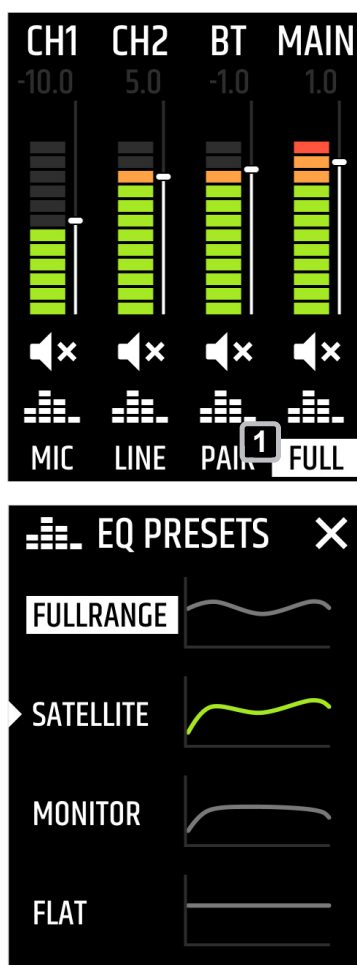

- 1 In the **ICOA® PRO** main screen, turn the **rotary-push encoder (RPE)** until the speaker preset is highlighted (**FULL, FLAT, MON, SAT**) **1**.
- 2 Push the **RPE**.

⇒ The **EQ PRESETS** screen appears.

- 3 Turn the **RPE** until the needed preset is highlighted.
- 4 Push the **RPE** to activate the corresponding preset.

⇒ The corresponding preset is applied to the output signal.

8.9.2 LOADING A SPEAKER PRESET IN THE APP



- 1 Tap on one of the **Main** channels **1**.

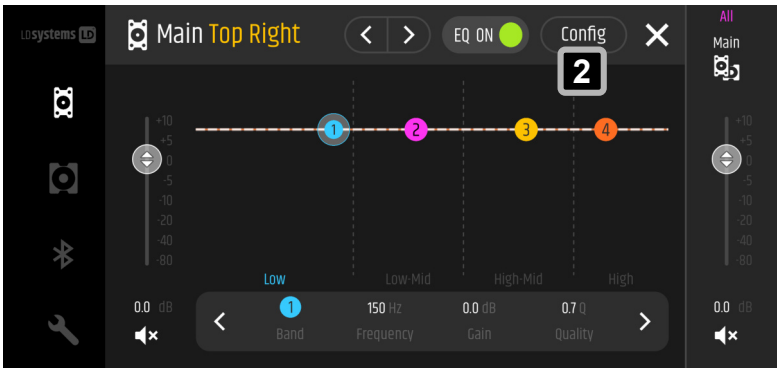

2 Tap on **Config** **2** to open the configuration.

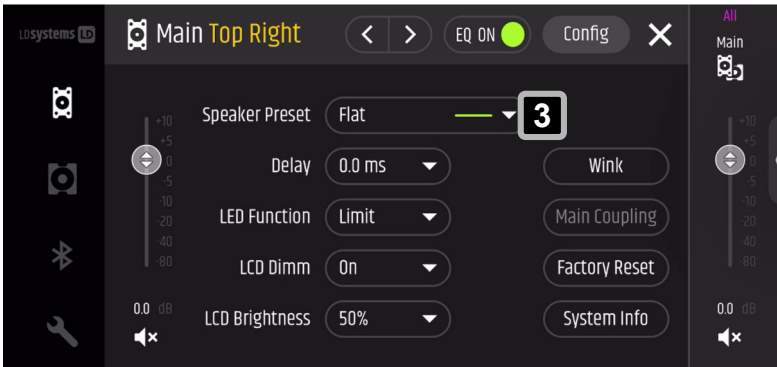

3 Tap on **Speaker Preset** **3** to open the preset menu.

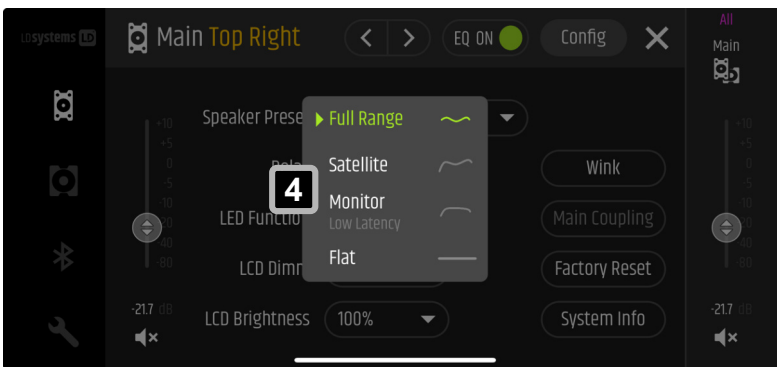

4 Select a loudspeaker preset from the menu **4**, such as **Full Range** or **Monitor**.

i With the **Monitor** preset, the **ICOA® PRO** operates in **Low Latency** mode.

8.9.3 CONNECTING AN ICOA® PRO SUBWOOFER VIA MIX OUT

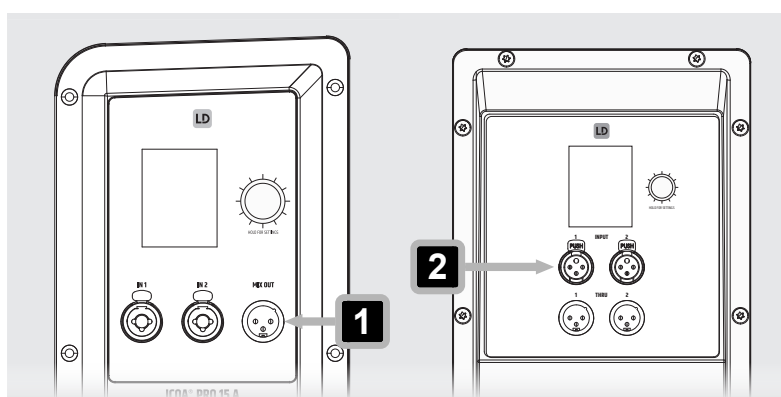

- 1 Connect the **ICOA® PRO MIX OUT 1** to the **ICOA® PRO subwoofer INPUT 1 2** using a 3-pin XLR cable.
 - ⇒ The **ICOA® PRO** subwoofer is fed by the **ICOA® PRO** prefade main mix.

8.9.3.1 CONNECTING ADDITIONAL ICOA® PRO SUBWOOFERS

- 1 Connect the **THRU 1** or **THRU 2** output of the first **ICOA® PRO** subwoofer to the **INPUT 1** or **INPUT 2** of the second unit using a 3-pin XLR cable.



The **THRU 1** output of the **ICOA® PRO** subwoofer provides the signal from **INPUT 1** only. The **THRU 2** output provides the signal from **INPUT 2** only.

8.10 LOUDSPEAKER SETUPS

8.10.1 ABOUT LOUDSPEAKER SETUPS

In the following find typical use cases for loudspeaker setups.

In addition you find a corresponding screenshot of the **Speaker Setup** in the **ICOA® PRO** app.

8.10.2 STEREO WITH 2 TOPS

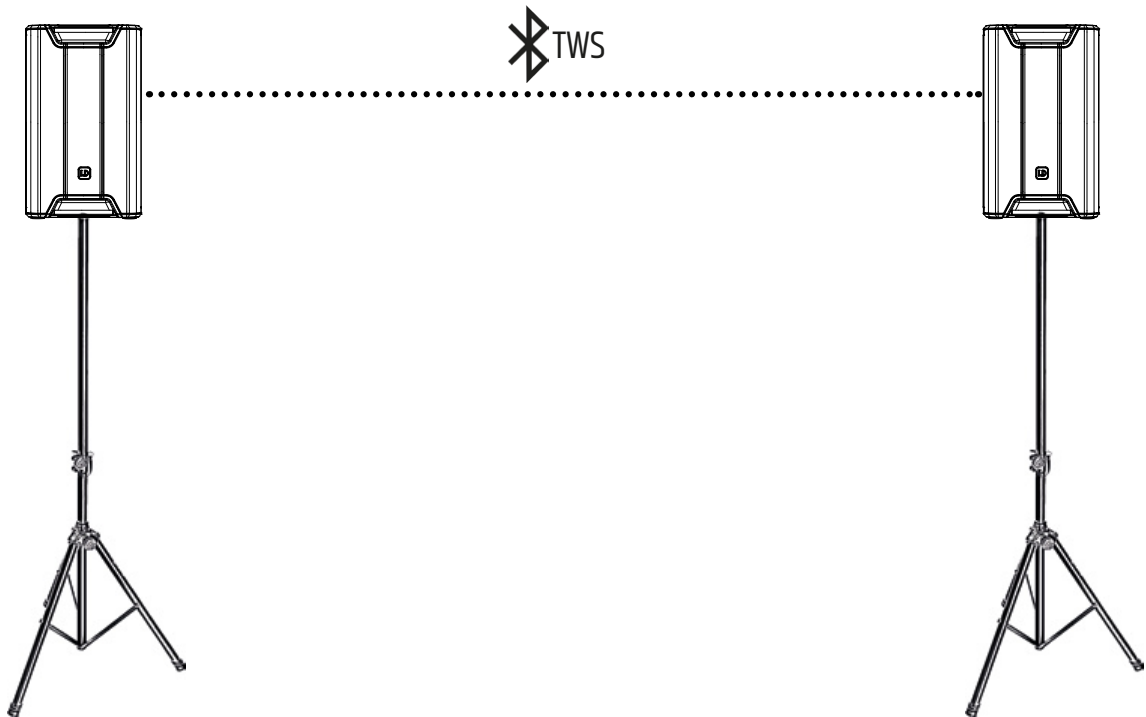
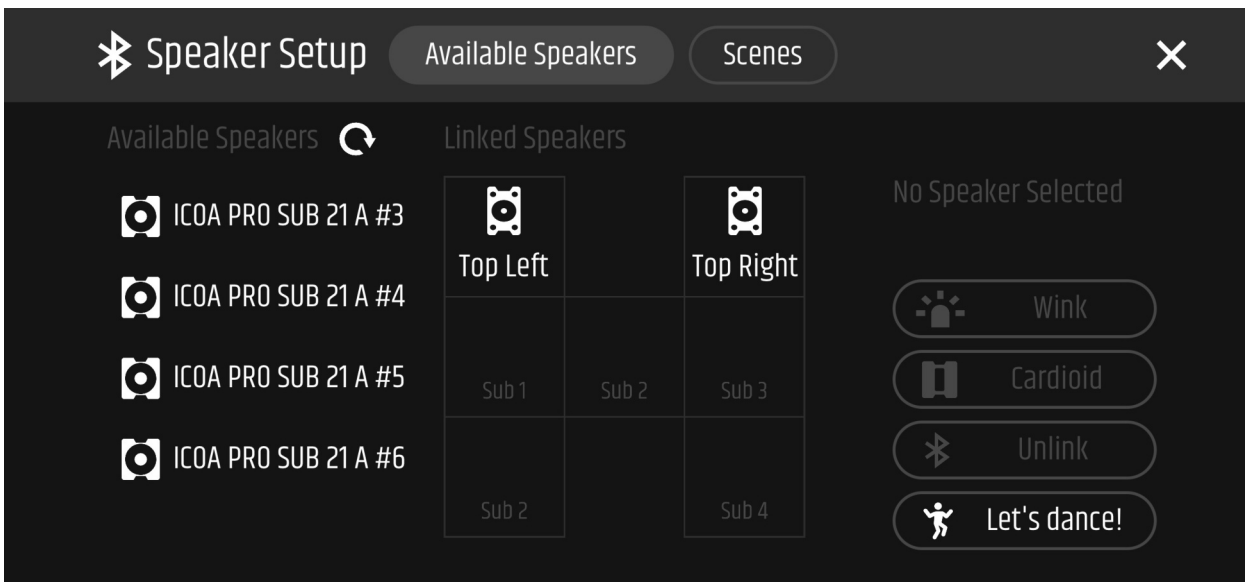

8.10.3 STEREO WITH 2 TOPS AND 2 SUBS

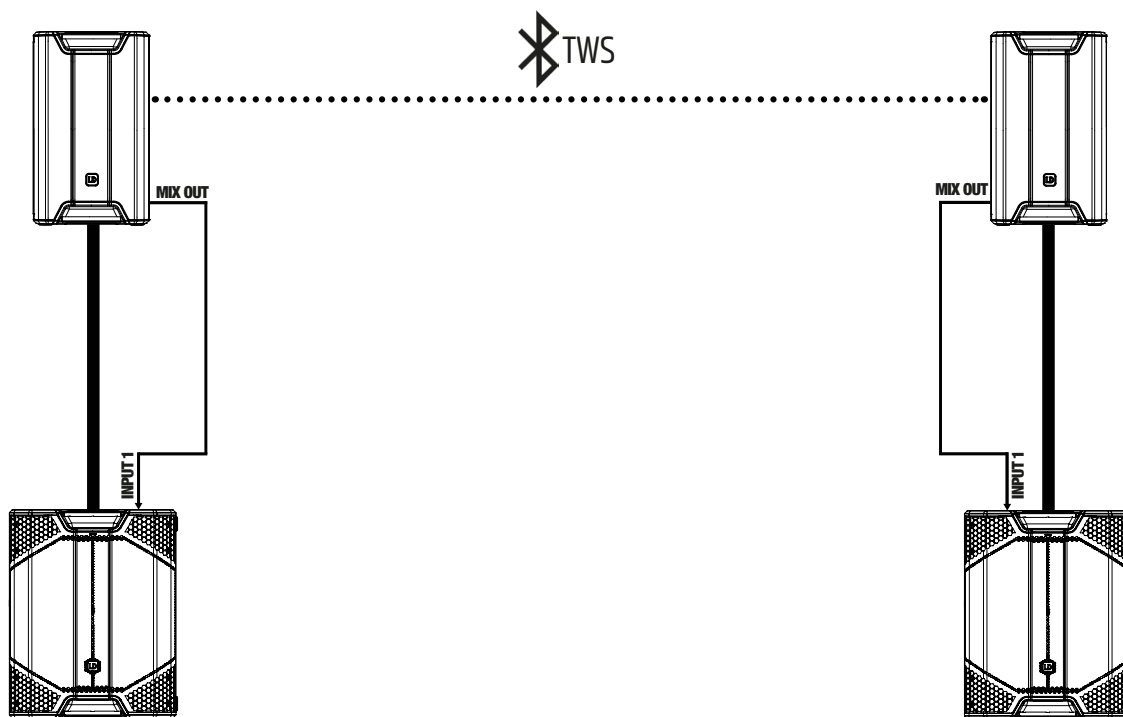
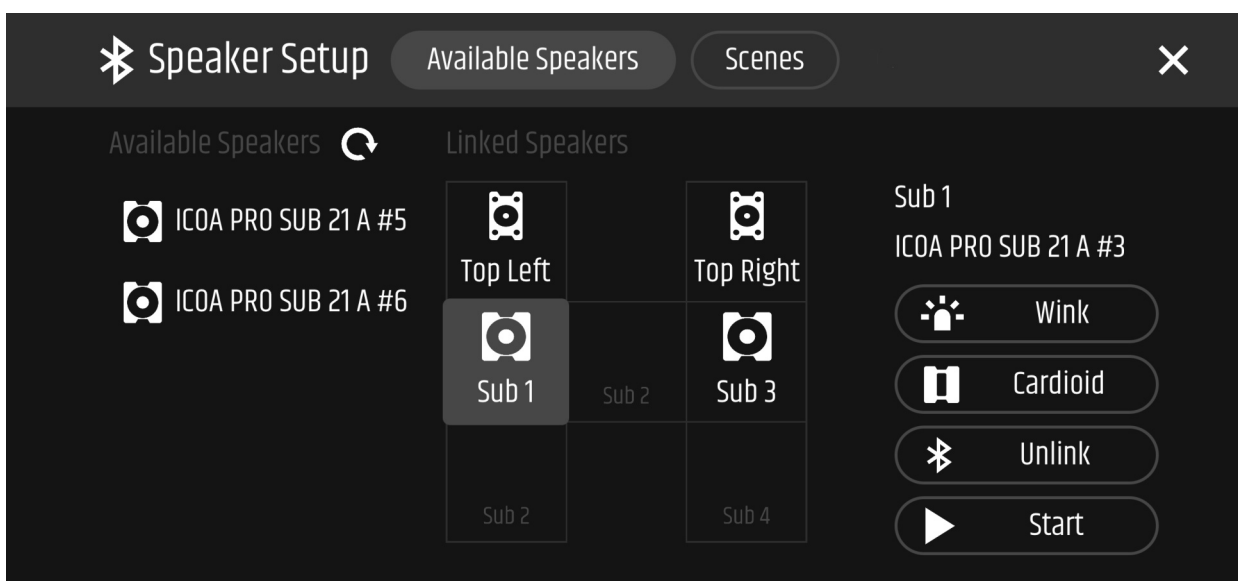

8.10.4 STEREO WITH 2 TOPS AND 4 SUBS

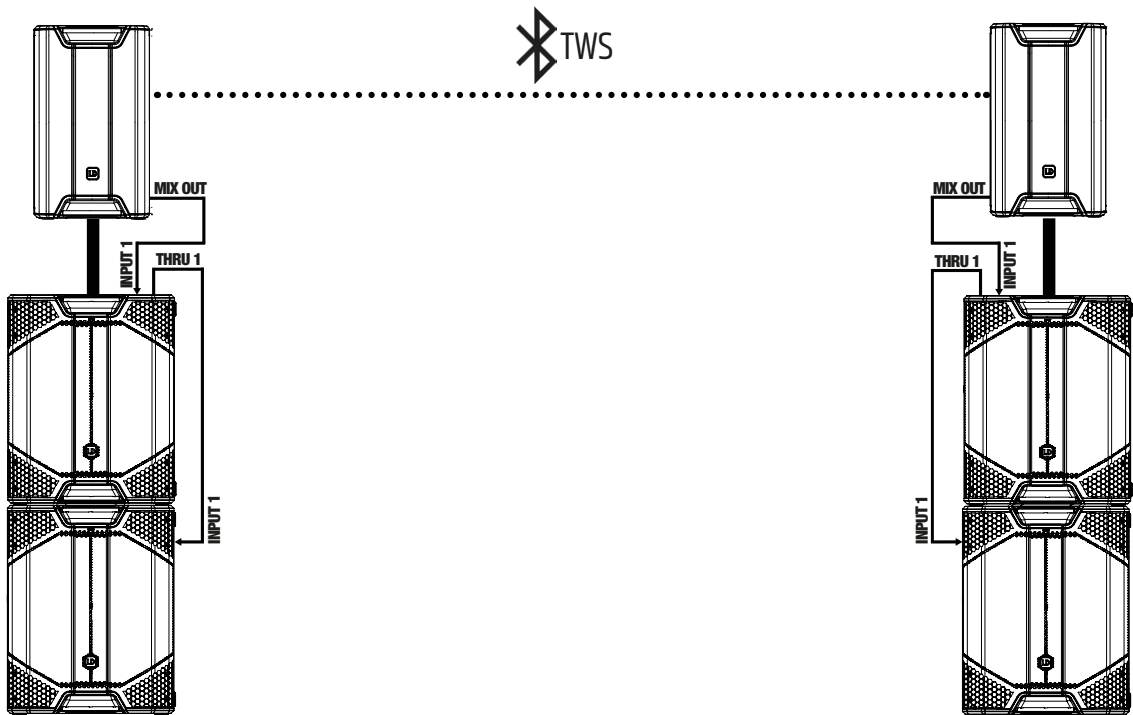
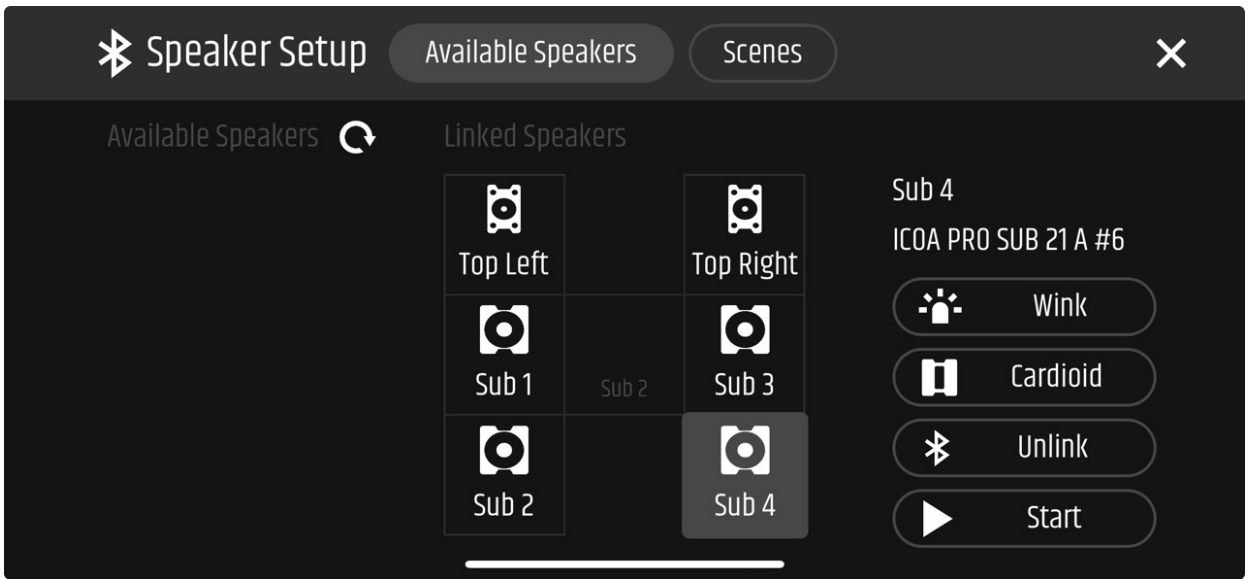

8.10.5 STEREO WITH 2 TOPS AND 4 SUBS - NO TRUE WIRELESS STEREO (TWS)*

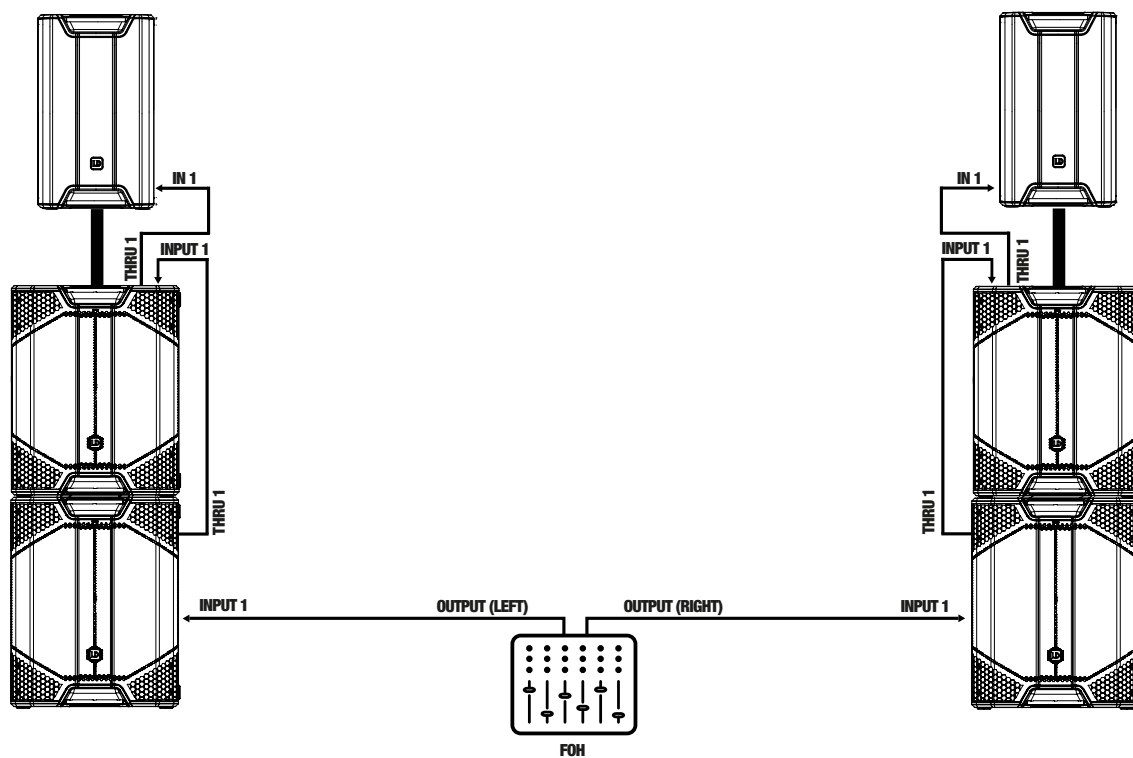
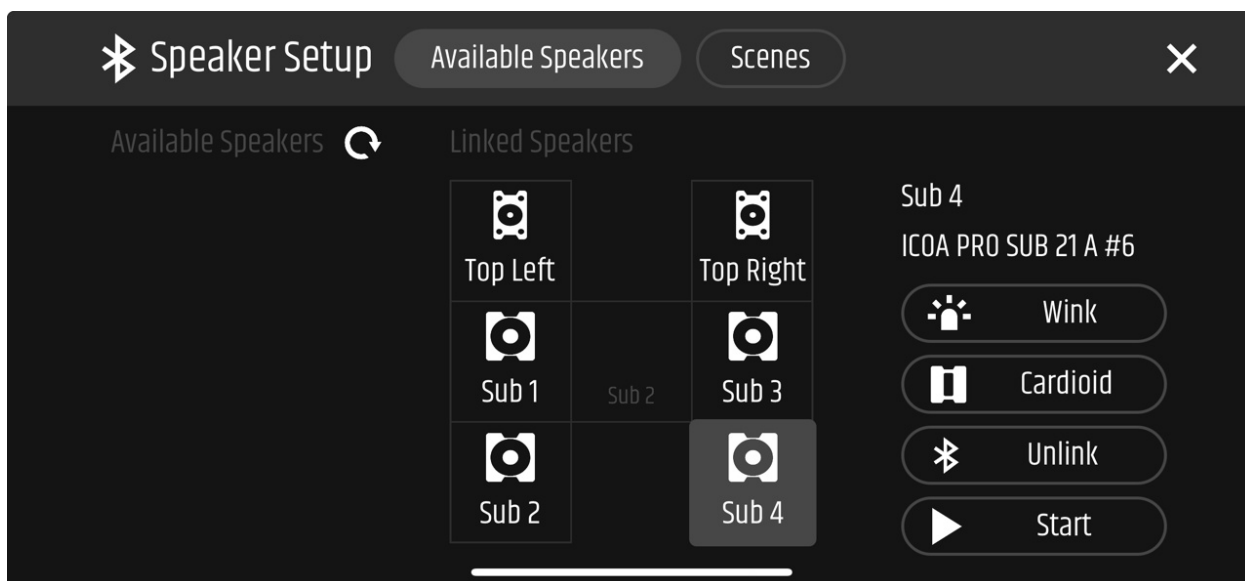

* This setup is not suitable for audio transmission via True Wireless Stereo (TWS).

8.10.6 STEREO WITH 2 TOPS AND MONO SUB

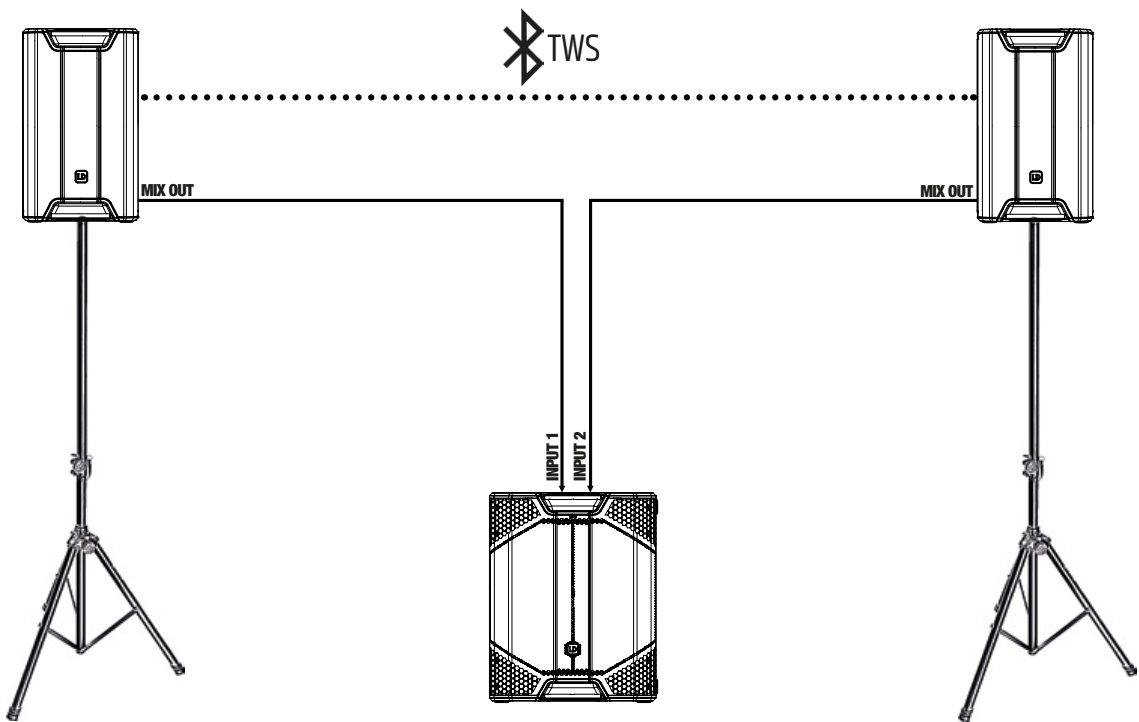
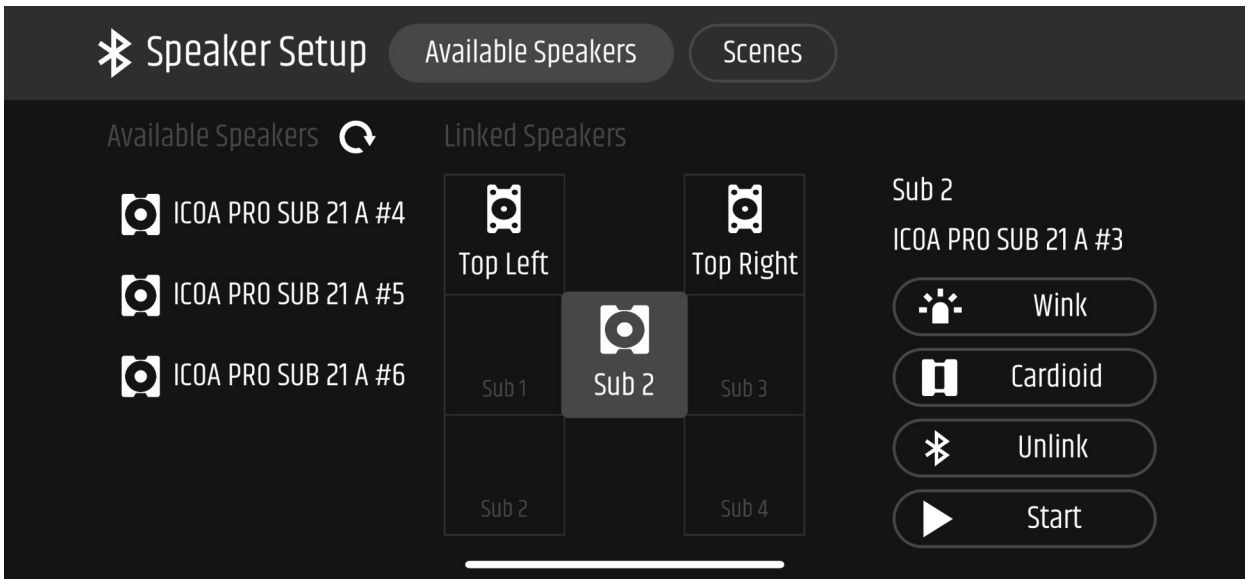

8.10.7 STEREO WITH 2 TOPS AND 3 SUBS CARDIOID

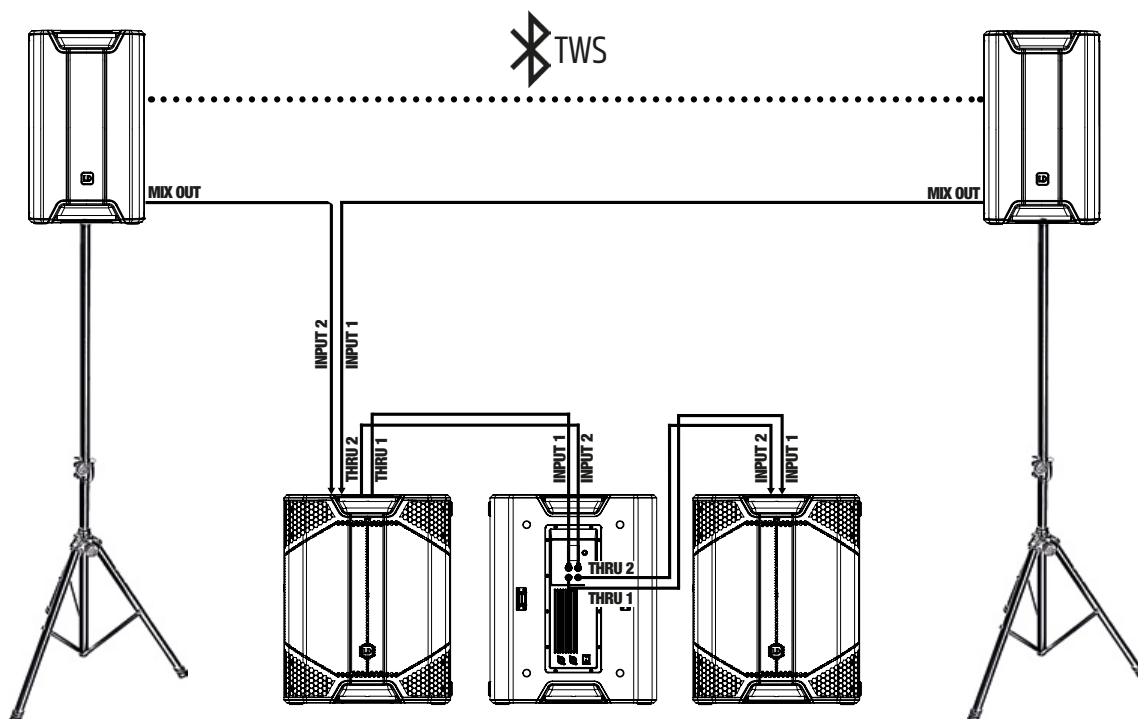
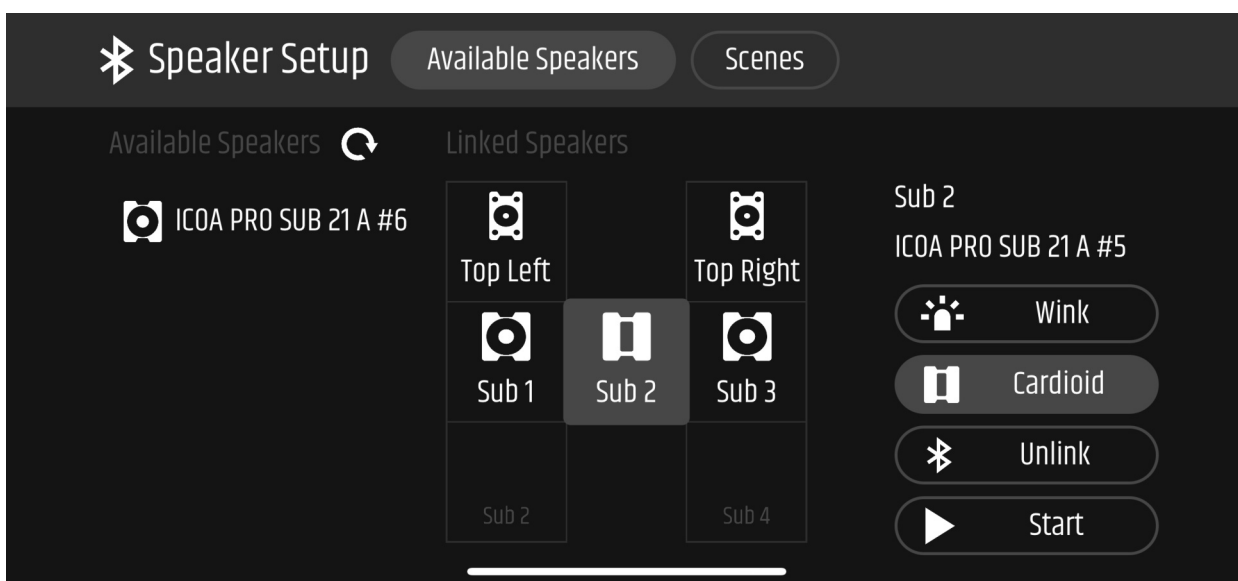

8.10.8 STEREO WITH 2 TOPS AND 4 SUBS (2 SUBS CARDIOID)

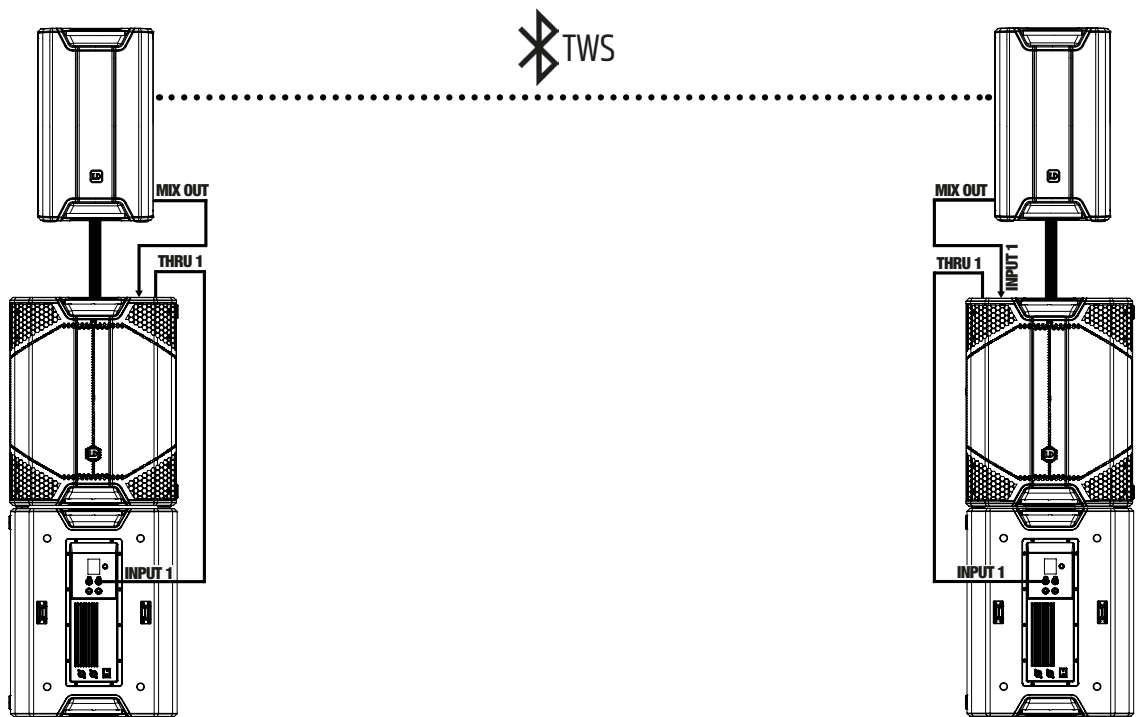
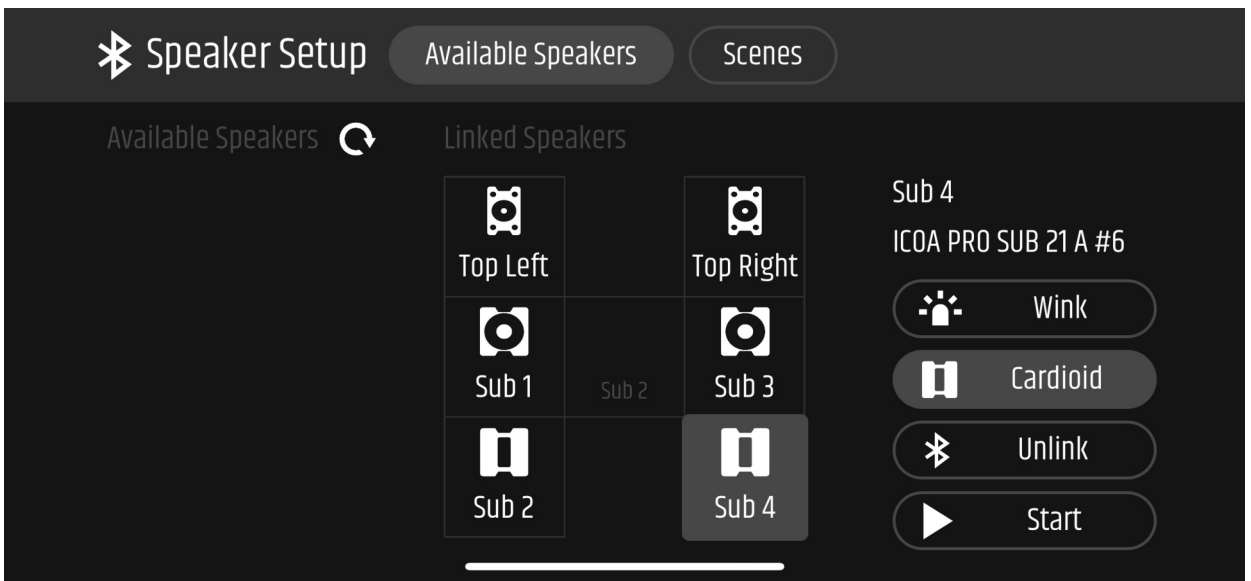

8.11 SCENES

8.11.1 OPENING THE SCENES SECTION

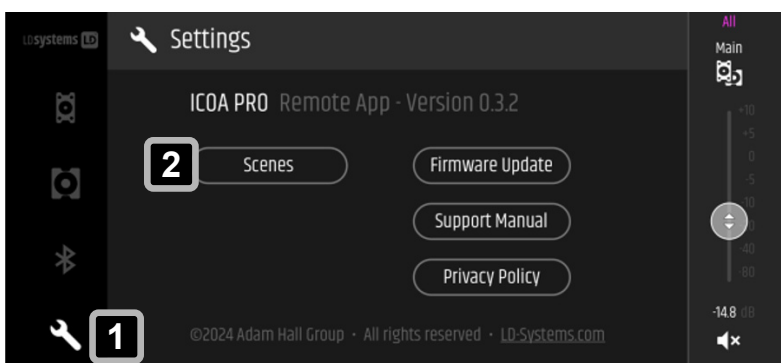

- 1 In the **Settings** section **1**, tap on **Scenes** **2**.

8.11.2 ACTIVATING SCENES

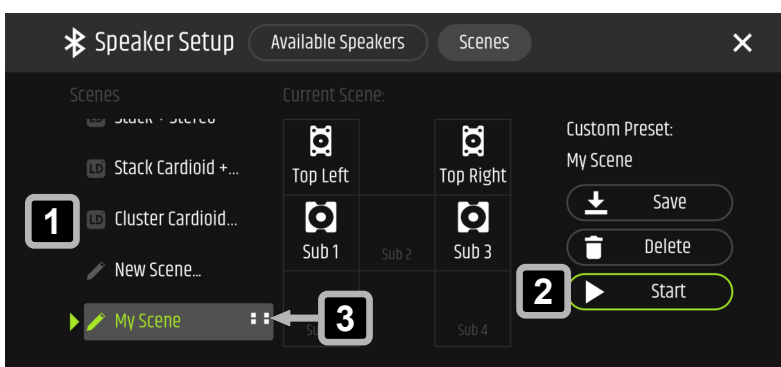

- 1 Tap on a scene from the **Scenes** area. **1**
- 2 Tap on **Start** **2** to activate the scene.



The white squares **3** to the right of the scene name **3** show the loudspeaker grid configuration for which the respective scene contains settings.

8.11.3 SAVING CUSTOM SCENES

Use custom scenes to save loudspeaker configurations with all associated settings, such as volume levels or EQ settings.

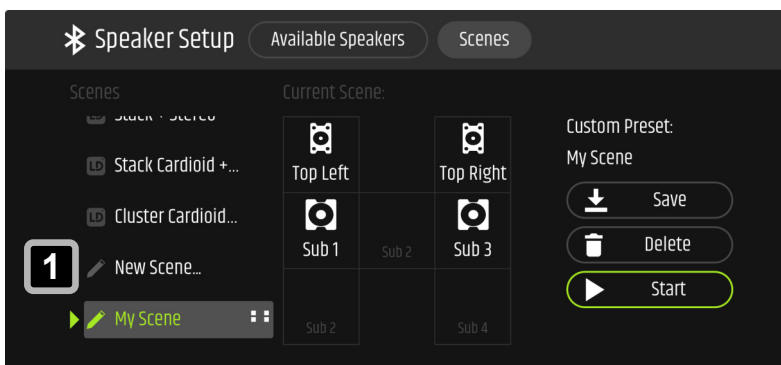

- 1 At the bottom of the **Scenes** list, tap on **New Scene...** **1**

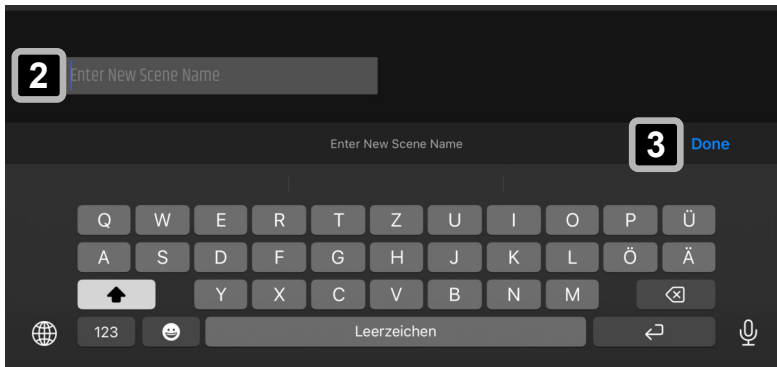

- 2 Enter a name for the new scene. **2**
- 3 Confirm your entry. **3**
⇒ The custom scene appears in the **Scenes** list.

9 MAINTENANCE

9.1 TROUBLESHOOTING

Problem	Cause	Solution
Bluetooth® connection interrupted or disturbed	Distance between device and ICOA® PRO too great	Reduce distance between device and ICOA® PRO
	Pairing issues	<ul style="list-style-type: none"> • Switch Bluetooth® off and on again on mobile device • Reboot mobile device and the ICOA® PRO
ICOA® PRO app connection not working	Distance between device and ICOA® PRO too great	Reduce distance between device and ICOA® PRO
Input signal distorted	Defective device or microphone connected to the input	Test with another device or microphone whether the problem persists.
	Cable defective	Test with another cable whether the problem persists.
Main limiter is active (Front LED illuminated red)	Main volume is too loud	Reduce the volume of the input channels and / or the main channels.

9.2 RESETTING THE DEVICE TO FACTORY SETTINGS



NOTICE

Loss of data

With the reset you will lose all your settings.

- a. Only perform the reset if you are aware of the data loss.

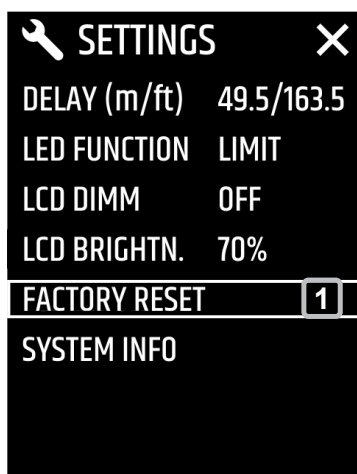

✓ You want to reset the device and are aware of the data loss.

- 1 Open the **SETTINGS** section on the **ICOA® PRO**.
- 2 Turn the **rotary-push encoder (RPE)** until **FACTORY RESET** **1** is highlighted.
- 3 Push the **RPE**.

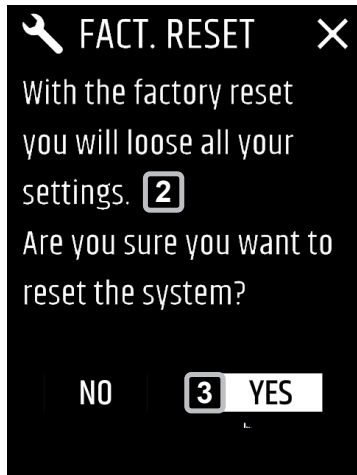

⇒ The **FACT. RESET** screen appears.

⇒ A warning message appears. **[2]**

4 Turn the **RPE** until **YES [3]** is highlighted.

5 Push the **RPE** to proceed with the factory reset.

⇒ The factory reset is executed.

⇒ The main screen appears.

See also:

Accessing the Settings Section [▶ 32]

9.3

CLEANING THE DEVICE



CAUTION

Mains Voltage

Risk of electric shock

- a. Before you perform maintenance work on the device, disconnect the device from all poles.



NOTICE

Damage to the device and void of warranty

- a. Perform maintenance on the device on a regular basis.
- b. Do not use cleaning agents, disinfectants, alcohol, or agents with abrasive effect for cleaning.

Carry out the maintenance measures listed below every 500 hours of operation. In case of less intensive use, perform maintenance work after 1 year at the latest.

- Clean the housing surface with a clean and damp cotton cloth. Wipe off all excess moisture to prevent damage to the internals.
- Clean any air inlets and outlets of dust and dirt. If you use compressed air, make sure that all fans are blocked to prevent damage to the internals.
- Clean all plug contacts from dust and dirt with a dry cotton cloth.

9.4

STORING THE DEVICE

Store the device only in a dry and clean environment. If you are storing the individual components of the device, use special protective covers, bags, and cases. Find such accessories for your product in the Adam Hall Shop (<https://www.adamhall.com/shop>).

10 REPAIR



CAUTION

Do not repair the device.

- a. Repairs may only be carried out by specialist personnel authorised by the manufacturer.
 - b. If your device is damaged or requires service, contact the Adam Hall Customer Service.
-

See also:
Contacts [▶ 9]

11 DISPOSAL

11.1

PACKAGING DISPOSAL



1. You can feed the packaging into the reusable material cycle using the usual disposal methods.
2. Separate the packaging in accordance with the applicable disposal laws and recycling regulations in your country

11.2

DEVICE DISPOSAL



1. This device is subject to the European Directive on Waste Electrical and Electronic Equipment, as amended. WEEE Directive Waste Electrical and Electronic Equipment. Old appliances do not belong in the household waste. The old device must be disposed of via an approved disposal company or a municipal disposal facility. Observe the applicable regulations in your country.
2. Observe all disposal laws applicable in your country.
3. As a private customer, you can obtain information on environmentally friendly disposal options from the seller of the product or the appropriate regional authorities.

INDEX

A

Accessories	18
App	37
Attaching	
EasyMount® bracket	28
Eyebolt	26
Universal mounting bracket	26

B

Bluetooth®	52
Pairing	61, 63
Unpairing	62, 64
Brightness (LCD)	36, 45

C

Cleaning	84
Connecting	
Input	60
Output	73
Power supply	29
Subwoofer	73
Customer Service	9

D

Delay	36, 45
Dimensions	19
Dimming display	36, 45
Disconnecting power supply	30
Download	9
Drum fill	66

E

EasyMount® bracket	28
EQ preset	35
Equaliser	34, 43, 51
Eyebolt	26

F

Factory reset	83
Firmware	37
Flange	25
Floor monitor	66
Follower (TWS)	53
Front grille	
Attaching	70
Removing	68
Front LED	23, 36, 45

H

Horizontal use	25, 66
----------------	--------

I

Input channel	64
Input connections	60
Installation	25, 26, 28

L

LCD	
Brightness	36
Display	36
LCD brightness	45
LCD display	45
LED	23, 36, 45
Linking	52

M

Main (TWS)	52
Main channel	65
Main coupling	58
Mains power cable	29, 30
Mobile app	37
Monitor mode	66
Mounting	

Flange	25
Speaker pole	25
Stand	25

N

Navigating	31
------------	----

O

Optional accessories	18
Output channel	65
Output connections	73
Overview	
App screen	38, 39, 40, 41, 42, 43, 44, 45, 46, 47, 48, 49
Device screen	33, 34, 35, 36
Product	18

P

Pairing a mobile device	61, 63
Power supply	29, 30
powerCON®	29, 30

R

Rotary-push encoder	31
Rotating the horn	68
Rotating the LD logo	70

S

Scenes	81
Scope of delivery	24
Settings	32, 36, 45, 49
Side fill	66
Signal delay	36, 45
Speaker pole	25
Speaker preset	35, 71
Speaker setup	49
Stand	25
Storing	84
Swapping left and right	55, 57

T

Technical data	19, 20, 21
Toggle mono / stereo	55, 58
Troubleshooting	83
True Wireless Stereo (TWS)	52
Linking	52, 56
Main coupling	58
Swapping left and right	55, 57
Toggle mono / stereo	55, 58
Unlinking	54, 56
Turning on / off	30

U

Universal mounting bracket	26
Unlinking	54, 56
Unpairing a mobile device	62, 64
Updating firmware	37
Use cases	66, 74
User interface	22

V

Volume	
Input channel	64
Output channel	65

